



June 2, 2026

To: Donnie Stevanus Metro Water Services

**Re: 101 Eastmoreland Street SW Improvements
Planning Commission Mandatory Referral 2026M-043ES-001
Council District # 05 Sean Parker, Council Member**

On behalf of the Metropolitan Planning Commission, the following item, referred to the Commission as required by the Metro Charter, has been recommended for *approval* to the Metropolitan Council:

A request for permanent and temporary easements are needed to construct Project 26-SWC-174, 101 Eastmoreland Street Public Utility Drainage Easement. These easements are to be acquired through negotiations, condemnation, and acceptance in order to complete this project.

The relevant Metro agencies (Metro Parks, Nashville Department of Transportation, Metro Water Services, Metro Emergency Communications, the Nashville Electric Service, General Services-Public Property and the Metro Historical Commission) have reviewed the proposal and concur in the recommendation for approval. This request must be approved by the Metro Council to become effective. A sketch showing the location of the request is attached to this letter.

Conditions that apply to this approval: none

This recommendation for approval is given as set forth in the Metropolitan Planning Commission Rules and Procedures. If you have any questions about this matter, please contact Delilah Rhodes at Delilah.Rhodes@nashville.gov or 615-862-7208

Sincerely,

A handwritten signature in blue ink that reads "Robert Leeman". The signature is fluid and cursive, written in a professional style.

Robert Leeman, AICP
Assistant Director Land Development
Metro Planning Department
cc: *Metro Clerk*

**Re: 101 Eastmoreland Street SW Improvements
 Planning Commission Mandatory Referral 2026M-043ES-001
 Council District # 05 Sean Parker, Council Member**

A request for permanent and temporary easements are needed to construct Project 26-SWC-174, 101 Eastmoreland Street Public Utility Drainage Easement. These easements are to be acquired through negotiations, condemnation, and acceptance in order to complete this project.

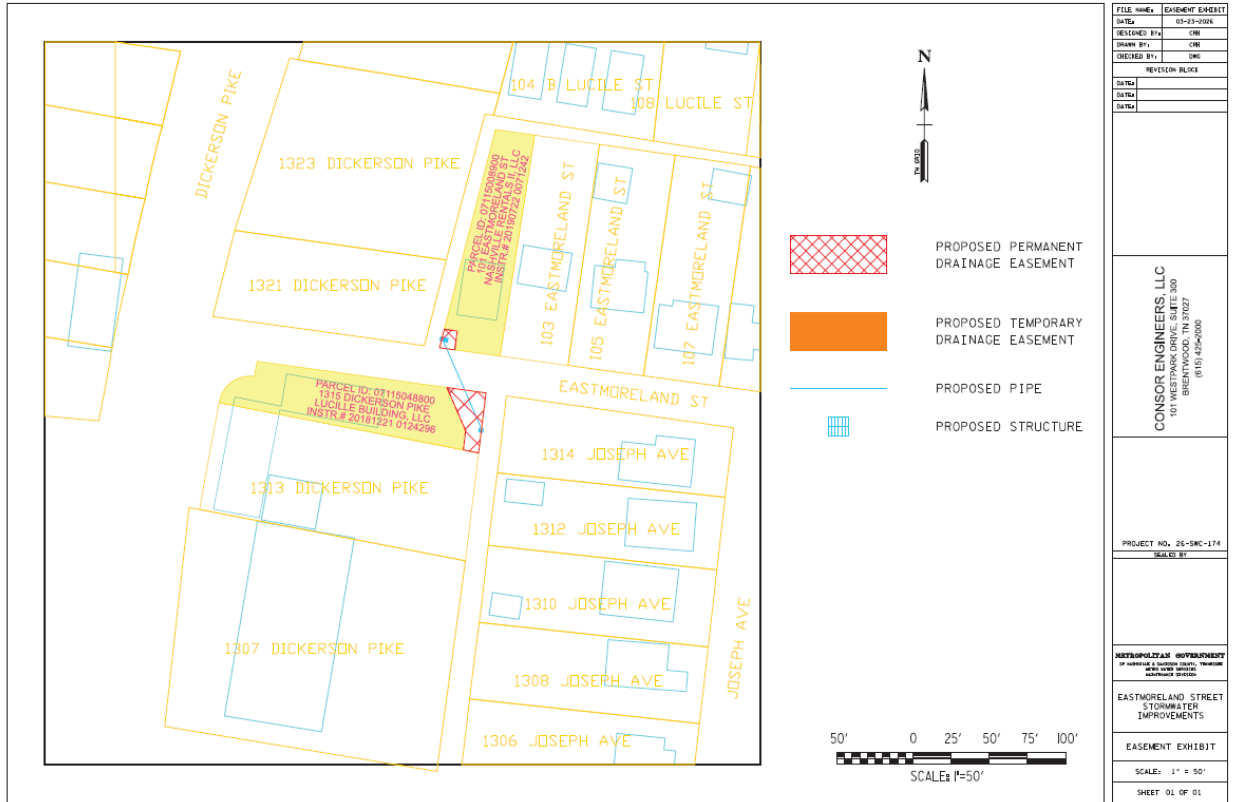

FILE NAME	EASEMENT SHEET
DATE	03-23-2024
DESIGNED BY	CRH
DRAWN BY	CRH
CHECKED BY	DWG
REVISION BLOCK	
DATE	
DATE	
CONSOR ENGINEERS, LLC 101 WESTPARK DRIVE, SUITE 500 BRENTWOOD, TN 37027 (615) 834-0000	
PROJECT NO. 26-SWC-174	
SCALE: 1"	
<small>REGISTERED PROFESSIONAL ENGINEER IN MECHANICAL & CIVIL ENGINEERING, TENNESSEE NO. 0000000000</small>	
EASTMORELAND STREET STORMWATER IMPROVEMENTS	
EASEMENT EXHIBIT	
SCALE: 1" = 50'	
SHEET 01 OF 01	