

Southpoint Phase 3A and Village UMC  
 Project Nos: 20SL0193 and 20WL0055

- Proposed 8-Inch Sanitary Sewer (PVC)... 329 LF
- Proposed Sanitary Sewer Manholes... 3 Units
- Proposed 8-Inch Water Main (DIP)... 362 LF
- Proposed Fire Hydrant Assemblies... 2 Units  
 (and easements)

October 12, 2020 Council District 31 Tax Map: 181 and 186 Parcel: 83 and 04

ENGINEER: CSDG  
 (Kevin Gangaware, P.E.)

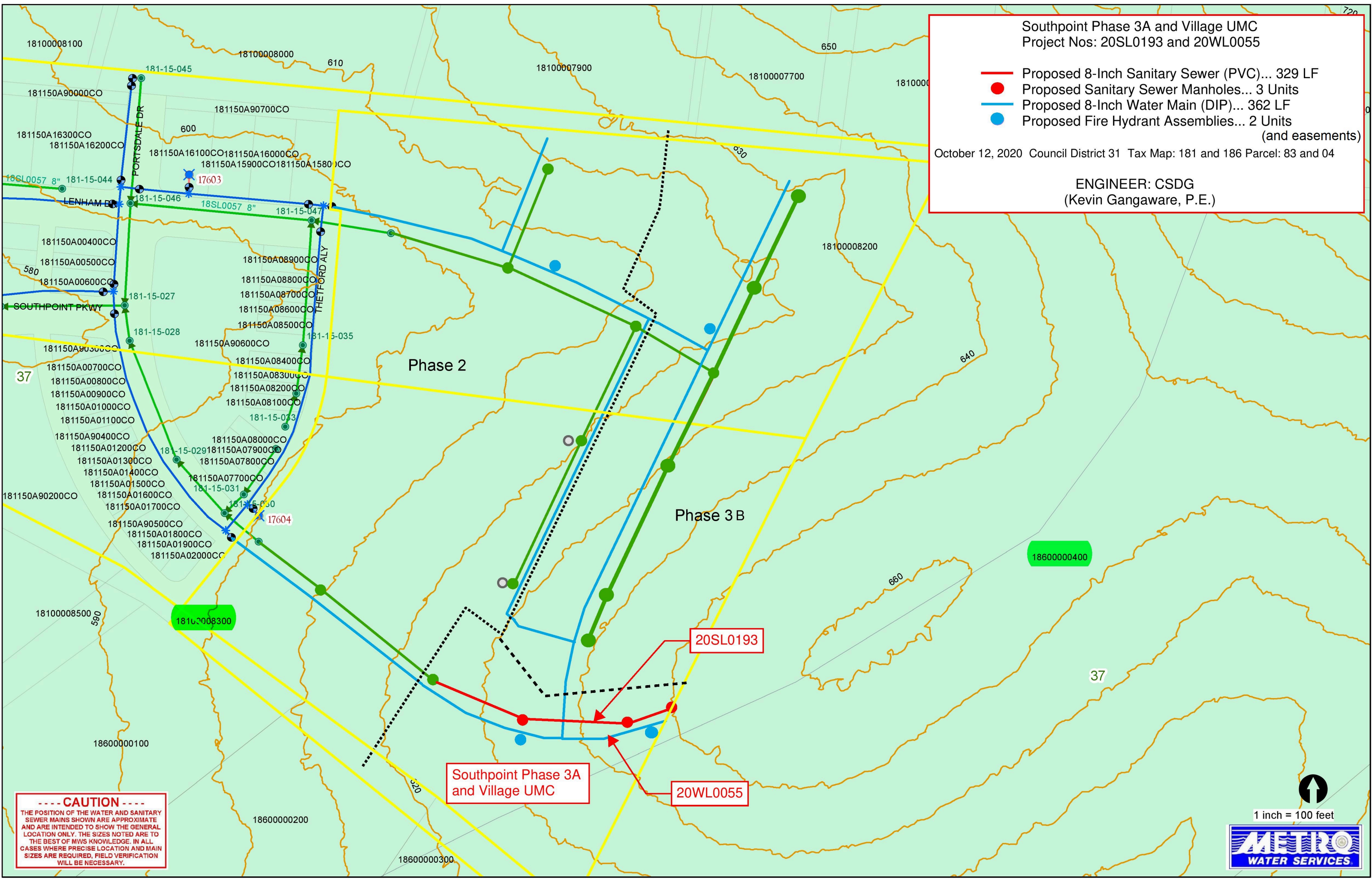

**CAUTION**  
 THE POSITION OF THE WATER AND SANITARY SEWER MAINS SHOWN ARE APPROXIMATE AND ARE INTENDED TO SHOW THE GENERAL LOCATION ONLY. THE SIZES NOTED ARE TO THE BEST OF MWS KNOWLEDGE. IN ALL CASES WHERE PRECISE LOCATION AND MAIN SIZES ARE REQUIRED, FIELD VERIFICATION WILL BE NECESSARY.

Southpoint Phase 3A and Village UMC

20WL0055

20SL0193

1 inch = 100 feet