



January 25, 2024

To: Mike Atchison Metro Water Services

Re: **2221 Elliston Place**  
**Planning Commission Mandatory Referral 2024M-011ES-001**  
**Council District #19 Jacob Kupin, Council Member**

On behalf of the Metropolitan Planning Commission, the following item, referred to the Commission as required by the Metro Charter, has been recommended for *approval* to the Metropolitan Council:

*A request for the acceptance of approximately 131 linear feet of eight-inch sanitary sewer mains (PVC), approximately 199 linear feet of 12- inch sanitary sewer mains (PVC), and six sanitary sewer manholes to serve the development at 2221 Elliston Place.*

The relevant Metro agencies (Metro Parks, Metro Public Works, Metro Water Services, Metro Emergency Communications, the Nashville Electric Service, Metro Finance – Public Property and the Metro Historical Commission) have reviewed the proposal and concur in the recommendation for approval. This request must be approved by the Metro Council to become effective. A sketch showing the location of the request is attached to this letter.

**Conditions that apply to this approval: none**

This recommendation for approval is given as set forth in the Metropolitan Planning Commission Rules and Procedures. If you have any questions about this matter, please contact Delilah Rhodes at [Delilah.Rhodes@nashville.gov](mailto:Delilah.Rhodes@nashville.gov) or 615-862-7208

Sincerely,

A handwritten signature in blue ink that reads "Lisa Milligan". The signature is fluid and cursive.

Lisa Milligan  
Assistant Director Land Development  
Metro Planning Department  
cc: *Metro Clerk*

**Re: 2221 Elliston Place  
Planning Commission Mandatory Referral 2024M-011ES-001  
Council District #19 Jacob Kupin, Council Member**

*A request for the acceptance of approximately 131 linear feet of eight-inch sanitary sewer mains (PVC), approximately 199 linear feet of 12- inch sanitary sewer mains (PVC), and six sanitary sewer manholes to serve the development at 2221 Elliston Place.*

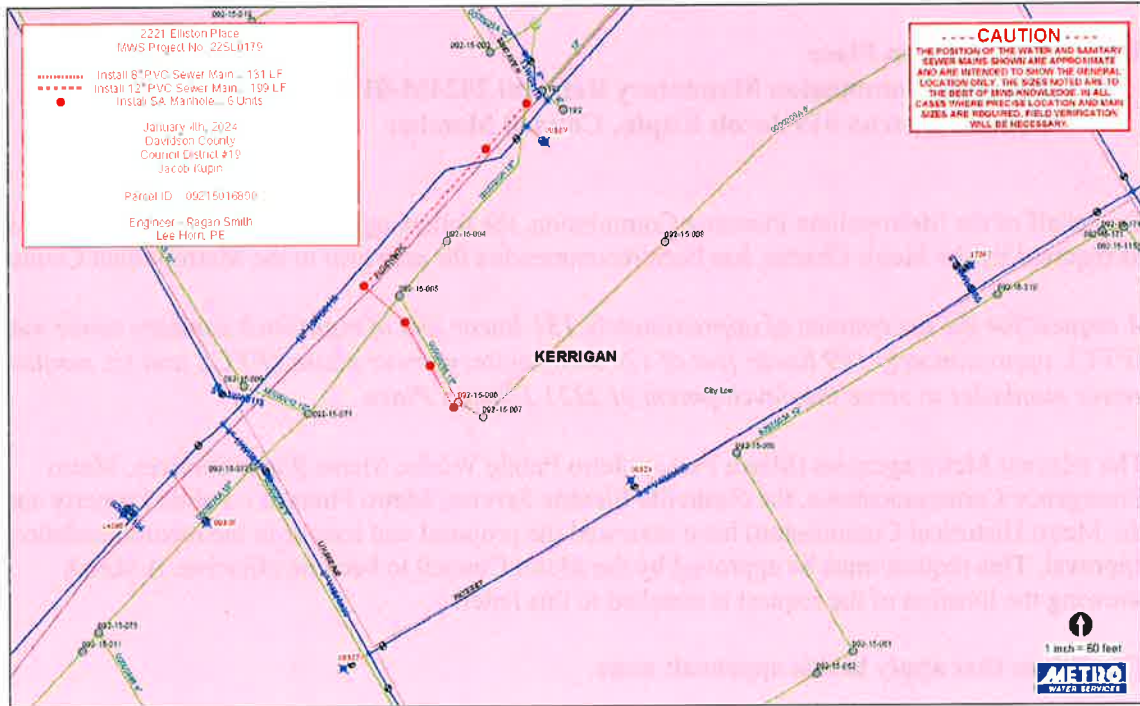

2221 Elliston Place  
 MWS Project No: 22SL0179

Install 8" PVC Sewer Main... 131 LF  
 Install 12" PVC Sewer Main... 199 LF  
 Install SA Manhole... 6 Units

January 4th, 2024  
 Davidson County  
 Council District #19  
 Jacob Kupin

Parcel ID... 09215016800

Engineer - Ragan Smith  
 Lee Horn, PE

**----- CAUTION -----**

THE POSITION OF THE WATER AND SANITARY SEWER MAINS SHOWN ARE APPROXIMATE AND ARE INTENDED TO SHOW THE GENERAL LOCATION ONLY. THE SIZES NOTED ARE TO THE BEST OF MWS KNOWLEDGE. IN ALL CASES WHERE PRECISE LOCATION AND MAIN SIZES ARE REQUIRED, FIELD VERIFICATION WILL BE NECESSARY.

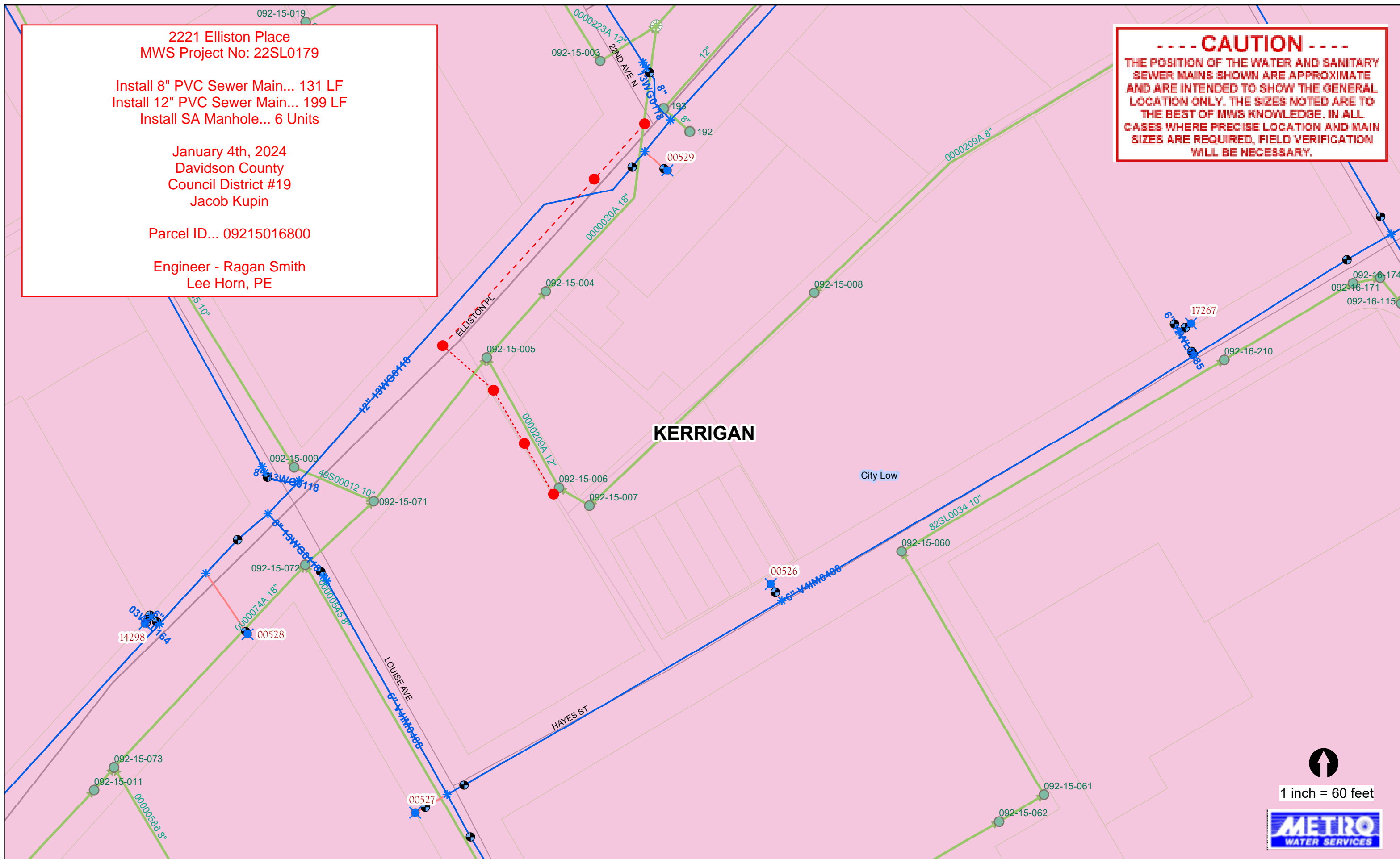

1 inch = 60 feet