



**METROPOLITAN GOVERNMENT OF NASHVILLE
AND DAVIDSON COUNTY**

Metro Office Building
800 President Ronald Reagan Way
P.O. Box 196300
Nashville, TN 37219-6300

September 6, 2023

To: Mike Atchison Metro Water Services

**Re: WOODBINE VILLAGE TOWNHOMES
Planning Commission Mandatory Referral 2023M-148ES-001
Council District #16 Ginny Welsch, Council Member**

On behalf of the Metropolitan Planning Commission, the following item, referred to the Commission as required by the Metro Charter, has been recommended for *approval* to the Metropolitan Council:

A request for the acceptance of one sanitary sewer manhole to serve the Woodbine Village Townhomes development.

The relevant Metro agencies (Metro Parks, Metro Public Works, Metro Water Services, Metro Emergency Communications, the Nashville Electric Service, Metro Finance – Public Property and the Metro Historical Commission) have reviewed the proposal and concur in the recommendation for approval. This request must be approved by the Metro Council to become effective. A sketch showing the location of the request is attached to this letter.

Conditions that apply to this approval: none

This recommendation for approval is given as set forth in the Metropolitan Planning Commission Rules and Procedures. If you have any questions about this matter, please contact Delilah Rhodes at delilah.rhodes@nashville.gov or 615-862-7208.

Sincerely,

A handwritten signature in blue ink, appearing to read 'Lisa Milligan'.

Lisa Milligan
Land Development Manager
Metro Planning Department
cc: *Metro Clerk*

Re: WOODBINE VILLAGE TOWNHOMES
Planning Commission Mandatory Referral #
2023M-148ES-001 Council District #16 Ginny Welsch, Council Member

A request for the acceptance of one sanitary sewer manhole to serve the Woodbine Village Townhomes development.



Re: WOODBINE VILLAGE TOWNHOMES
Planning Commission Mandatory Referral # 2023M-148ES-001
Council District #17 Colby Sledge, Council Member

A request for the acceptance of one sanitary sewer manhole to serve the Woodbine Village Townhomes development.

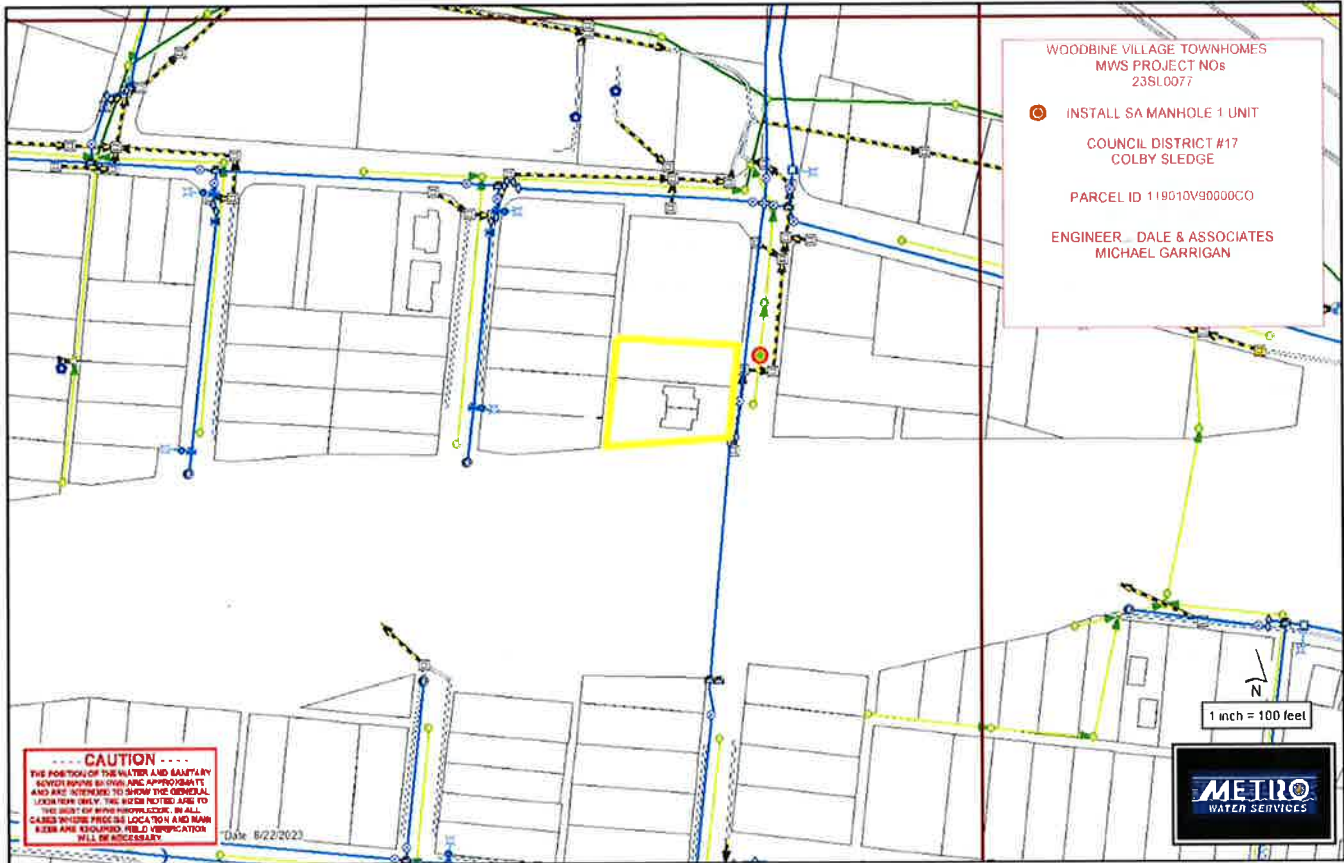

WOODBINE VILLAGE TOWNHOMES
MWS PROJECT NOs:
23SL0077

● INSTALL SA MANHOLE 1 UNIT

COUNCIL DISTRICT #17
COLBY SLEDGE

PARCEL ID 119010V90000CO

ENGINEER... DALE & ASSOCIATES
MICHAEL GARRIGAN

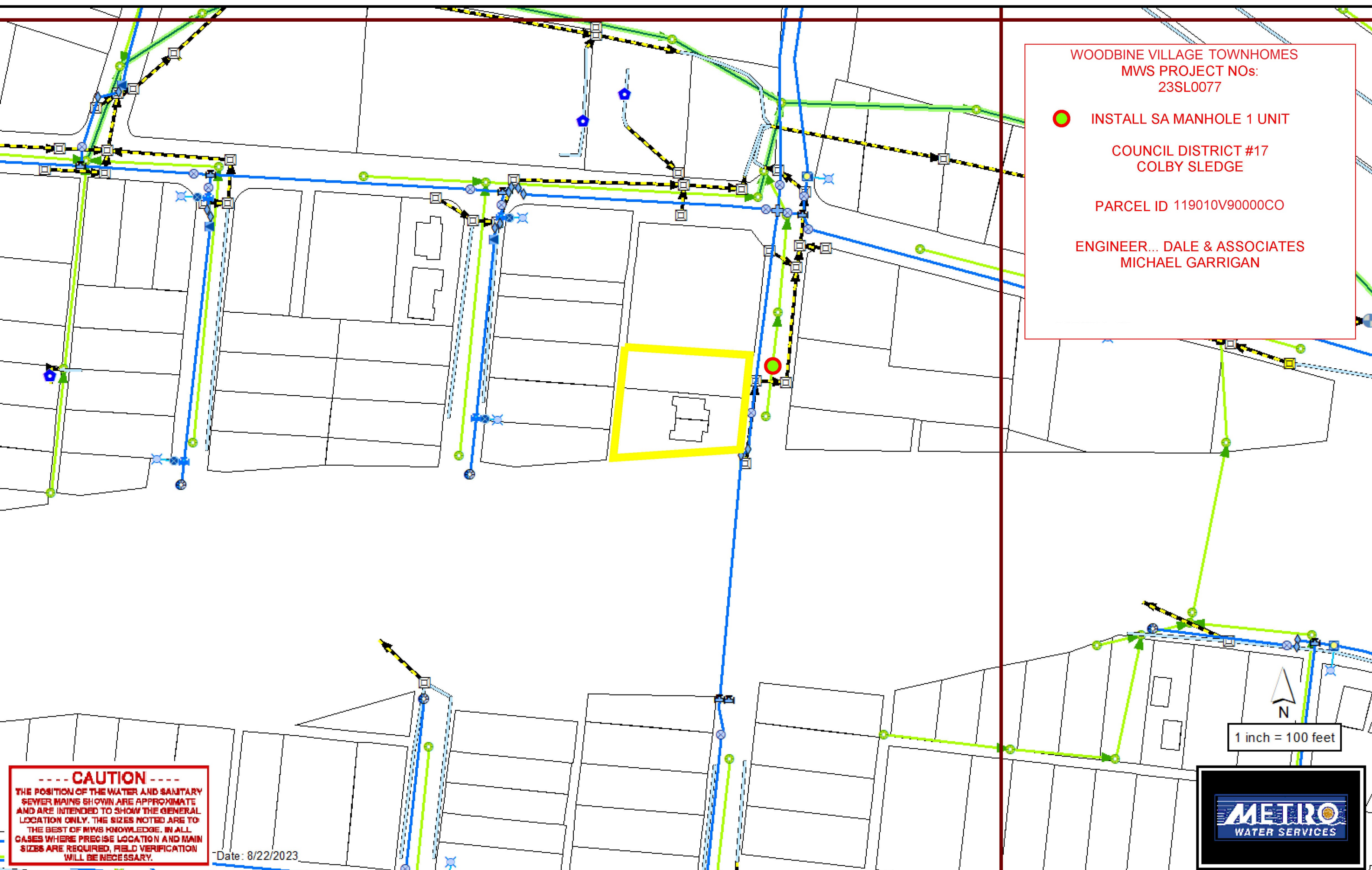

CAUTION
THE POSITION OF THE WATER AND SANITARY
SEWER MAINS SHOWN ARE APPROXIMATE
AND ARE INTENDED TO SHOW THE GENERAL
LOCATION ONLY. THE SIZES NOTED ARE TO
THE BEST OF MWS KNOWLEDGE. IN ALL
CASES WHERE PRECISE LOCATION AND MAIN
SIZES ARE REQUIRED, FIELD VERIFICATION
WILL BE NECESSARY.

Date: 8/22/2023

N
1 inch = 100 feet

