



**METROPOLITAN GOVERNMENT OF NASHVILLE
AND DAVIDSON COUNTY**

Metro Office Building
800 President Ronald Reagan Way
P.O. Box 196300
Nashville, TN 37219-6300

October 4, 2022

To: Stephanie James, Metro Water Services

**Re: 1007 THOMPSON PLACE
Planning Commission Mandatory Referral #2022M-146ES-001
Council District #13 Russ Bradford, Council Member**

On behalf of the Metropolitan Planning Commission, the following item, referred to the Commission as required by the Metro Charter, has been recommended for *approval* to the Metropolitan Council:

A request for the abandonment of 100 linear feet of six inch sanitary sewer service main and three sanitary sewer manholes and the acceptance of approximately 100 linear feet of eight inch sanitary sewer main (PVC), three sanitary sewer manholes, and associated easements to serve the development at 1007 Thompson Place.

The relevant Metro agencies (Metro Parks, Metro Public Works, Metro Water Services, Metro Emergency Communications, the Nashville Electric Service, Metro Finance – Public Property and the Metro Historical Commission) have reviewed the proposal and concur in the recommendation for approval. This request must be approved by the Metro Council to become effective. A sketch showing the location of the request is attached to this letter.

Conditions that apply to this approval: none

This recommendation for approval is given as set forth in the Metropolitan Planning Commission Rules and Procedures. If you have any questions about this matter, please contact Delilah Rhodes at delilah.rhodes@nashville.gov or 615-862-7208.

Sincerely,

A handwritten signature in blue ink, appearing to read "Lisa Milligan".

Lisa Milligan
Land Development Manager
Metro Planning Department
cc: Metro Clerk

Re: 1007 THOMPSON PLACE
Planning Commission Mandatory Referral #2022M-146ES-001
Council District #13 Russ Bradford, Council Member

A request for the abandonment of 100 linear feet of six inch sanitary sewer service main and three sanitary sewer manholes and the acceptance of approximately 100 linear feet of eight inch sanitary sewer main (PVC), three sanitary sewer manholes, and associated easements to serve the development at 1007 Thompson Place.

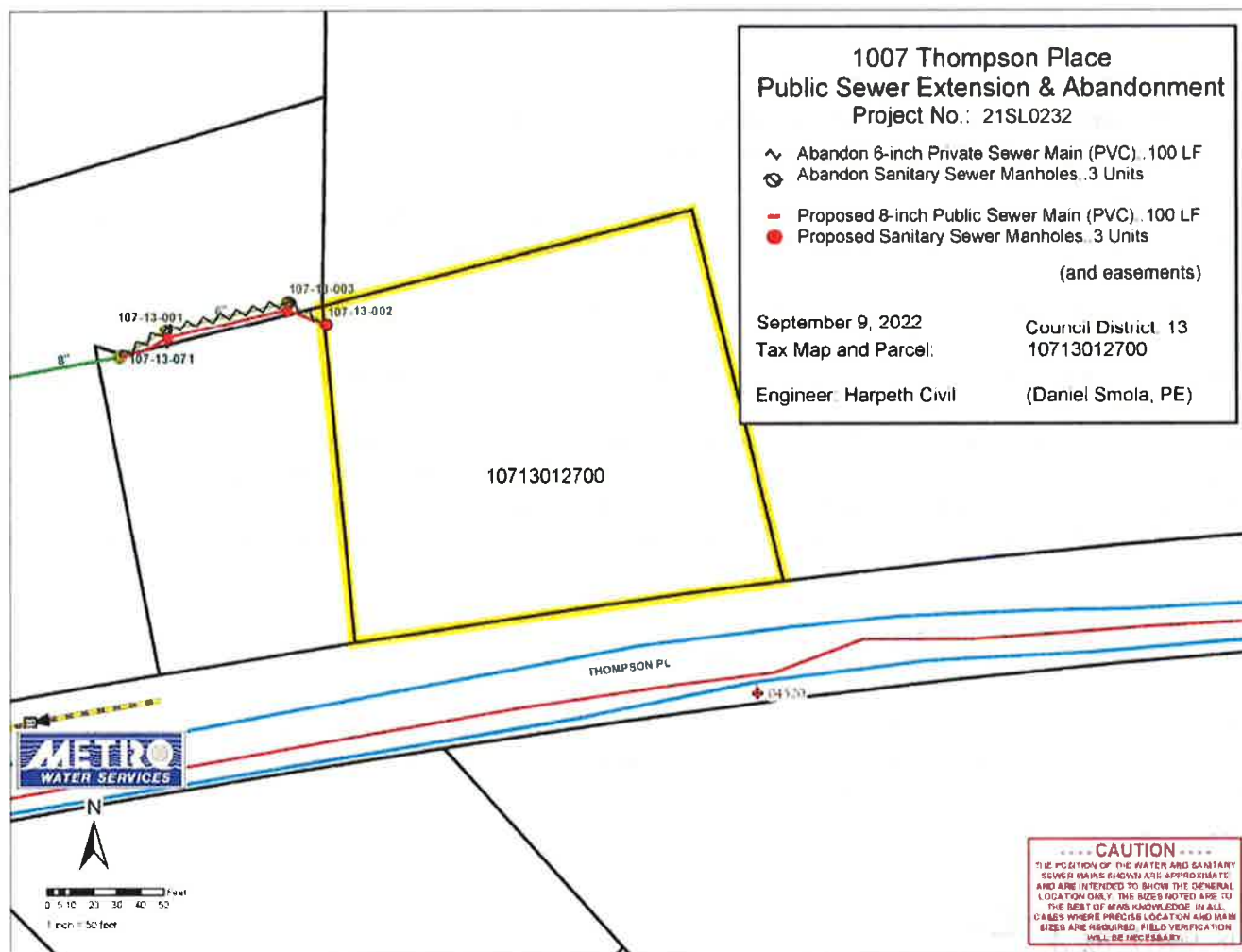

1007 Thompson Place Public Sewer Extension & Abandonment Project No.: 21SL0232

- ~ Abandon 6-inch Private Sewer Main (PVC)..100 LF
- ⊗ Abandon Sanitary Sewer Manholes..3 Units
- Proposed 8-inch Public Sewer Main (PVC)..100 LF
- Proposed Sanitary Sewer Manholes..3 Units

(and easements)

September 9, 2022

Council District: 13

Tax Map and Parcel:

10713012700

Engineer: Harpeth Civil

(Daniel Smola, PE)

