



**METROPOLITAN GOVERNMENT OF NASHVILLE
AND DAVIDSON COUNTY**

Metro Office Building
800 President Ronald Reagan Way
P.O. Box 196300
Nashville, TN 37219-6300

September 18, 2022

To: Mike Atchison, Metro Water Services

**Re: SKY HARBOUR HANGERS
Planning Commission Mandatory Referral #2022M-139ES-001
Council District #13 Russ Bradford, Council Member**

On behalf of the Metropolitan Planning Commission, the following item, referred to the Commission as required by the Metro Charter, has been recommended for *approval* to the Metropolitan Council:

A request for the abandonment of 14 linear feet of 12 inch water main and the acceptance of 14 linear feet of 12 inch water main (DIP) to serve the Sky Harbour Hangers development..

The relevant Metro agencies (Metro Parks, Metro Public Works, Metro Water Services, Metro Emergency Communications, the Nashville Electric Service, Metro Finance – Public Property and the Metro Historical Commission) have reviewed the proposal and concur in the recommendation for approval. This request must be approved by the Metro Council to become effective. A sketch showing the location of the request is attached to this letter.

Conditions that apply to this approval: none

This recommendation for approval is given as set forth in the Metropolitan Planning Commission Rules and Procedures. If you have any questions about this matter, please contact Delilah Rhodes at delilah.rhodes@nashville.gov or 615-862-7208.

Sincerely,

A handwritten signature in blue ink that reads "Lisa Milligan".

Lisa Milligan
Land Development Manager
Metro Planning Department
cc: Metro Clerk

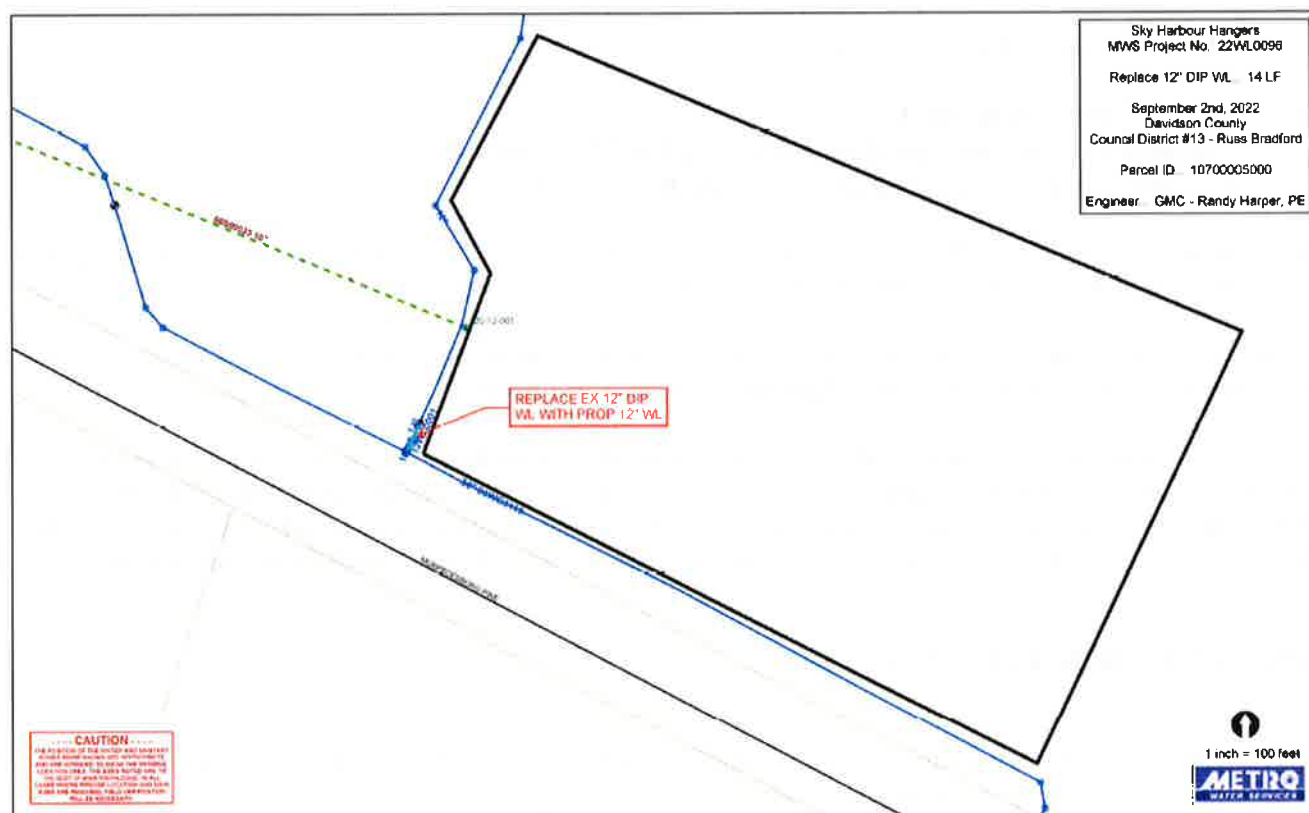

Sky Harbour Hangers
MWS Project No.: 22WL0096

Replace 12" DIP WL... 14 LF

September 2nd, 2022
Davidson County
Council District #13 - Russ Bradford

Parcel ID... 10700005000
Engineer... GMC - Randy Harper, PE

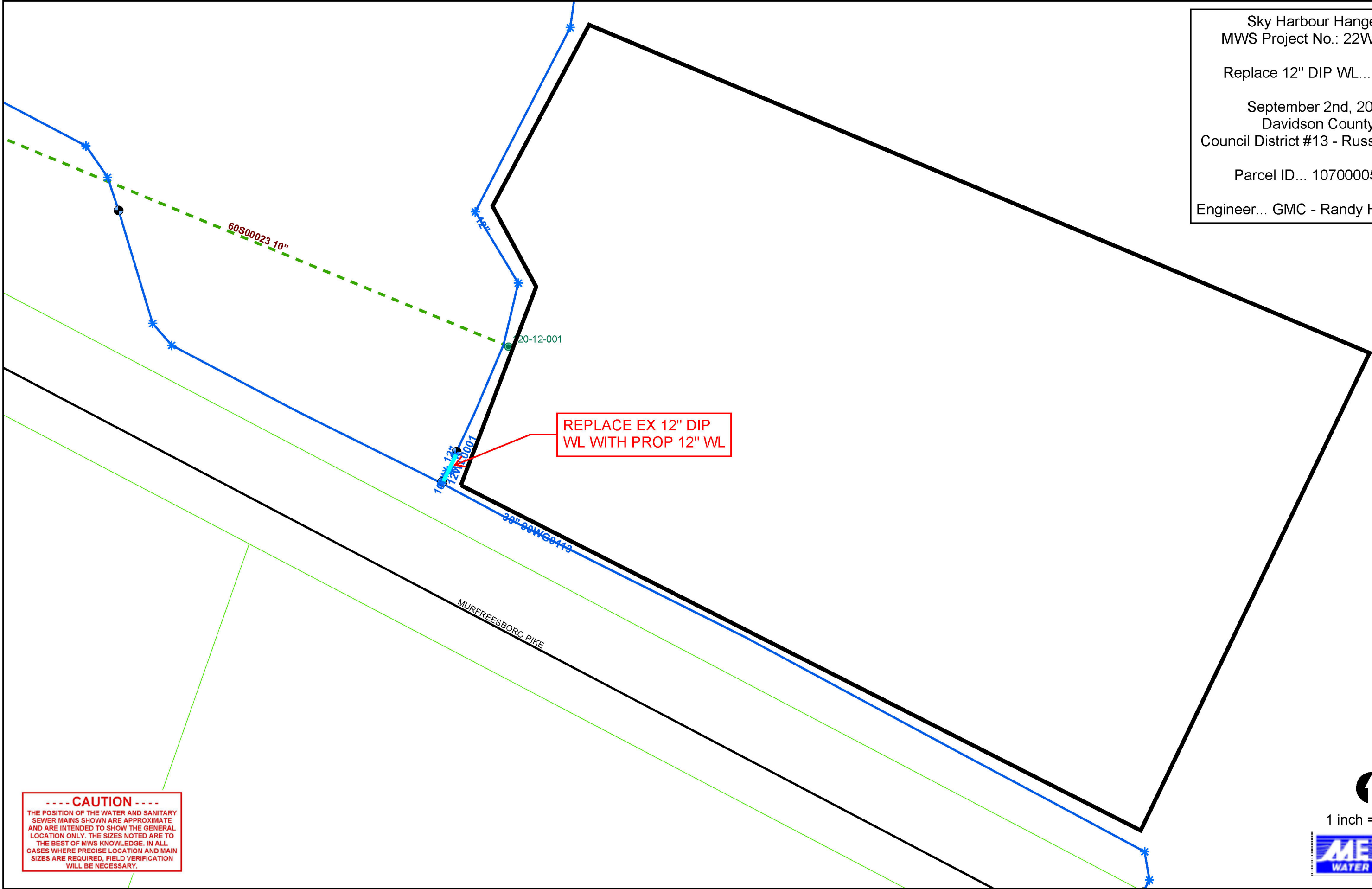

----- CAUTION -----
THE POSITION OF THE WATER AND SANITARY
SEWER MAINS SHOWN ARE APPROXIMATE
AND ARE INTENDED TO SHOW THE GENERAL
LOCATION ONLY. THE SIZES NOTED ARE TO
THE BEST OF MWS KNOWLEDGE. IN ALL
CASES WHERE PRECISE LOCATION AND MAIN
SIZES ARE REQUIRED, FIELD VERIFICATION
WILL BE NECESSARY.

