



**METROPOLITAN GOVERNMENT
OF NASHVILLE AND DAVIDSON COUNTY**

Planning Department
Metro Office Building
800 Second Avenue South
Nashville, Tennessee 37201

August 19, 2022

To: Mike Atchison, Metro Water Services

**Re: HAVEN AT CHARLOTTE
Planning Commission Mandatory Referral #2022M-118ES-001
Council District #21 Brandon Taylor, Council Member**

On behalf of the Metropolitan Planning Commission, the following item, referred to the Commission as required by the Metro Charter, has been recommended for *approval* to the Metropolitan Council:

A request for approval for the acceptance of approximately 178 linear feet of 8-inch sanitary sewer main (PVC), 133 linear feet of 8-inch sanitary sewer main (DIP), four sanitary sewer manholes, and easements to serve the Haven at Charlotte development.

The relevant Metro agencies (Metro Parks, Metro Public Works, Metro Water Services, Metro Emergency Communications, the Nashville Electric Service, Metro Finance – Public Property and the Metro Historical Commission) have reviewed the proposal and concur in the recommendation for approval. This request must be approved by the Metro Council to become effective. A sketch showing the location of the request is attached to this letter.

Conditions that apply to this approval: none

This recommendation for approval is given as set forth in the Metropolitan Planning Commission Rules and Procedures. If you have any questions about this matter, please contact Delilah Rhodes at delilah.rhodes@nashville.gov or 615-862-7208.

Sincerely,

A handwritten signature in blue ink that reads 'Lisa Milligan'.

Lisa Milligan
Land Development Manager
Metro Planning Department
cc: *Metro Clerk*

Re: HAVEN AT CHARLOTTE
Planning Commission Mandatory Referral #2022M-118ES-001
Council District #21 Brandon Taylor, Council Member

A request for approval for the acceptance of approximately 178 linear feet of 8-inch sanitary sewer main (PVC), 133 linear feet of 8-inch sanitary sewer main (DIP), four sanitary sewer manholes, and easements to serve the Haven at Charlotte development.

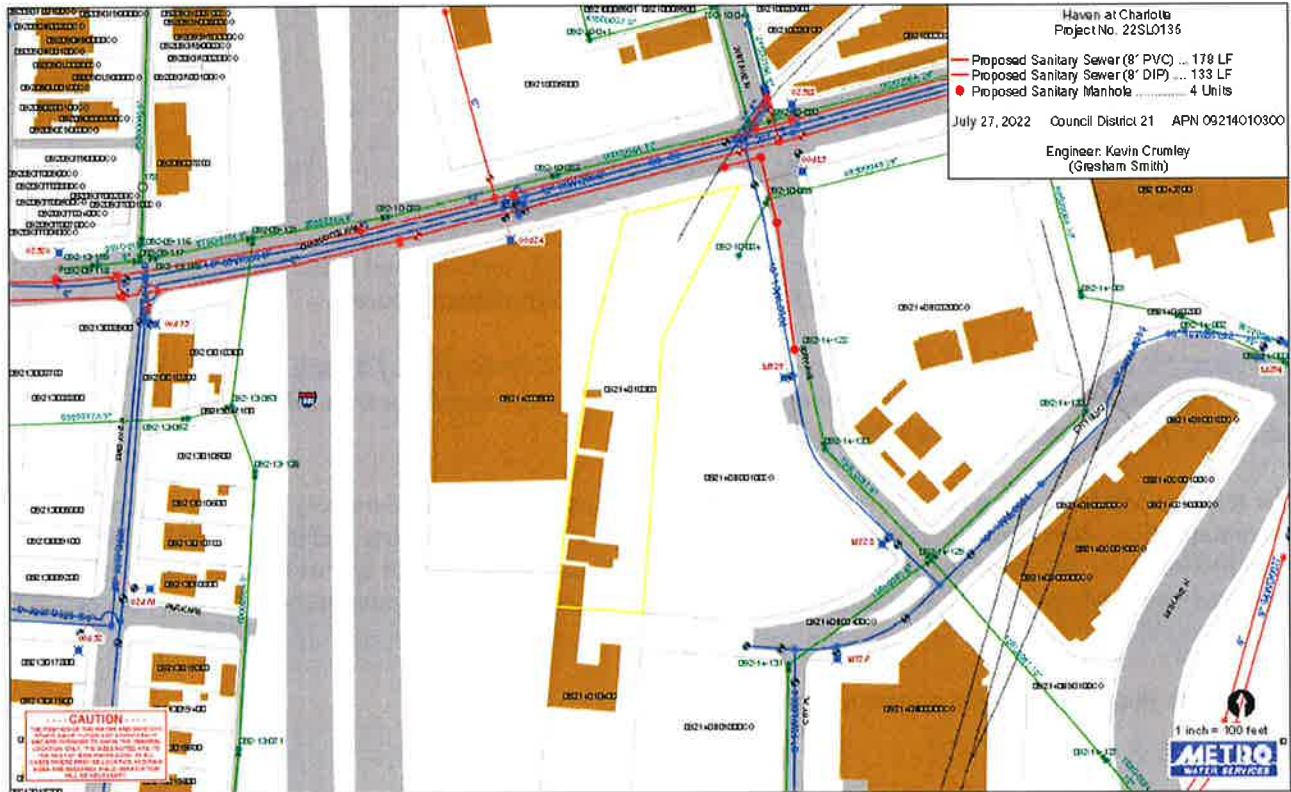

Haven at Charlotte Project No. 22SL0135

- Proposed Sanitary Sewer (8" PVC) ... 178 LF
- Proposed Sanitary Sewer (8" DIP) 133 LF
- Proposed Sanitary Manhole 4 Units

(and easements)

July 27, 2022 Council District 21 APN 09214010300

Engineer: Kevin Crumley
(Gresham Smith)

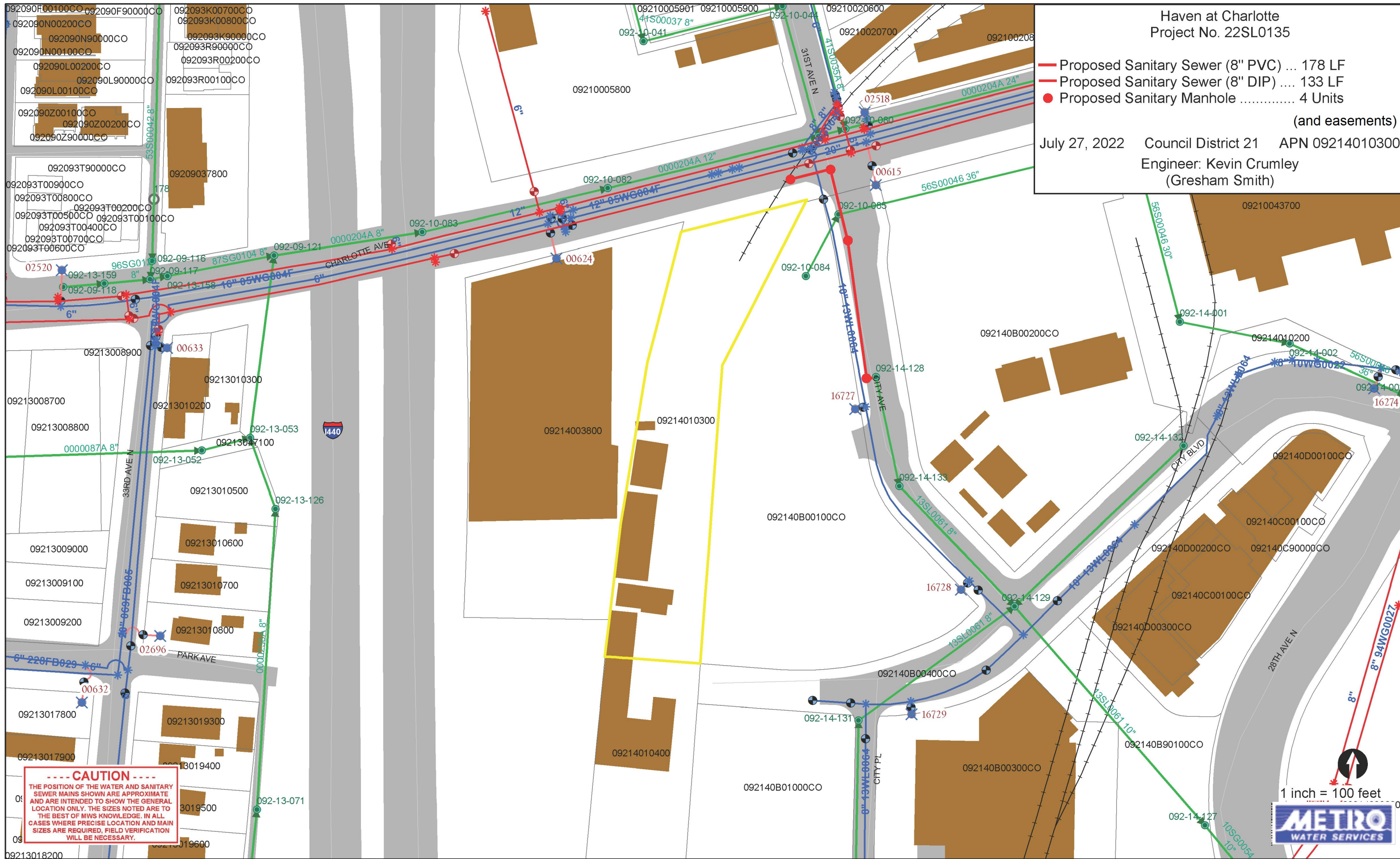

----- CAUTION -----
 THE POSITION OF THE WATER AND SANITARY SEWER MAINS SHOWN ARE APPROXIMATE AND ARE INTENDED TO SHOW THE GENERAL LOCATION ONLY. THE SIZES NOTED ARE TO THE BEST OF MWS KNOWLEDGE. IN ALL CASES WHERE PRECISE LOCATION AND MAIN SIZES ARE REQUIRED, FIELD VERIFICATION WILL BE NECESSARY.

1 inch = 100 feet