



**METROPOLITAN GOVERNMENT
OF NASHVILLE AND DAVIDSON COUNTY**

Planning Department
Metro Office Building
800 Second Avenue South
Nashville, Tennessee 37201

June 10, 2022

To: Mike Atchison, Public Metro Water

**Re: DRAKES BRANCH PHASE2
Planning Commission Mandatory Referral #2022M-081ES-001
Council District #01 Jonathan Hall, Council Member**

On behalf of the Metropolitan Planning Commission, the following item, referred to the Commission as required by the Metro Charter, has been recommended for *approval* to the Metropolitan Council:

A request for the acceptance of approximately 1,119 linear feet of 8-inch sanitary sewer main (DIP), 1,565 linear feet of 8-inch sanitary sewer main (PVC), 189 linear feet of 15-inch sanitary sewer main (PVC), 16 sanitary sewer manholes, 2,871 linear feet of 8-inch water main (DIP), eight fire hydrant assemblies and easements to serve the Drakes Branch Phase 2 development.

The relevant Metro agencies (Metro Parks, Metro Public Works, Metro Water Services, Metro Emergency Communications, the Nashville Electric Service, Metro Finance – Public Property and the Metro Historical Commission) have reviewed the proposal and concur in the recommendation for approval. This request must be approved by the Metro Council to become effective. A sketch showing the location of the request is attached to this letter.

Conditions that apply to this approval: none

This recommendation for approval is given as set forth in the Metropolitan Planning Commission Rules and Procedures. If you have any questions about this matter, please contact Delilah Rhodes at delilah.rhodes@nashville.gov or 615-862-7208.

Sincerely,

A handwritten signature in blue ink, appearing to read "Lisa Milligan".

Lisa Milligan
Land Development Manager
Metro Planning Department
cc: Metro Clerk

Re: DRAKES BRANCH PHASE2
Planning Commission Mandatory Referral #2022M-081ES-001
Council District #01 Jonathan Hall, Council Member

A request for the acceptance of approximately 1,119 linear feet of 8-inch sanitary sewer main (DIP), 1,565 linear feet of 8-inch sanitary sewer main (PVC), 189 linear feet of 15-inch sanitary sewer main (PVC), 16 sanitary sewer manholes, 2,871 linear feet of 8-inch water main (DIP), eight fire hydrant assemblies and easements to serve the Drakes Branch Phase 2 development.

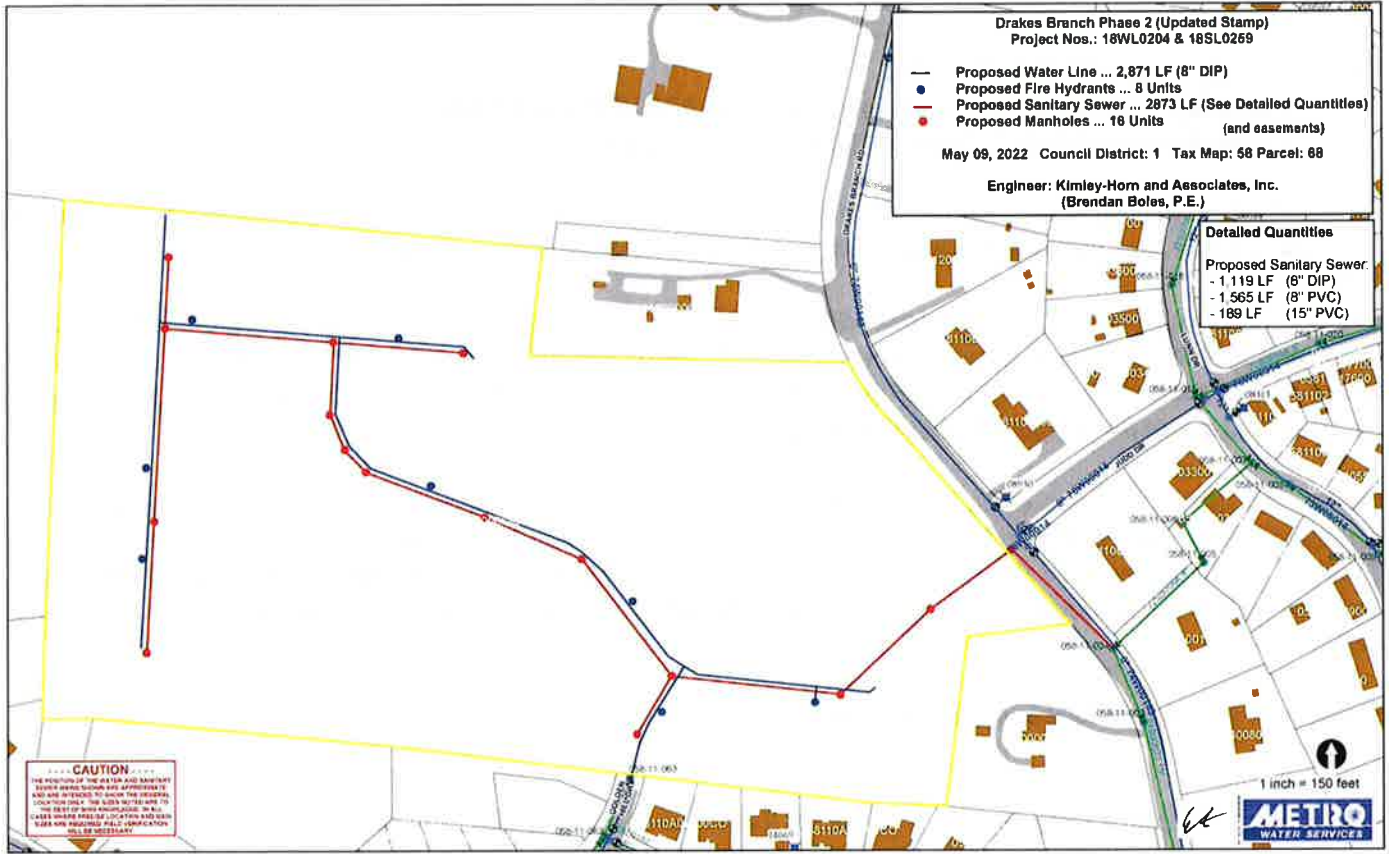

Drakes Branch Phase 2 (Updated Stamp)
Project Nos.: 18WL0204 & 18SL0259

- Proposed Water Line ... 2,871 LF (8" DIP)
- Proposed Fire Hydrants ... 8 Units
- Proposed Sanitary Sewer ... 2873 LF (See Detailed Quantities)
- Proposed Manholes ... 16 Units (and easements)

May 09, 2022 Council District: 1 Tax Map: 58 Parcel: 68

Engineer: Kimley-Horn and Associates, Inc.
 (Brendan Boles, P.E.)

Detailed Quantities

Proposed Sanitary Sewer:

- 1,119 LF (8" DIP)
- 1,565 LF (8" PVC)
- 189 LF (15" PVC)

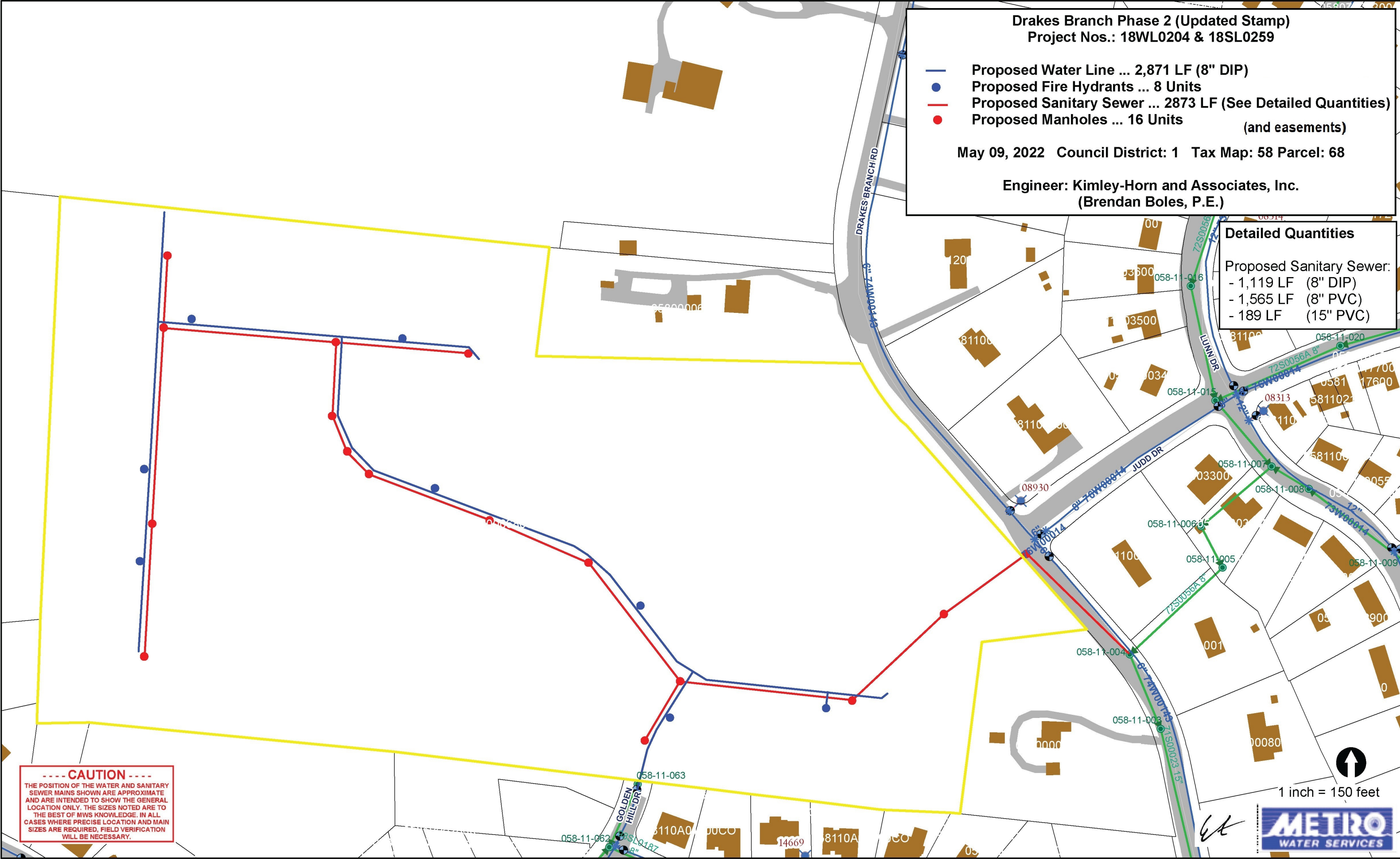

----- CAUTION -----

THE POSITION OF THE WATER AND SANITARY SEWER MAINS SHOWN ARE APPROXIMATE AND ARE INTENDED TO SHOW THE GENERAL LOCATION ONLY. THE SIZES NOTED ARE TO THE BEST OF MWS KNOWLEDGE. IN ALL CASES WHERE PRECISE LOCATION AND MAIN SIZES ARE REQUIRED, FIELD VERIFICATION WILL BE NECESSARY.

1 inch = 150 feet

