



**METROPOLITAN GOVERNMENT
OF NASHVILLE AND DAVIDSON COUNTY**

Planning Department
Metro Office Building
800 Second Avenue South
Nashville, Tennessee 37201

November 1, 2021

To: Mike Atchison, Metro Water Services

**Re: Amalie Drive Prv Relocation
Planning Commission Mandatory Referral #2021M-086ES-001
Council District #27 – Robert Nash, Council Member**

On behalf of the Metropolitan Planning Commission, the following item, referred to the Commission as required by the Metro Charter, has been recommended for *approval* to the Metropolitan Council:

A request for the relocation of a water pressure reducing valve into a proposed underground vault and construction of about 45 linear feet of 6-inch water main (DIP) and appurtenances. A permanent easement and a temporary construction easement (see sketch for details) are necessary to be acquired through negotiation, condemnation, and acceptance.

The relevant Metro agencies (Metro Parks, Metro Public Works, Metro Water Services, Metro Emergency Communications, the Nashville Electric Service, Metro Finance – Public Property and the Metro Historical Commission) have reviewed the proposal and concur in the recommendation for approval. This request must be approved by the Metro Council to become effective. A sketch showing the location of the request is attached to this letter.

Conditions that apply to this approval: None.

This recommendation for approval is given as set forth in the Metropolitan Planning Commission Rules and Procedures. If you have any questions about this matter, please contact Sharon O’Conner at Sharon.oconner@nashville.gov or 615-862-7208.

Sincerely,

A handwritten signature in black ink that reads 'Robert Leeman'.

Robert Leeman
Deputy Director
Metro Planning Department
cc: Metro Clerk, Elizabeth Waites

Re: Amalie Drive Prv Relocation
Planning Commission Mandatory Referral #2021M-086ES-001
Council District #27 – Robert Nash, Council Member

A request for the relocation of a water pressure reducing valve into a proposed underground vault and construction of about 45 linear feet of 6-inch water main (DIP) and appurtenances. A permanent easement and a temporary construction easement (see sketch for details) are necessary to be acquired through negotiation, condemnation, and acceptance.

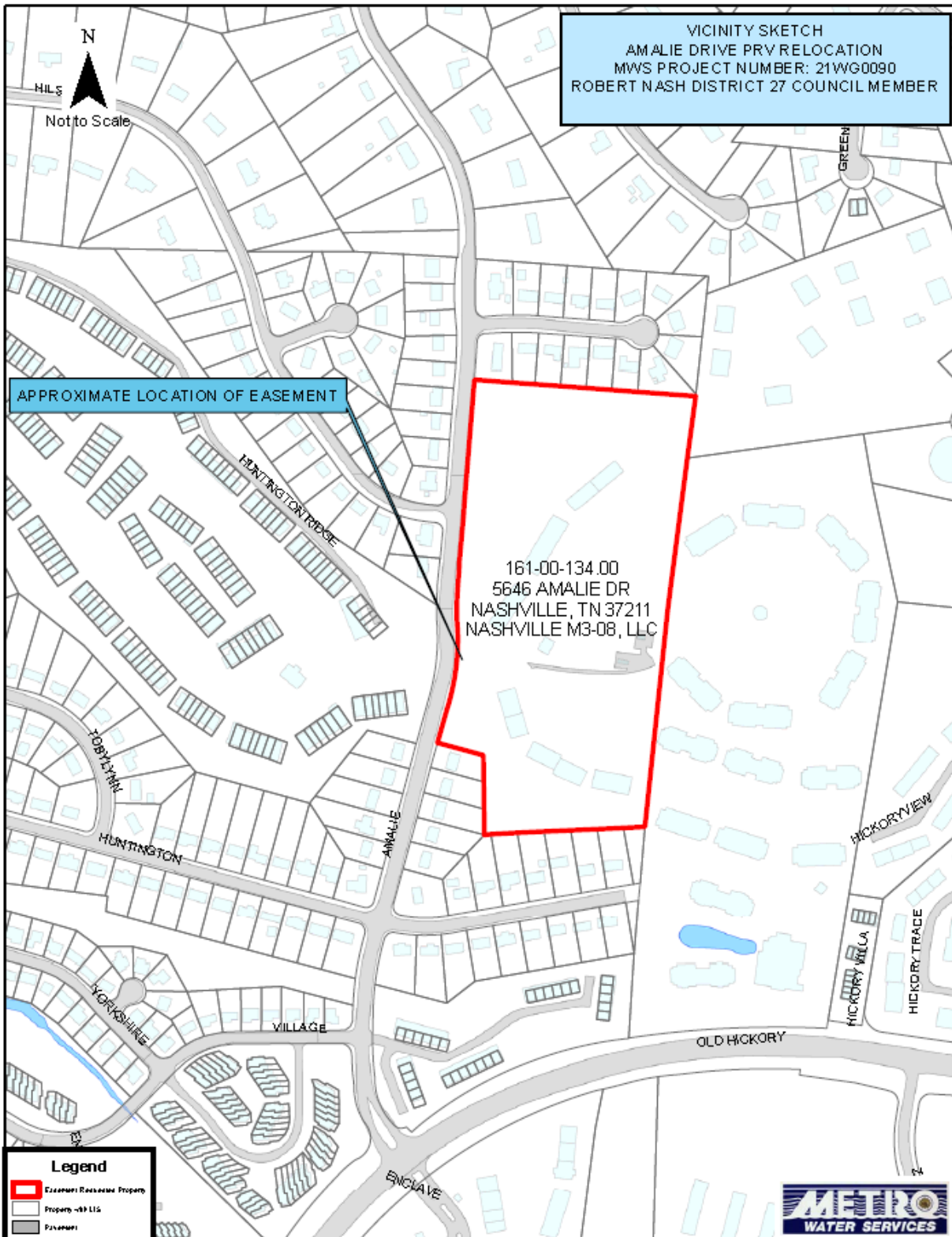

VICINITY SKETCH
AMALIE DRIVE PRV RELOCATION
MWS PROJECT NUMBER: 21WG0090
ROBERT NASH DISTRICT 27 COUNCIL MEMBER

N





HILLS

Not to Scale

APPROXIMATE LOCATION OF EASEMENT

161-00-134.00
5646 AMALIE DR
NASHVILLE, TN 37211
NASHVILLE M3-08, LLC

Legend

-  Easement Requested Property
-  Property with LIS
-  Pavement

