



December 12, 2023

To: Stephanie James Metro Water Services

Re: **Neelys Bend**
Planning Commission Mandatory Referral 2023M-198ES-001
Council District #09 Tonya Hancock, Council Member

On behalf of the Metropolitan Planning Commission, the following item, referred to the Commission as required by the Metro Charter, has been recommended for *approval* to the Metropolitan Council:

A request for the acceptance approximately 150 linear feet of eight-inch sanitary sewer main (PVC) and two sanitary sewer manholes to serve the development at 445 Neelys Bend Road.

The relevant Metro agencies (Metro Parks, Metro Public Works, Metro Water Services, Metro Emergency Communications, the Nashville Electric Service, Metro Finance – Public Property and the Metro Historical Commission) have reviewed the proposal and concur in the recommendation for approval. This request must be approved by the Metro Council to become effective. A sketch showing the location of the request is attached to this letter.

Conditions that apply to this approval: none

This recommendation for approval is given as set forth in the Metropolitan Planning Commission Rules and Procedures. If you have any questions about this matter, please contact Delilah Rhodes at Delilah.Rhodes@nashville.gov or 615-862-7208

Sincerely,

A handwritten signature in blue ink that reads "Lisa Milligan". The signature is written in a cursive, flowing style.

Lisa Milligan
Assistant Director Land Development
Metro Planning Department
cc: *Metro Clerk*

**Re: Neelys Bend
Planning Commission Mandatory Referral 2023M-198ES-001
Council District #09 Tonya Hancock, Council Member**

A request for the acceptance approximately 150 linear feet of eight inch sanitary sewer main (PVC) and two sanitary sewer manholes to serve the development at 445 Neelys Bend Road.

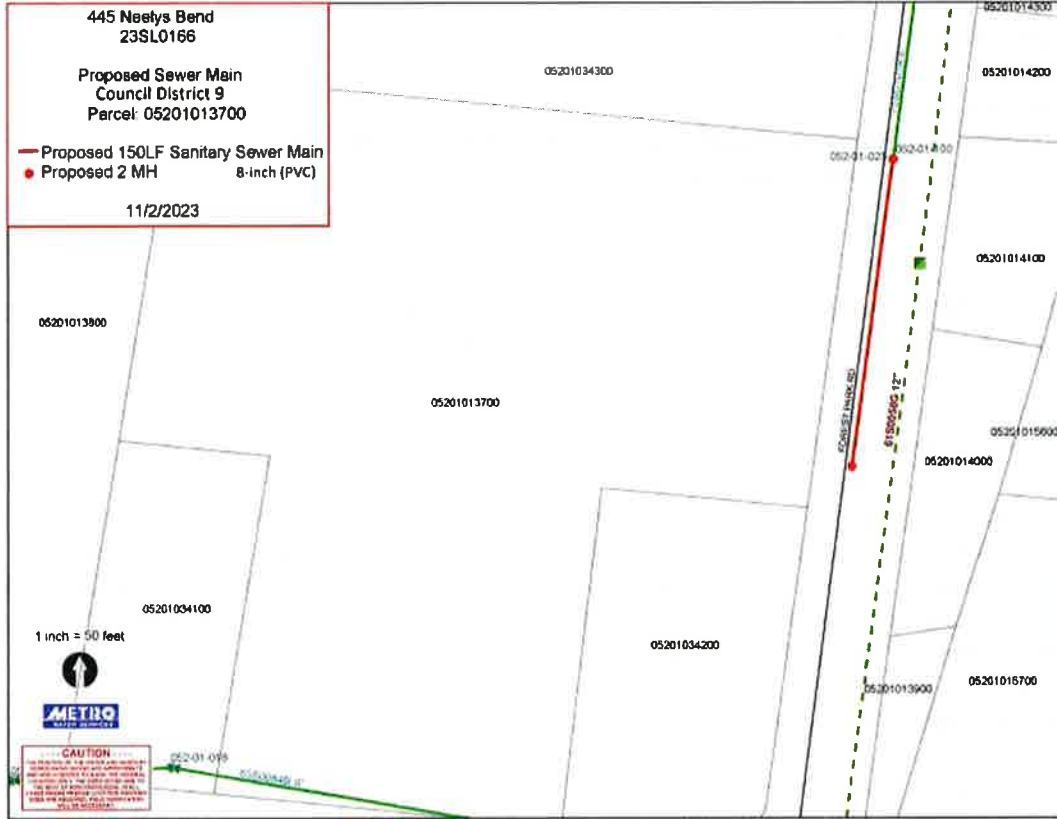

440 INCHES DEPTH

23SL0166

Proposed Sewer Main
Council District 9
Parcel: 05201013700

- Proposed 150LF Sanitary Sewer Main
- Proposed 2 MH 8-inch (PVC)

11/2/2023

05201013800

05201034300

05201014300

05201014200

052-01-025

052-01-100

05201014100

05201013700

05201015600

FOREST PARK RD

61S0058G 12"

05201014000

1 inch = 50 feet

05201034100

05201034200

05201014000

05201013900

05201015700

052-01-018

65S0064B 8"



CAUTION

THE POSITION OF THE WATER AND SANITARY SEWER MAINS SHOWN ARE APPROXIMATE AND ARE INTENDED TO SHOW THE GENERAL LOCATION ONLY. THE SIZES NOTED ARE TO THE BEST OF MWS KNOWLEDGE. IN ALL CASES WHERE PRECISE LOCATION AND MAIN SIZES ARE REQUIRED, FIELD VERIFICATION WILL BE NECESSARY.

05