



**METROPOLITAN GOVERNMENT OF NASHVILLE
AND DAVIDSON COUNTY**

Metro Office Building
800 President Ronald Reagan Way
P.O. Box 196300
Nashville, TN 37219-6300

September 18, 2022

To: Mike Atchison, Metro Water Services

**Re: SKY HARBOUR HANGERS
Planning Commission Mandatory Referral #2022M-139ES-001
Council District #13 Russ Bradford, Council Member**

On behalf of the Metropolitan Planning Commission, the following item, referred to the Commission as required by the Metro Charter, has been recommended for *approval* to the Metropolitan Council:

A request for the abandonment of 14 linear feet of 12 inch water main and the acceptance of 14 linear feet of 12 inch water main (DIP) to serve the Sky Harbour Hangers development..

The relevant Metro agencies (Metro Parks, Metro Public Works, Metro Water Services, Metro Emergency Communications, the Nashville Electric Service, Metro Finance – Public Property and the Metro Historical Commission) have reviewed the proposal and concur in the recommendation for approval. This request must be approved by the Metro Council to become effective. A sketch showing the location of the request is attached to this letter.

Conditions that apply to this approval: none

This recommendation for approval is given as set forth in the Metropolitan Planning Commission Rules and Procedures. If you have any questions about this matter, please contact Delilah Rhodes at delilah.rhodes@nashville.gov or 615-862-7208.

Sincerely,

A handwritten signature in blue ink that reads 'Lisa Milligan'.

Lisa Milligan
Land Development Manager
Metro Planning Department
cc: Metro Clerk

Re: SKY HARBOUR HANGERS
Planning Commission Mandatory Referral #2022M-139ES-001
Council District #13 Russ Bradford, Council Member

A request for the abandonment of 14 linear feet of 12 inch water main and the acceptance of 14 linear feet of 12 inch water main (DIP) to serve the Sky Harbour Hangers development.

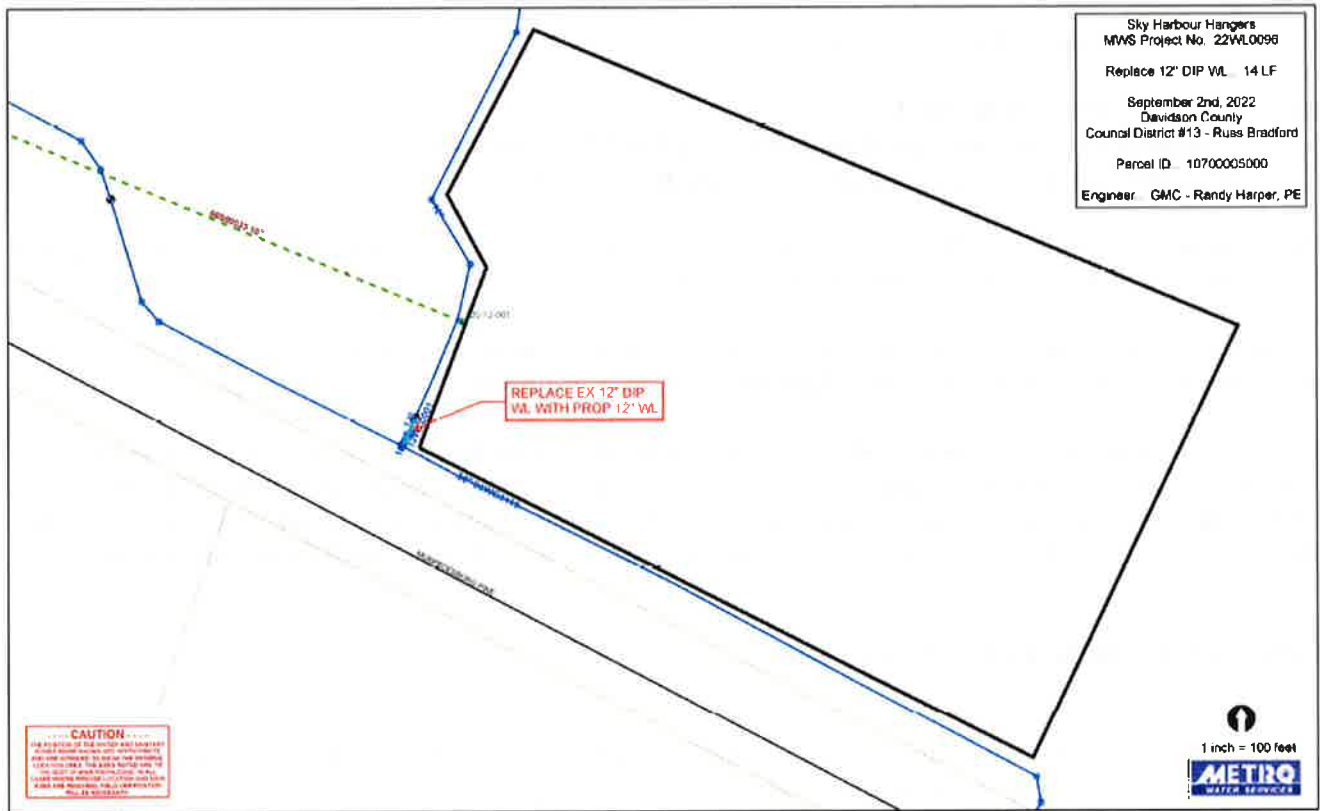

Sky Harbour Hangers
 MWS Project No.: 22WL0096
 Replace 12" DIP WL... 14 LF
 September 2nd, 2022
 Davidson County
 Council District #13 - Russ Bradford
 Parcel ID... 10700005000
 Engineer... GMC - Randy Harper, PE

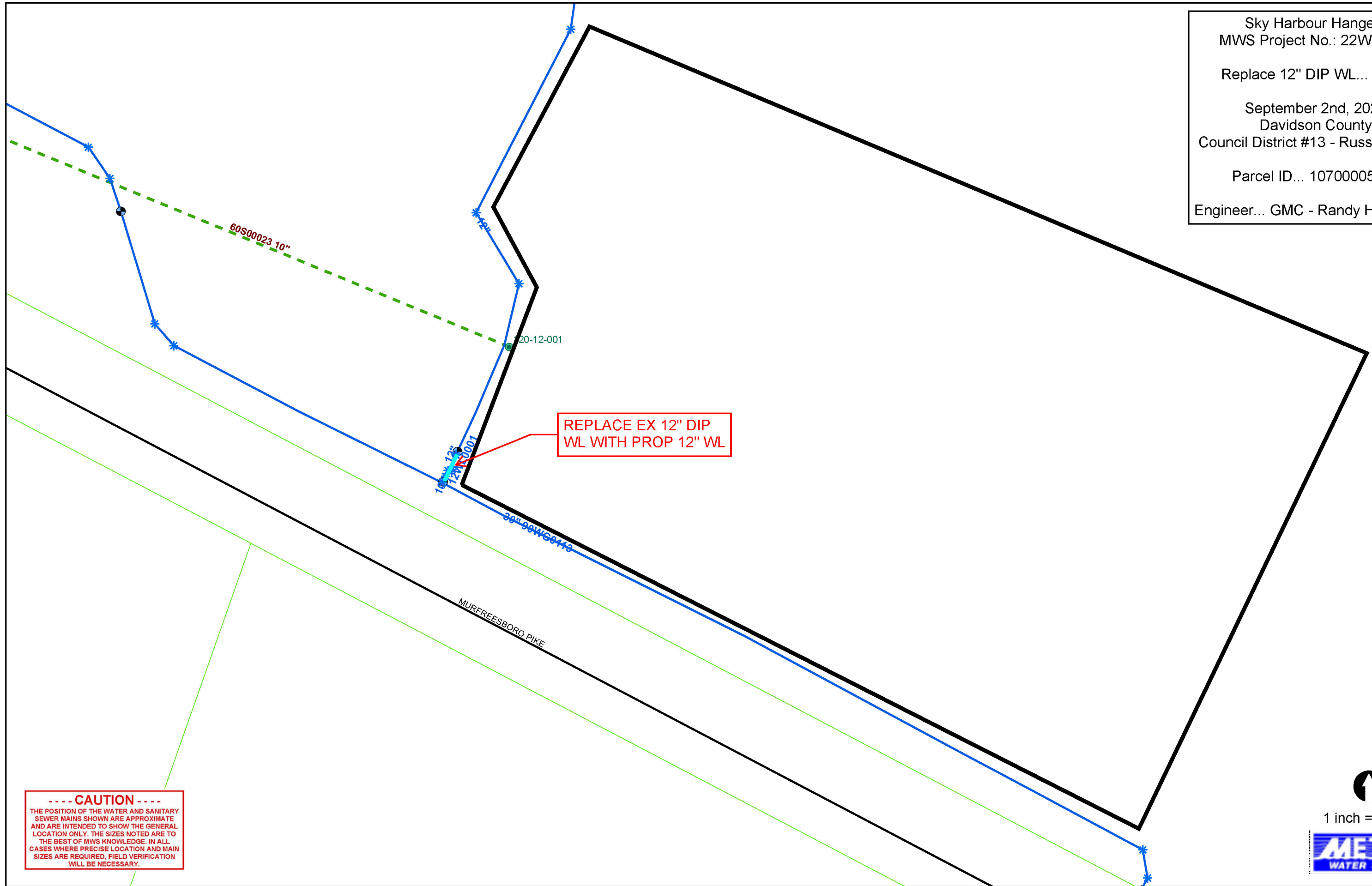

REPLACE EX 12" DIP
 WL WITH PROP 12" WL

----- CAUTION -----
 THE POSITION OF THE WATER AND SANITARY
 SEWER MAINS SHOWN ARE APPROXIMATE
 AND ARE INTENDED TO SHOW THE GENERAL
 LOCATION ONLY. THE SIZES NOTED ARE TO
 THE BEST OF MWS KNOWLEDGE. IN ALL
 CASES WHERE PRECISE LOCATION AND MAIN
 SIZES ARE REQUIRED, FIELD VERIFICATION
 WILL BE NECESSARY.

