



**METROPOLITAN GOVERNMENT OF NASHVILLE
AND DAVIDSON COUNTY**

Metro Office Building
800 President Ronald Reagan Way
P.O. Box 196300
Nashville, TN 37219-6300

March 27, 2023

To: Edward Thurman Metro Water Services

**Re: 625 WEST TRINITY LANE
Planning Commission Mandatory Referral # 2023M-050ES-001
Council District #02 Kyonzte Toombs, Council Member**

On behalf of the Metropolitan Planning Commission, the following item, referred to the Commission as required by the Metro Charter, has been recommended for *approval* to the Metropolitan Council:

A request for the relocation of one fire hydrant assembly to serve the development at 625 West Trinity Lane.

The relevant Metro agencies (Metro Parks, Metro Public Works, Metro Water Services, Metro Emergency Communications, the Nashville Electric Service, Metro Finance – Public Property and the Metro Historical Commission) have reviewed the proposal and concur in the recommendation for approval. This request must be approved by the Metro Council to become effective. A sketch showing the location of the request is attached to this letter.

Conditions that apply to this approval: none

This recommendation for approval is given as set forth in the Metropolitan Planning Commission Rules and Procedures. If you have any questions about this matter, please contact Delilah Rhodes at delilah.rhodes@nashville.gov or 615-862-7208.

Sincerely,

A handwritten signature in blue ink that reads "Lisa Milligan".

Lisa Milligan
Land Development Manager
Metro Planning Department
cc: *Metro Clerk*

Re: 625 WEST TRINITY LANE
Planning Commission Mandatory Referral # 2023M-050ES-001
Council District #02 Kyontze Toombs, Council Member

A request for the relocation of one fire hydrant assembly to serve the development at 625 West Trinity Lane.

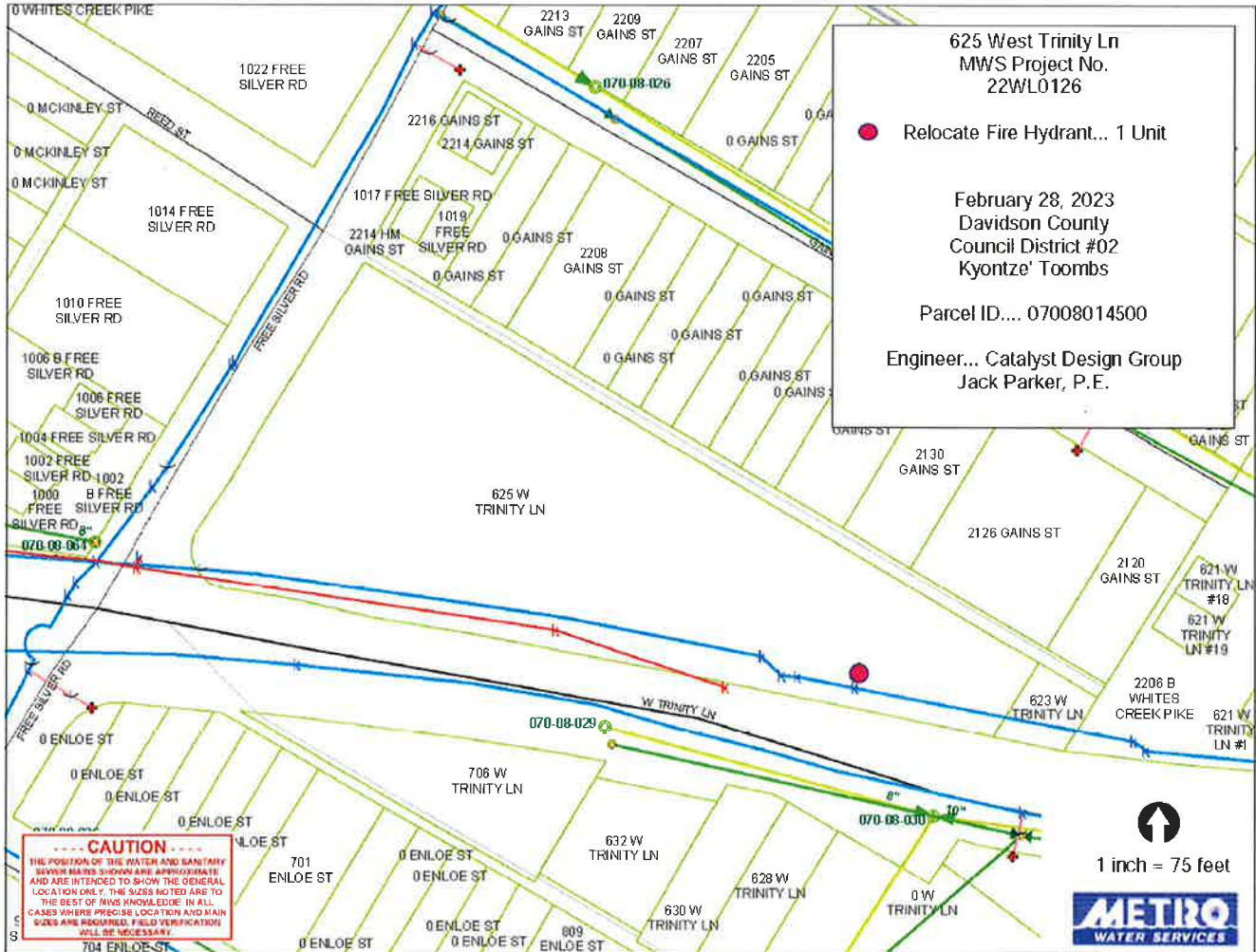

625 West Trinity Ln
MWS Project No.
22WL0126

● Relocate Fire Hydrant... 1 Unit

February 28, 2023
Davidson County
Council District #02
Kyontze' Toombs

Parcel ID.... 07008014500

Engineer... Catalyst Design Group
Jack Parker, P.E.

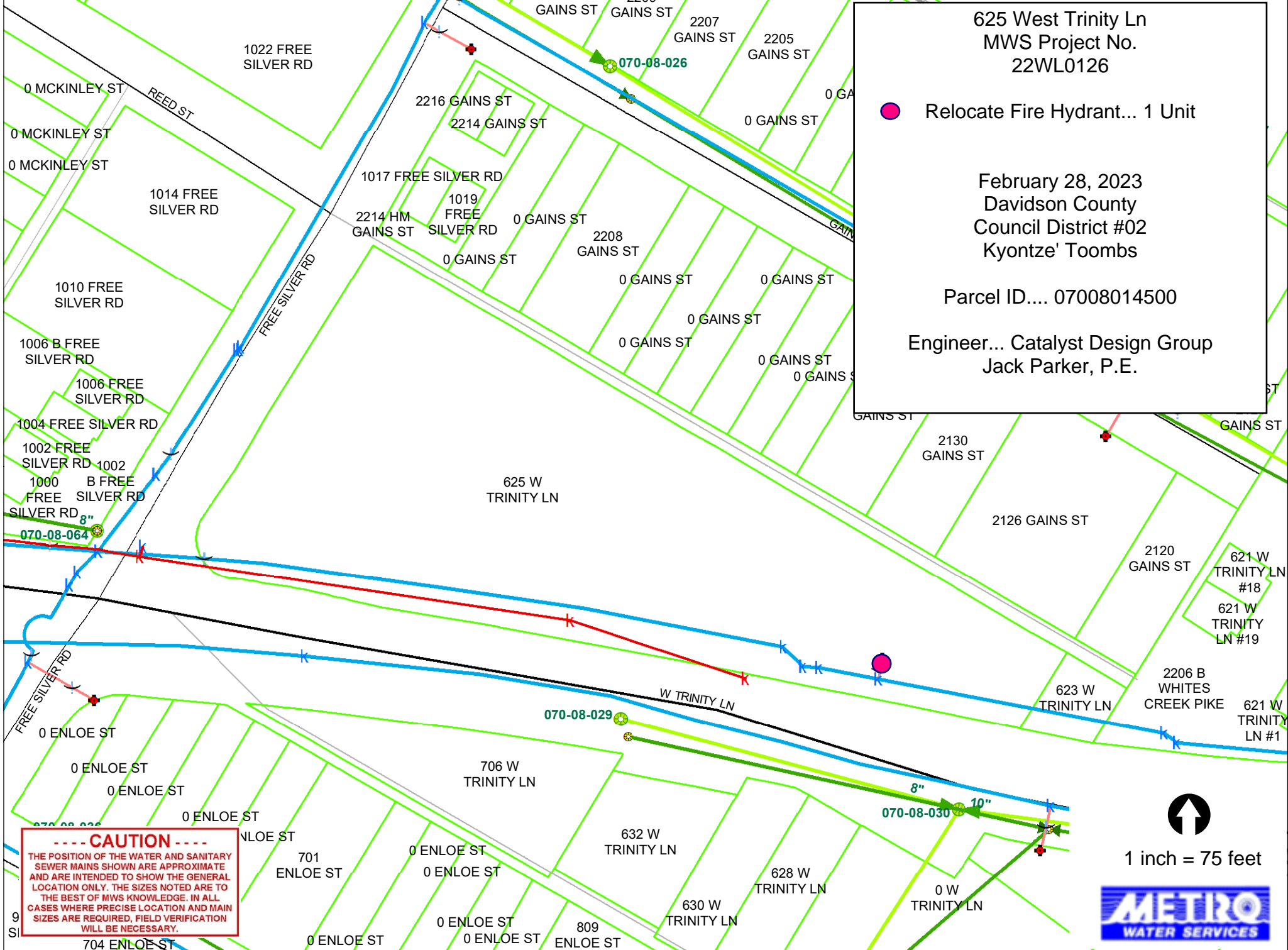

CAUTION

THE POSITION OF THE WATER AND SANITARY SEWER MAINS SHOWN ARE APPROXIMATE AND ARE INTENDED TO SHOW THE GENERAL LOCATION ONLY. THE SIZES NOTED ARE TO THE BEST OF MWS KNOWLEDGE. IN ALL CASES WHERE PRECISE LOCATION AND MAIN SIZES ARE REQUIRED, FIELD VERIFICATION WILL BE NECESSARY.



1 inch = 75 feet

