



**METROPOLITAN GOVERNMENT  
OF NASHVILLE AND DAVIDSON COUNTY**

Planning Department  
Metro Office Building  
800 Second Avenue South  
Nashville, Tennessee 37201

December 16, 2020

To: Mike Atchison, Metro Water Services

**Re: Heartland North Phase 1  
Planning Commission Mandatory Referral #2020M-110ES-001**  
Council District #03 – Jennifer Gamble, Council Member

On behalf of the Metropolitan Planning Commission, the following item, referred to the Commission as required by the Metro Charter, has been recommended for *approval* to the Metropolitan Council:

*A request for the abandonment of approximately 1,350 linear feet of 8-inch water main and easements, and the acceptance of approximately 1,655 linear feet of 12-inch water main (DIP), 2,866 linear feet of 8-inch water main (DIP), five fire hydrant assemblies, one pressure reducing valve, 2,254 linear feet of 8-inch sanitary sewer main, 18 sanitary sewer manholes, easements, and the reconnection of three existing fire hydrant assemblies to serve the Heartland North Phase 1 development. (see sketch for details). (MWS Project Nos. 18-SL-226 and 18-WL-172).*

The relevant Metro agencies (Metro Parks, Metro Public Works, Metro Water Services, Metro Emergency Communications, the Nashville Electric Service, Metro Finance – Public Property and the Metro Historical Commission) have reviewed the proposal and concur in the recommendation for approval. This request must be approved by the Metro Council to become effective. A sketch showing the location of the request is attached to this letter.

**Conditions that apply to this approval: None.**

This recommendation for approval is given as set forth in the Metropolitan Planning Commission Rules and Procedures. If you have any questions about this matter, please contact Sharon O'Conner at [Sharon.oconner@nashville.gov](mailto:Sharon.oconner@nashville.gov) or 615-862-7208.

Sincerely,

A handwritten signature in black ink that reads 'Robert Leeman'.

Robert Leeman, AICP  
Deputy Director  
Metro Planning Department  
cc: Metro Clerk, Elizabeth Waites

**Re: Heartland North Phase 1**  
**Planning Commission Mandatory Referral #2020M-110ES-001**  
Council District #03 – Jennifer Gamble, Council Member

A request for the abandonment of approximately 1,350 linear feet of 8-inch water main and easements, and the acceptance of approximately 1,655 linear feet of 12-inch water main (DIP), 2,866 linear feet of 8-inch water main (DIP), five fire hydrant assemblies, one pressure reducing valve, 2,254 linear feet of 8-inch sanitary sewer main, 18 sanitary sewer manholes, easements, and the reconnection of three existing fire hydrant assemblies to serve the Heartland North Phase 1 development. (see sketch for details). (MWS Project Nos. 18-SL-226 and 18-WL-172).

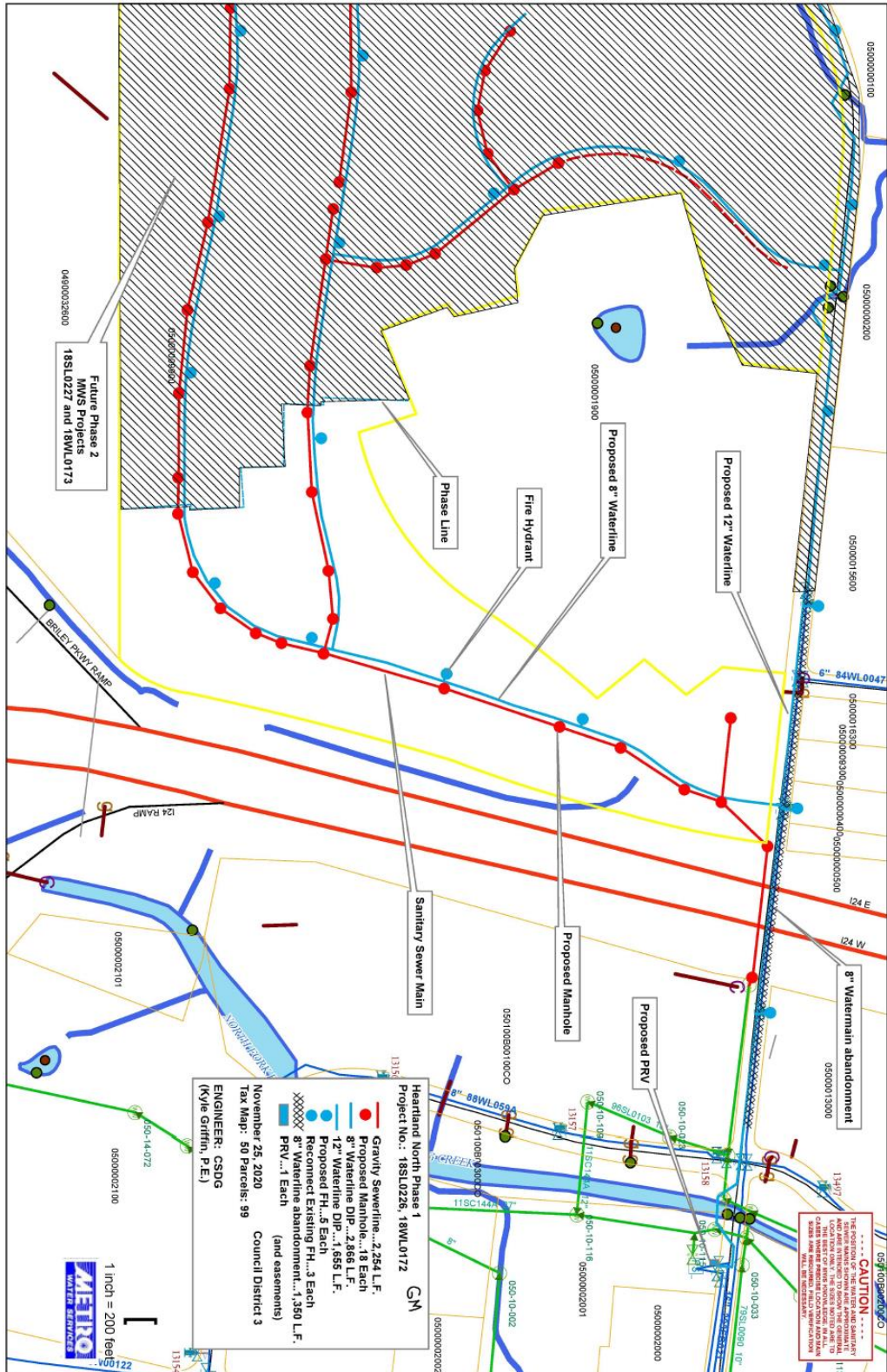

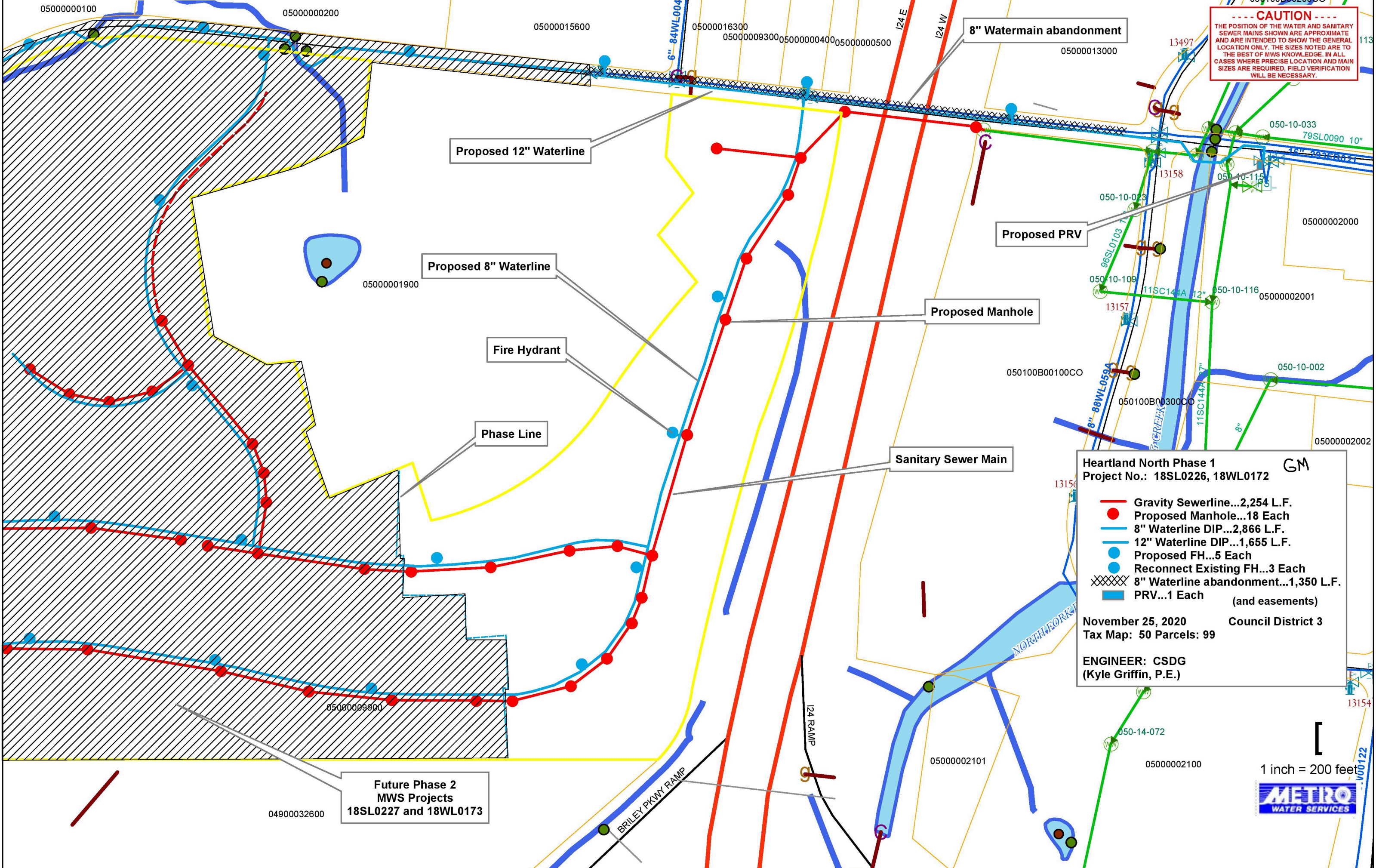

**CAUTION**  
 THE POSITION OF THE WATER AND SANITARY SEWER MAINS SHOWN ARE APPROXIMATE AND ARE INTENDED TO SHOW THE GENERAL LOCATION ONLY. THE SIZES NOTED ARE TO THE BEST OF MWS KNOWLEDGE. IN ALL CASES WHERE PRECISE LOCATION AND MAIN SIZES ARE REQUIRED, FIELD VERIFICATION WILL BE NECESSARY.

**Heartland North Phase 1** GM  
 Project No.: 18SL0226, 18WL0172

- Gravity Sewerline...2,254 L.F.
- Proposed Manhole...18 Each
- 8" Waterline DIP...2,866 L.F.
- 12" Waterline DIP...1,655 L.F.
- Proposed FH...5 Each
- Reconnect Existing FH...3 Each
- XXXX 8" Waterline abandonment...1,350 L.F.
- PRV...1 Each (and easements)

November 25, 2020 Council District 3  
 Tax Map: 50 Parcels: 99

ENGINEER: CSDG  
 (Kyle Griffin, P.E.)

1 inch = 200 feet

Future Phase 2  
 MWS Projects  
 18SL0227 and 18WL0173

8" Watermain abandonment

Proposed 12" Waterline

Proposed 8" Waterline

Fire Hydrant

Phase Line

Proposed Manhole

Sanitary Sewer Main

Proposed PRV

BRILEY PKWY RAMP

I24 RAMP

I24 E

I24 W

NORTH CREEK

0500000100

0500000200

05000015600

05000016300

05000009300

05000000400

05000000500

05000013000

13497

050-10-033

79SL0090 10"

05000002000

05000001900

050-10-023

050-10-109

11SC144A 12"

050-10-116

05000002001

050100B00100CO

050100B00300CO

050-10-002

05000002002

05000009800

05000002101

05000002100

04900032600

13154

050-14-072

13152