



**METROPOLITAN GOVERNMENT OF NASHVILLE
AND DAVIDSON COUNTY**

Metro Office Building
800 President Ronald Reagan Way
P.O. Box 196300
Nashville, TN 37219-6300

May 18, 2023

To: Mike Atchison Metro Water Services

Re: **4311 CASTLEMAN COURT**
Planning Commission Mandatory Referral # 2023M-074ES-001
Council District #25 Russ Pulley, Council Member

On behalf of the Metropolitan Planning Commission, the following item, referred to the Commission as required by the Metro Charter, has been recommended for *approval* to the Metropolitan Council:

A request for the abandonment of approximately 311 linear feet of 8-inch sanitary sewer mains, one sanitary sewer manhole, and easement and the acceptance of approximately 268 linear feet of 8-inch sanitary sewer mains (PVC), one sanitary sewer manhole, and easement to serve the development at 4311 Castleman Court.

The relevant Metro agencies (Metro Parks, Metro Public Works, Metro Water Services, Metro Emergency Communications, the Nashville Electric Service, Metro Finance – Public Property and the Metro Historical Commission) have reviewed the proposal and concur in the recommendation for approval. This request must be approved by the Metro Council to become effective. A sketch showing the location of the request is attached to this letter.

Conditions that apply to this approval: none

This recommendation for approval is given as set forth in the Metropolitan Planning Commission Rules and Procedures. If you have any questions about this matter, please contact Delilah Rhodes at delilah.rhodes@nashville.gov or 615-862-7208.

Sincerely,

A handwritten signature in blue ink that reads 'Lisa Milligan'.

Lisa Milligan
Land Development Manager
Metro Planning Department
cc: *Metro Clerk*

Re: 4311 CASTLEMAN COURT
Planning Commission Mandatory Referral # 2023M-074ES-001
Council District #25 Russ Pulley, Council Member

A request for the abandonment of approximately 311 linear feet of 8-inch sanitary sewer mains, one sanitary sewer manhole, and easement and the acceptance of approximately 268 linear feet of 8-inch sanitary sewer mains (PVC), one sanitary sewer manhole, and easement to serve the development at 4311 Castleman Court.

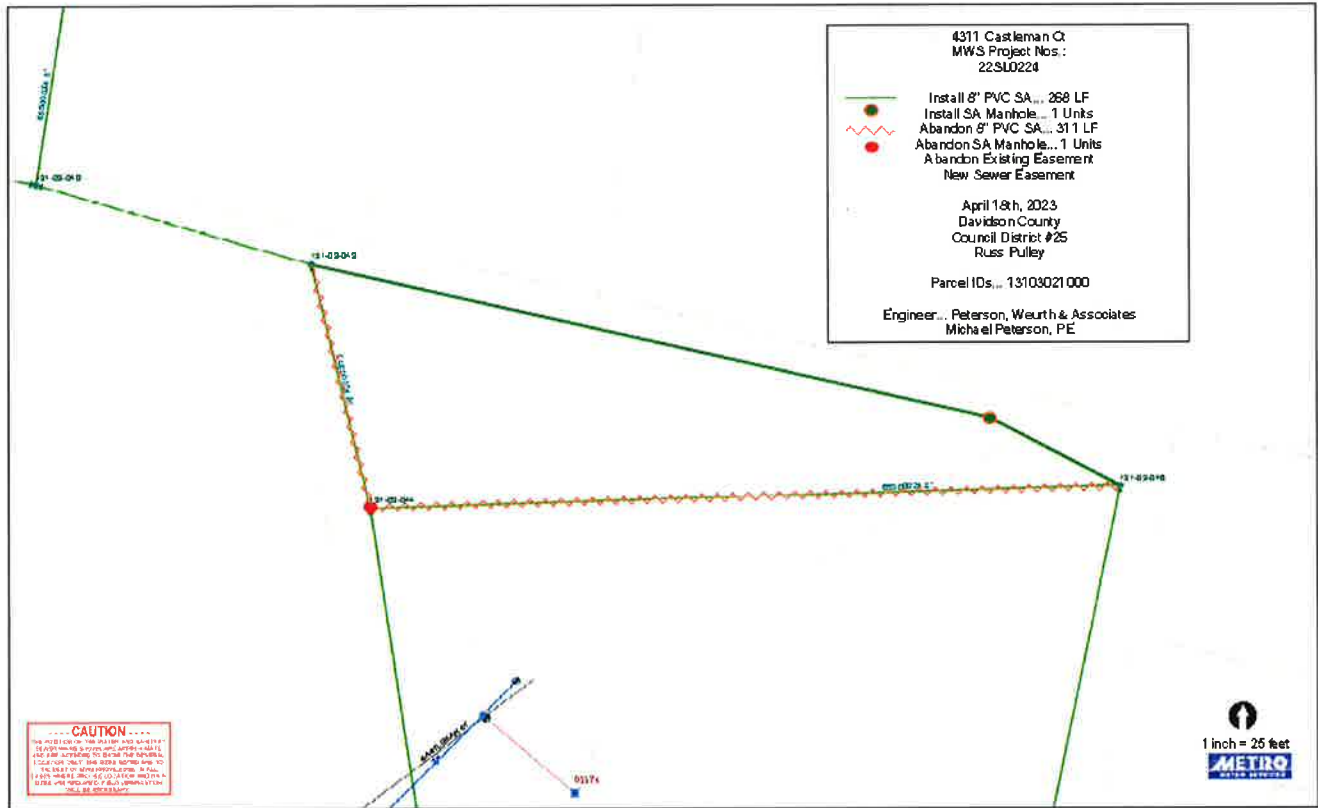

4311 Castleman Ct
 MWS Project Nos.:
 22SL0224

Install 8" PVC SA... 268 LF
 Install SA Manhole... 1 Units
 Abandon 8" PVC SA... 311 LF
 Abandon SA Manhole... 1 Units
 Abandon Existing Easement
 Sewer Easement

April 18th, 2023
 Davidson County
 Council District #25
 Russ Pulley

Parcel IDs... 13103021000 and 13103020900

Engineer... Peterson, Weurth & Associates
 Michael Peterson, PE

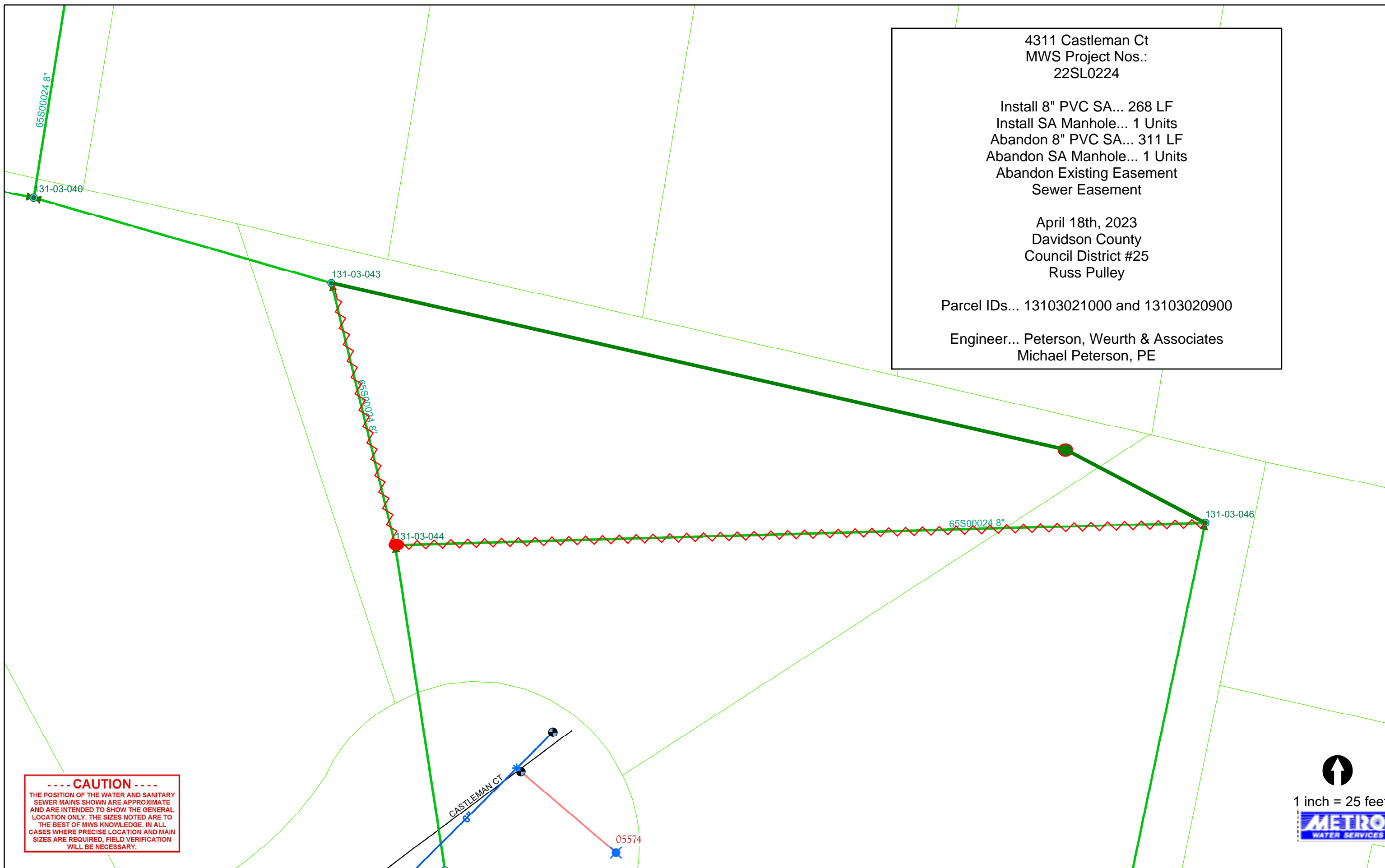

----- CAUTION -----
 THE POSITION OF THE WATER AND SANITARY
 SEWER MAINS SHOWN ARE APPROXIMATE
 AND ARE INTENDED TO SHOW THE GENERAL
 LOCATION ONLY. THE SIZES NOTED ARE TO
 THE BEST OF MWS KNOWLEDGE. IN ALL
 CASES WHERE PRECISE LOCATION AND MAIN
 SIZES ARE REQUIRED, FIELD VERIFICATION
 WILL BE NECESSARY.



1 inch = 25 feet