



**METROPOLITAN GOVERNMENT OF NASHVILLE  
AND DAVIDSON COUNTY**

Metro Office Building  
800 President Ronald Reagan Way  
P.O. Box 196300  
Nashville, TN 37219-6300

October 4, 2022

To: Stephanie James, Metro Water Services

**Re: 1300 PENNOCK AVE  
Planning Commission Mandatory Referral #2022M-149ES-001  
Council District #05 Sean Parker, Council Member**

On behalf of the Metropolitan Planning Commission, the following item, referred to the Commission as required by the Metro Charter, has been recommended for *approval* to the Metropolitan Council:

*A request for the acceptance of one sanitary sewer manhole to serve the development at 1300 Pennock Avenue.*

The relevant Metro agencies (Metro Parks, Metro Public Works, Metro Water Services, Metro Emergency Communications, the Nashville Electric Service, Metro Finance – Public Property and the Metro Historical Commission) have reviewed the proposal and concur in the recommendation for approval. This request must be approved by the Metro Council to become effective. A sketch showing the location of the request is attached to this letter.

**Conditions that apply to this approval: none**

This recommendation for approval is given as set forth in the Metropolitan Planning Commission Rules and Procedures. If you have any questions about this matter, please contact Delilah Rhodes at [delilah.rhodes@nashville.gov](mailto:delilah.rhodes@nashville.gov) or 615-862-7208.

Sincerely,

A handwritten signature in blue ink, appearing to read "Lisa Milligan".

Lisa Milligan  
Land Development Manager  
Metro Planning Department  
cc: *Metro Clerk*

**Re: 1300 PENNOCK AVE  
Planning Commission Mandatory Referral #2022M-149ES-001  
Council District #05 Sean Parker, Council Member**

*A request for the acceptance of one sanitary sewer manhole to serve the development at 1300 Pennock Avenue.*

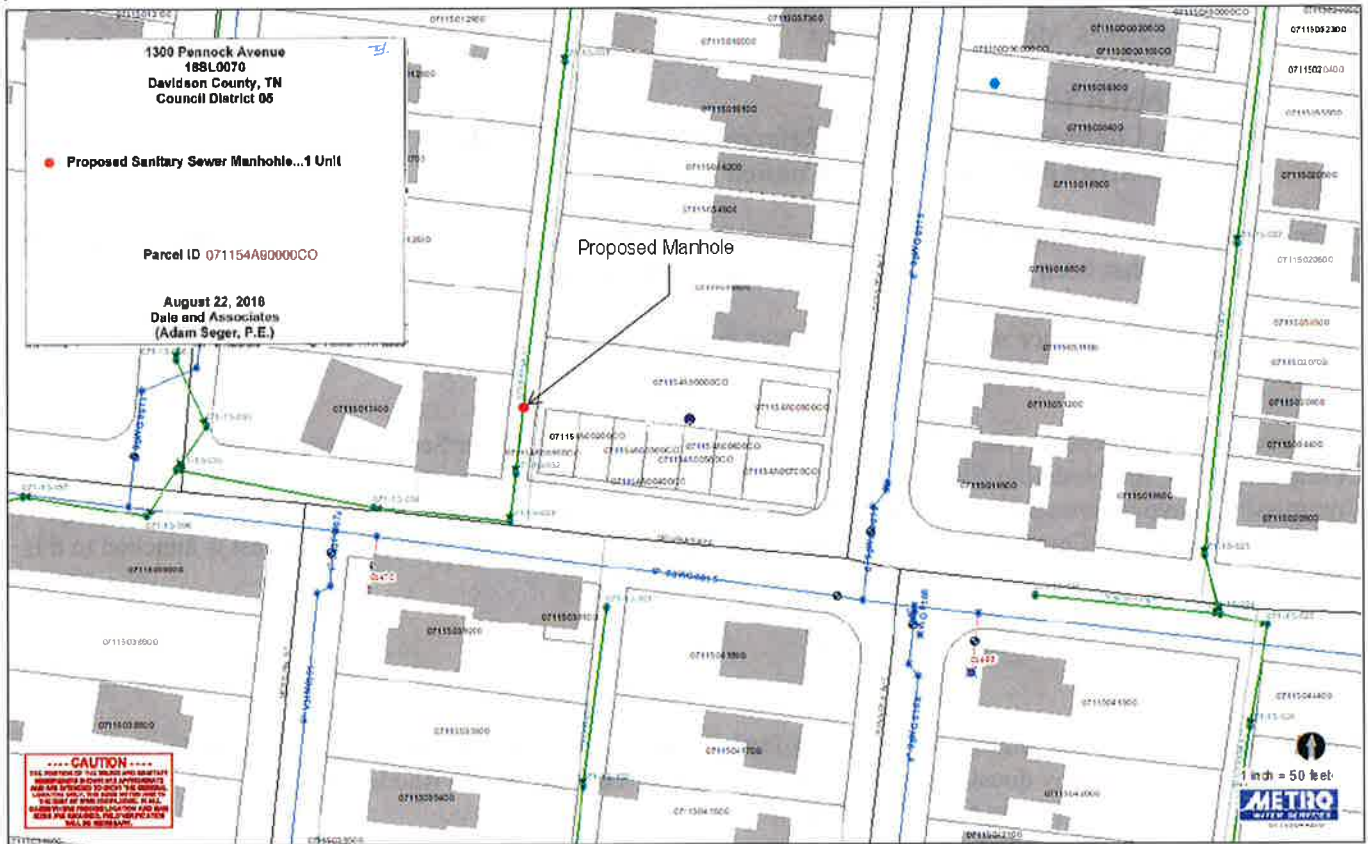

1300 Pennock Avenue  
18SL0070  
Davidson County, TN  
Council District 05

● Proposed Sanitary Sewer Manhole...1 Unit

Parcel ID 071154A90000CO

August 22, 2018  
Dale and Associates  
(Adam Seger, P.E.)

Proposed Manhole

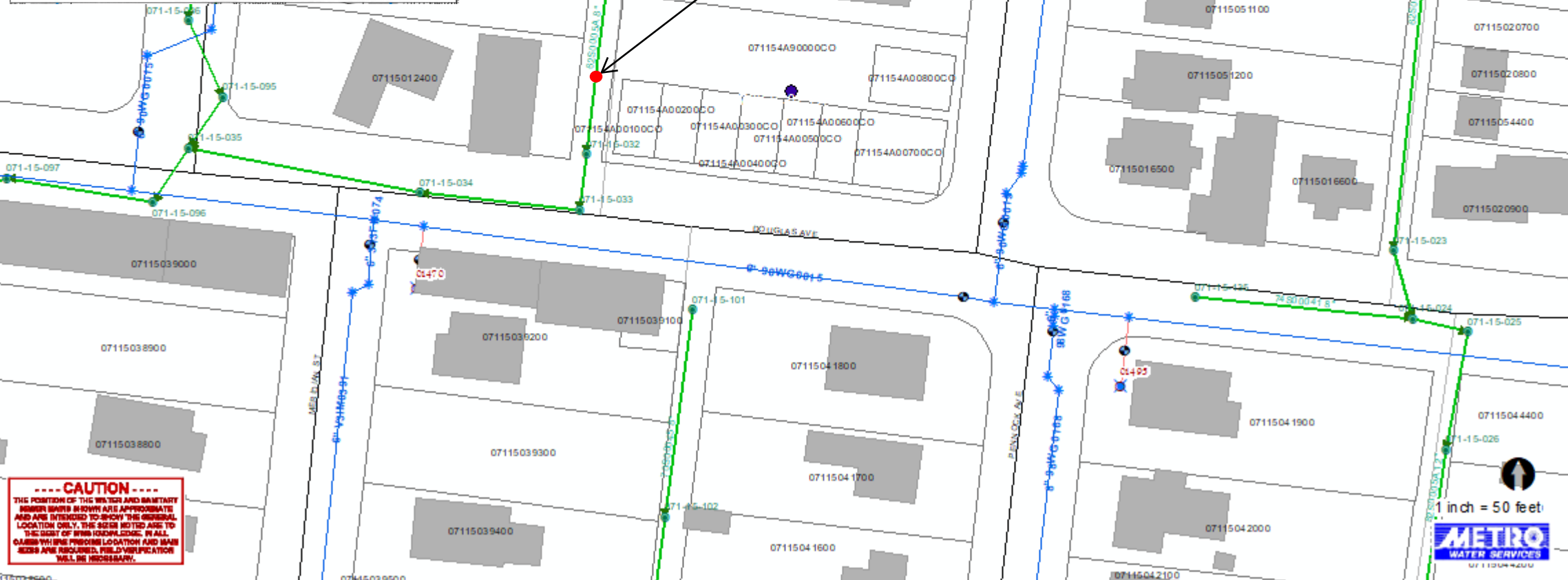

**----- CAUTION -----**  
THE POSITION OF THE WATER AND SANITARY SEWER MAINS SHOWN ARE APPROXIMATE AND ARE INTENDED TO SHOW THE GENERAL LOCATION ONLY. THE USER MUST BE TO THE BEST OF HIS KNOWLEDGE. ALL CASES WHERE PRECISE LOCATION AND MAIN DEPTHS ARE REQUIRED, FIELD VERIFICATION WILL BE NECESSARY.

1 inch = 50 feet  
**METRO**  
WATER SERVICES  
OF NORTHEAST TENNESSEE