



January 17, 2024

To: Mike Atchison Metro Water Services

Re: **Dickerson and Meridian**
Planning Commission Mandatory Referral 2024M-008ES-001
Council District #05 Sean Parker, Council Member

On behalf of the Metropolitan Planning Commission, the following item, referred to the Commission as required by the Metro Charter, has been recommended for *approval* to the Metropolitan Council:

A request for the abandonment of 932 linear feet of 15-inch sanitary sewer main (unknown material), 318 linear feet of 12-inch sanitary sewer main (unknown material), 179 linear feet of 10-inch sanitary sewer main (unknown material), 414 linear feet of 8-inch sanitary sewer main (unknown material), 55 linear feet of 15-inch sanitary sewer main (VCP), 8 sanitary sewer manholes, 535 linear feet of 12-inch water main (cast iron), 2,099 linear feet of 6-inch water main (cast iron), 5 fire hydrant assemblies, and easements and the acceptance of approximately 513 linear feet of 18-inch sanitary sewer main (PVC), 483 linear feet of 15-inch sanitary sewer main (PVC), 428 linear feet of 12-inch sanitary sewer main (PVC), 14 sanitary sewer manholes, 793 linear feet of 12-inch water main (DIP), 1,299 linear feet of 8-inch water main (DIP), 4 fire hydrant assemblies and easements the to serve the Dickerson and Meridian development.

The relevant Metro agencies (Metro Parks, Metro Public Works, Metro Water Services, Metro Emergency Communications, the Nashville Electric Service, Metro Finance – Public Property and the Metro Historical Commission) have reviewed the proposal and concur in the recommendation for approval. This request must be approved by the Metro Council to become effective. A sketch showing the location of the request is attached to this letter.

Conditions that apply to this approval: none

This recommendation for approval is given as set forth in the Metropolitan Planning Commission Rules and Procedures. If you have any questions about this matter, please contact Delilah Rhodes at Delilah.Rhodes@nashville.gov or 615-862-7208

Sincerely,

A handwritten signature in blue ink, appearing to read "Lisa Milligan".

Lisa Milligan
Assistant Director Land Development
Metro Planning Department
cc: *Metro Clerk*

**Re: Dickerson and Meridian
Planning Commission Mandatory Referral 2024M-008ES-001
Council District #05 Sean Parker, Council Member**

A request for the abandonment of 932 linear feet of 15-inch sanitary sewer main (unknown material), 318 linear feet of 12-inch sanitary sewer main (unknown material), 179 linear feet of 10-inch sanitary sewer main (unknown material), 414 linear feet of 8-inch sanitary sewer main (unknown material), 55 linear feet of 15-inch sanitary sewer main (VCP), 8 sanitary sewer manholes, 535 linear feet of 12-inch water main (cast iron), 2,099 linear feet of 6-inch water main (cast iron), 5 fire hydrant assemblies, and easements and the acceptance of approximately 513 linear feet of 18-inch sanitary sewer main (PVC), 483 linear feet of 15-inch sanitary sewer main (PVC), 428 linear feet of 12-inch sanitary sewer main (PVC), 14 sanitary sewer manholes, 793 linear feet of 12-inch water main (DIP), 1,299 linear feet of 8-inch water main (DIP), 4 fire hydrant assemblies and easements to serve the Dickerson and Meridian development.

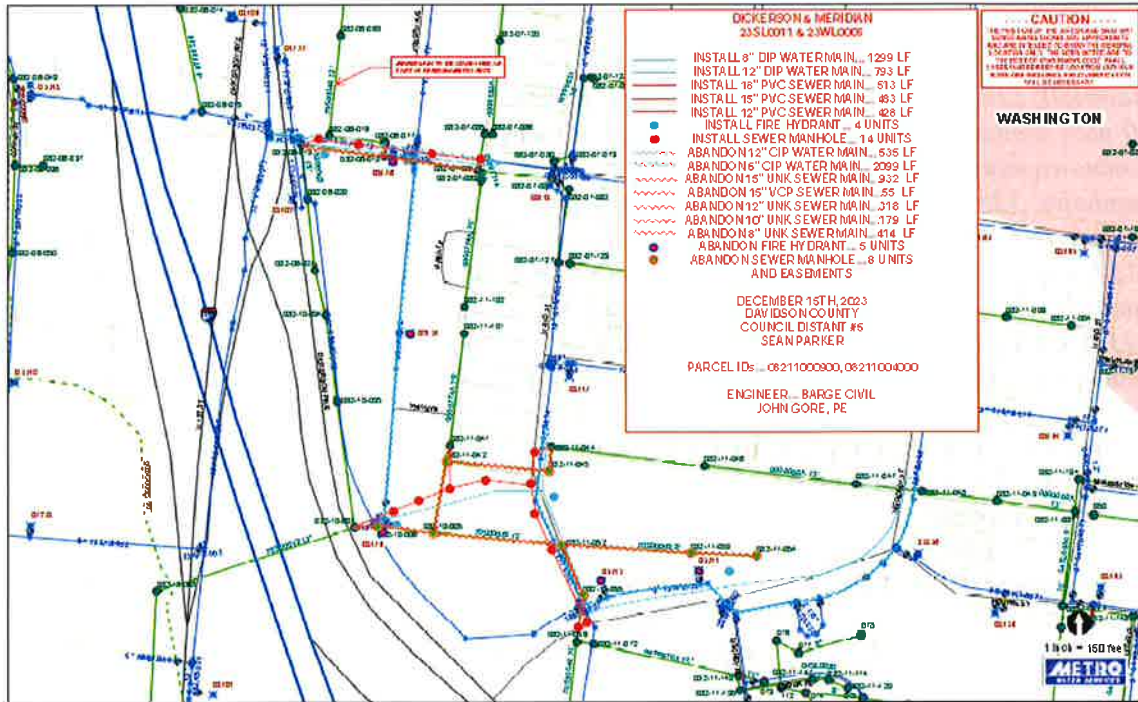

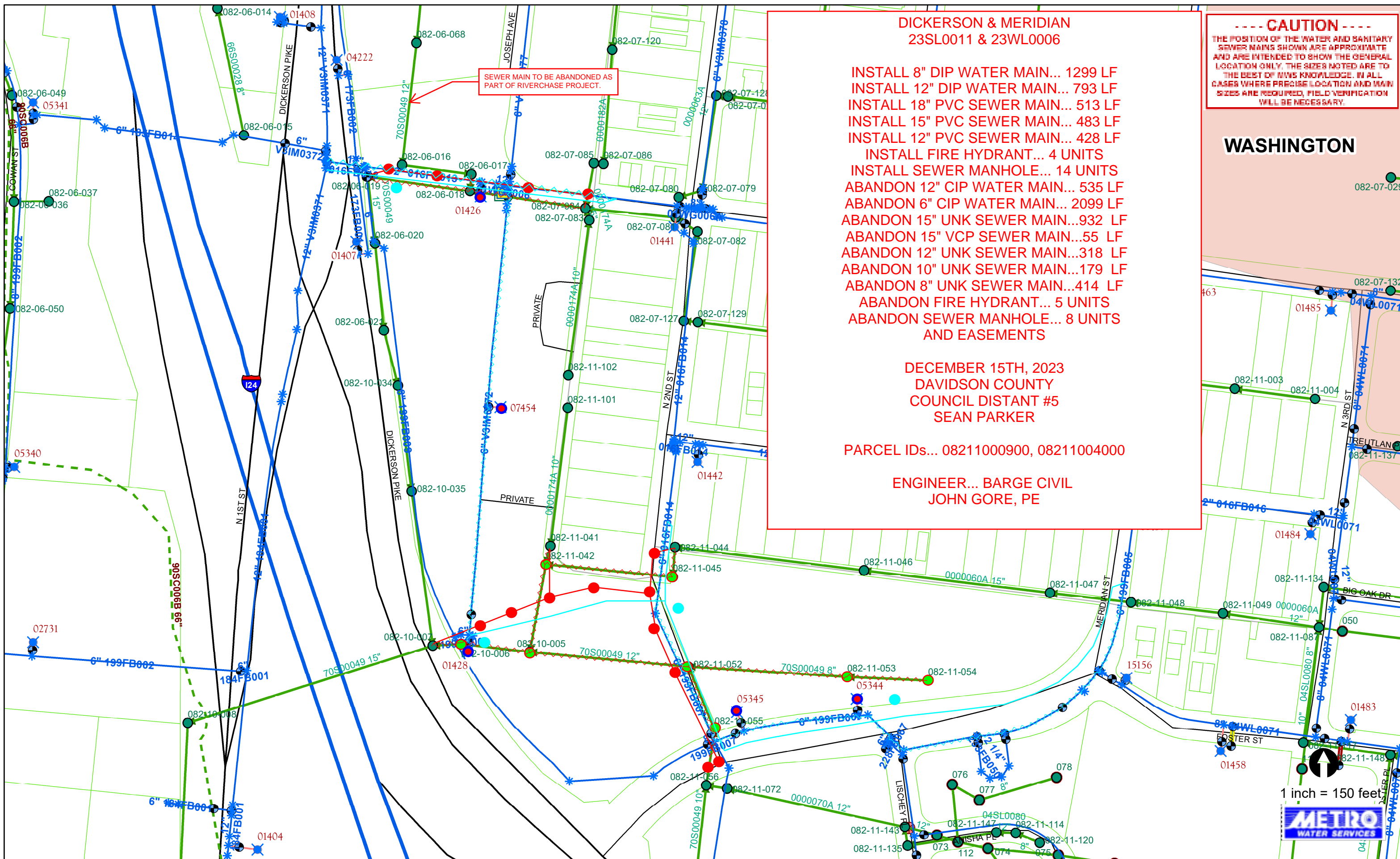

SEWER MAIN TO BE ABANDONED AS PART OF RIVERCHASE PROJECT.

DICKERSON & MERIDIAN
23SL0011 & 23WL0006

INSTALL 8" DIP WATER MAIN... 1299 LF
 INSTALL 12" DIP WATER MAIN... 793 LF
 INSTALL 18" PVC SEWER MAIN... 513 LF
 INSTALL 15" PVC SEWER MAIN... 483 LF
 INSTALL 12" PVC SEWER MAIN... 428 LF
 INSTALL FIRE HYDRANT... 4 UNITS
 INSTALL SEWER MANHOLE... 14 UNITS
 ABANDON 12" CIP WATER MAIN... 535 LF
 ABANDON 6" CIP WATER MAIN... 2099 LF
 ABANDON 15" UNK SEWER MAIN... 932 LF
 ABANDON 15" VCP SEWER MAIN... 55 LF
 ABANDON 12" UNK SEWER MAIN... 318 LF
 ABANDON 10" UNK SEWER MAIN... 179 LF
 ABANDON 8" UNK SEWER MAIN... 414 LF
 ABANDON FIRE HYDRANT... 5 UNITS
 ABANDON SEWER MANHOLE... 8 UNITS
 AND EASEMENTS

DECEMBER 15TH, 2023
 DAVIDSON COUNTY
 COUNCIL DISTANT #5
 SEAN PARKER

PARCEL IDs... 08211000900, 08211004000

ENGINEER... BARGE CIVIL
 JOHN GORE, PE

----- CAUTION -----
 THE POSITION OF THE WATER AND SANITARY SEWER MAINS SHOWN ARE APPROXIMATE AND ARE INTENDED TO SHOW THE GENERAL LOCATION ONLY. THE SIZES NOTED ARE TO THE BEST OF MWS KNOWLEDGE. IN ALL CASES WHERE PRECISE LOCATION AND MAIN SIZES ARE REQUIRED, FIELD VERIFICATION WILL BE NECESSARY.

WASHINGTON

1 inch = 150 feet

