



**METROPOLITAN GOVERNMENT  
OF NASHVILLE AND DAVIDSON COUNTY**

Planning Department  
Metro Office Building  
800 Second Avenue South  
Nashville, Tennessee 37201

April 05, 2022

To: Mike Atchison, Metro Water

**Re: Timber Trails Phase 3  
Planning Commission Mandatory Referral #2022M-058ES-001  
Council District #33– Antoinette Lee, Council Member**

On behalf of the Metropolitan Planning Commission, the following item, referred to the Commission as required by the Metro Charter, has been recommended for *approval* to the Metropolitan Council:

*A request for the acceptance of approximately 2,321 linear feet of 8-inch water main (DIP), four fire hydrant assemblies, 2,029 linear feet of 8-inch sanitary sewer main (PVC), 11 sanitary sewer manholes, and any associated easements to serve the Timber Trails Phase 3, requested by Snyder Engineering, Metro Water Services, and Owners.*

The relevant Metro agencies (Metro Parks, Metro Public Works, Metro Water Services, Metro Emergency Communications, the Nashville Electric Service, Metro Finance – Public Property and the Metro Historical Commission) have reviewed the proposal and concur in the recommendation for approval. This request must be approved by the Metro Council to become effective. A sketch showing the location of the request is attached to this letter.

**Conditions that apply to this approval: none**

This recommendation for approval is given as set forth in the Metropolitan Planning Commission Rules and Procedures. If you have any questions about this matter, please contact Delilah Rhodes at [delilah.rhodes@nashville.gov](mailto:delilah.rhodes@nashville.gov) or 615-862-7208.

Sincerely,

A handwritten signature in black ink that reads 'Robert Leeman'.

Robert Leeman  
Deputy Director  
Metro Planning Department  
cc: *Metro Clerk*

**Re: Timber Trails Phase 3  
Planning Commission Mandatory Referral #2022M-058ES-001  
Council District #33– Antoinette Lee, Council Member**

*A request for the acceptance of approximately 2,321 linear feet of 8-inch water main (DIP), four fire hydrant assemblies, 2,029 linear feet of 8-inch sanitary sewer main (PVC), 11 sanitary sewer manholes, and any associated easements to serve the Timber Trails Phase 3, requested by Snyder Engineering, Metro Water Services, and Owners.*

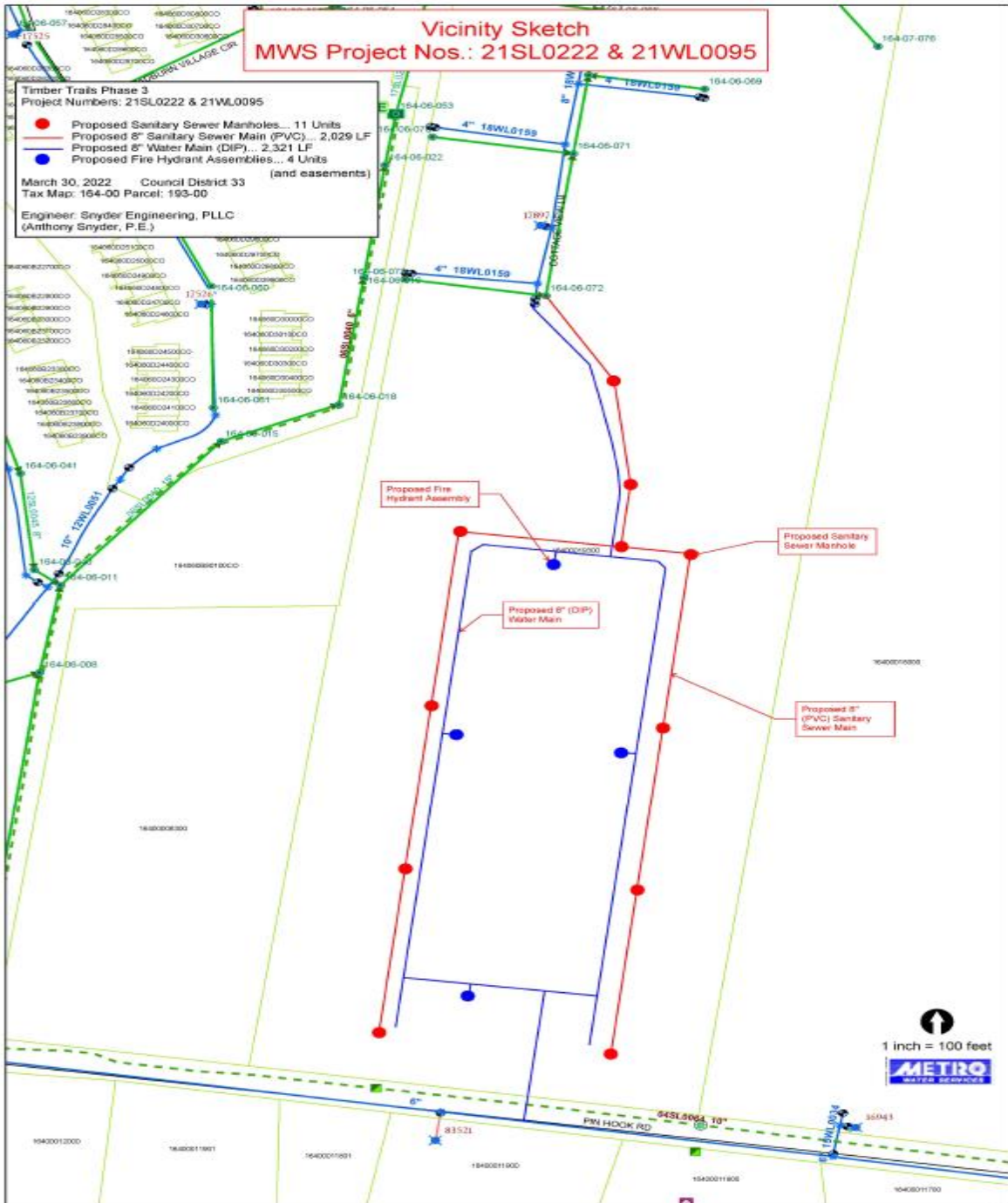

# Vicinity Sketch

## MWS Project Nos.: 21SL0222 & 21WL0095

**Timber Trails Phase 3**  
Project Numbers: 21SL0222 & 21WL0095

- Proposed Sanitary Sewer Manholes... 11 Units
- Proposed 8" Sanitary Sewer Main (PVC)... 2,029 LF
- Proposed 8" Water Main (DIP)... 2,321 LF
- Proposed Fire Hydrant Assemblies... 4 Units

(and easements)

March 30, 2022 Council District 33  
Tax Map: 164-00 Parcel: 193-00

Engineer: Snyder Engineering, PLLC  
(Anthony Snyder, P.E.)

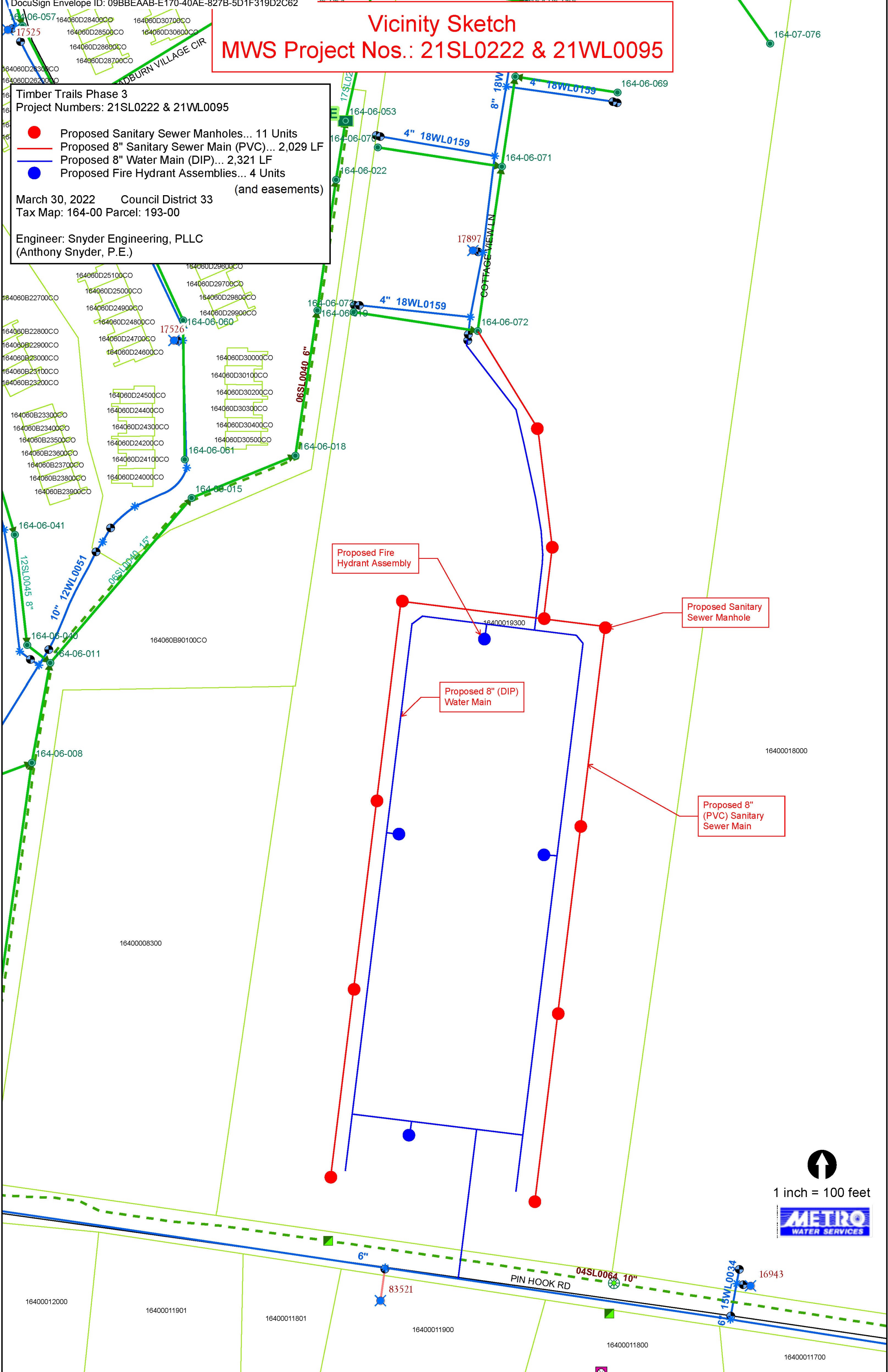

1 inch = 100 feet