

# Vicinity Sketch

## MWS Project No.: 20SL0140

**----- CAUTION -----**  
 THE POSITION OF THE WATER AND SANITARY SEWER MAINS SHOWN ARE APPROXIMATE AND ARE INTENDED TO SHOW THE GENERAL LOCATION ONLY. THE SIZES NOTED ARE TO THE BEST OF MWS KNOWLEDGE. IN ALL CASES WHERE PRECISE LOCATION AND MAIN SIZES ARE REQUIRED, FIELD VERIFICATION WILL BE NECESSARY.

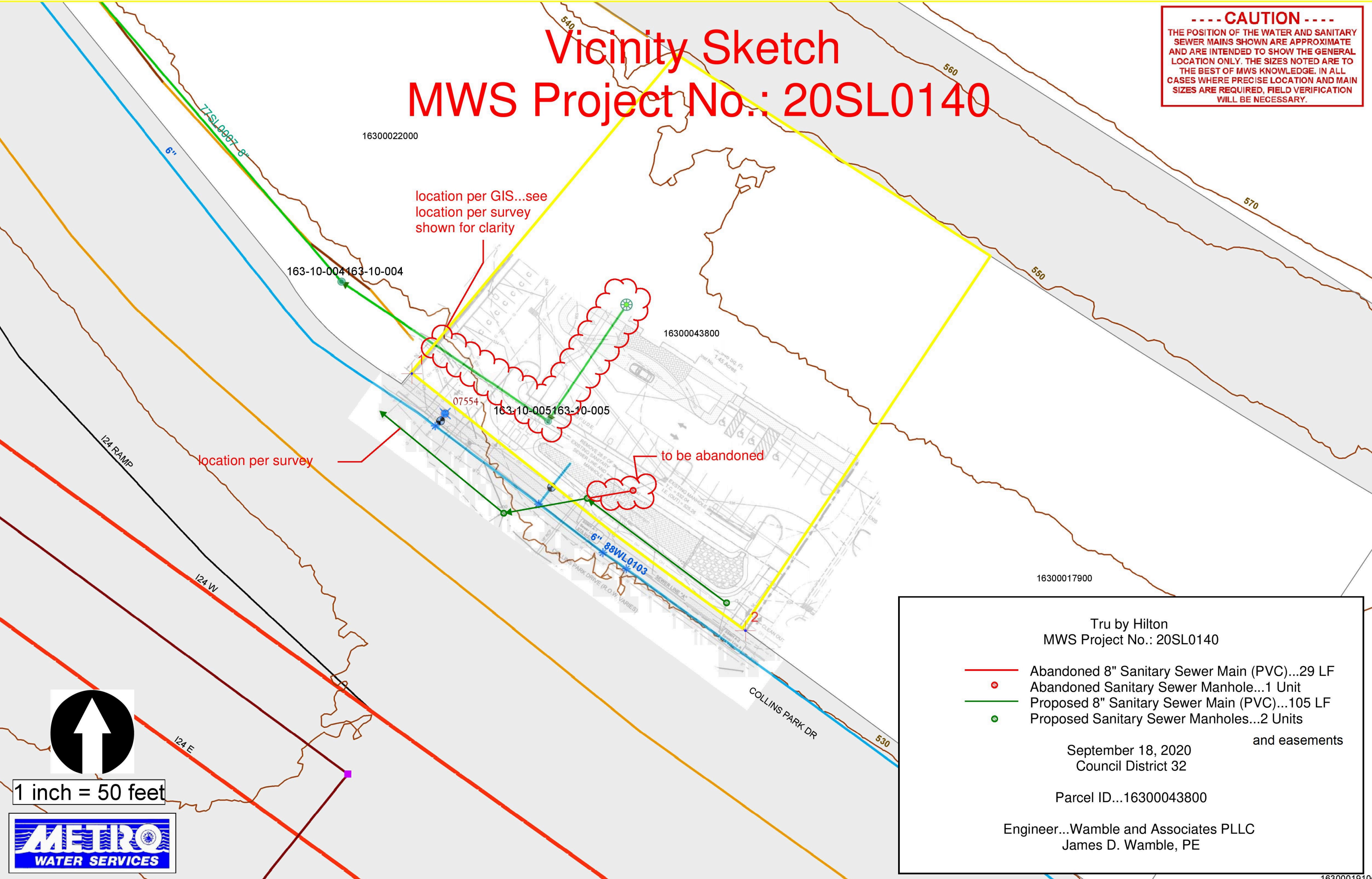

location per GIS...see location per survey shown for clarity

location per survey

to be abandoned

Tru by Hilton  
 MWS Project No.: 20SL0140

- Abandoned 8" Sanitary Sewer Main (PVC)...29 LF
- Abandoned Sanitary Sewer Manhole...1 Unit
- Proposed 8" Sanitary Sewer Main (PVC)...105 LF
- Proposed Sanitary Sewer Manholes...2 Units

and easements

September 18, 2020  
 Council District 32

Parcel ID...16300043800

Engineer...Wamble and Associates PLLC  
 James D. Wamble, PE

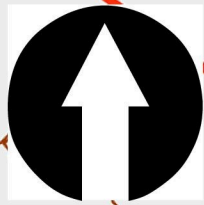

1 inch = 50 feet

