



METROPOLITAN GOVERNMENT OF NASHVILLE

AND DAVIDSON COUNTY

Metro Office Building
800 President Ronald Reagan Way
P.O. Box 196300
Nashville, TN 37219-6300

July 3, 2023

To: Mike Atchison Metro Water Services

Re: **BELWOOD CONDOMINIUMS**
Planning Commission Mandatory Referral 2023M-110ES-001
Council District #21 Brandon Taylor, Council Member

On behalf of the Metropolitan Planning Commission, the following item, referred to the Commission as required by the Metro Charter, has been recommended for *approval* to the Metropolitan Council:

A request for the abandonment of approximately 317 linear feet of 2.25-inch water main and the acceptance of approximately 307 linear feet of 8-inch water main (DIP) and 10 linear feet of 6-inch water main (DIP) to serve the Belwood Condominiums development.

The relevant Metro agencies (Metro Parks, Metro Public Works, Metro Water Services, Metro Emergency Communications, the Nashville Electric Service, Metro Finance – Public Property and the Metro Historical Commission) have reviewed the proposal and concur in the recommendation for approval. This request must be approved by the Metro Council to become effective. A sketch showing the location of the request is attached to this letter.

Conditions that apply to this approval: none

This recommendation for approval is given as set forth in the Metropolitan Planning Commission Rules and Procedures. If you have any questions about this matter, please contact Delilah Rhodes at delilah.rhodes@nashville.gov or 615-862-7208.

Sincerely,

A handwritten signature in blue ink that reads "Lisa Milligan".

Lisa Milligan
Land Development Manager
Metro Planning Department
cc: *Metro Clerk*

Re: BELWOOD CONDOMINIUMS
Planning Commission Mandatory Referral # 2023M-110ES-001
Council District #21 Brandon Taylor, Council Member

A request for the abandonment of approximately 317 linear feet of 2.25-inch water main and the acceptance of approximately 307 linear feet of 8-inch water main (DIP) and 10 linear feet of 6-inch water main (DIP) to serve the Belwood Condominiums development.

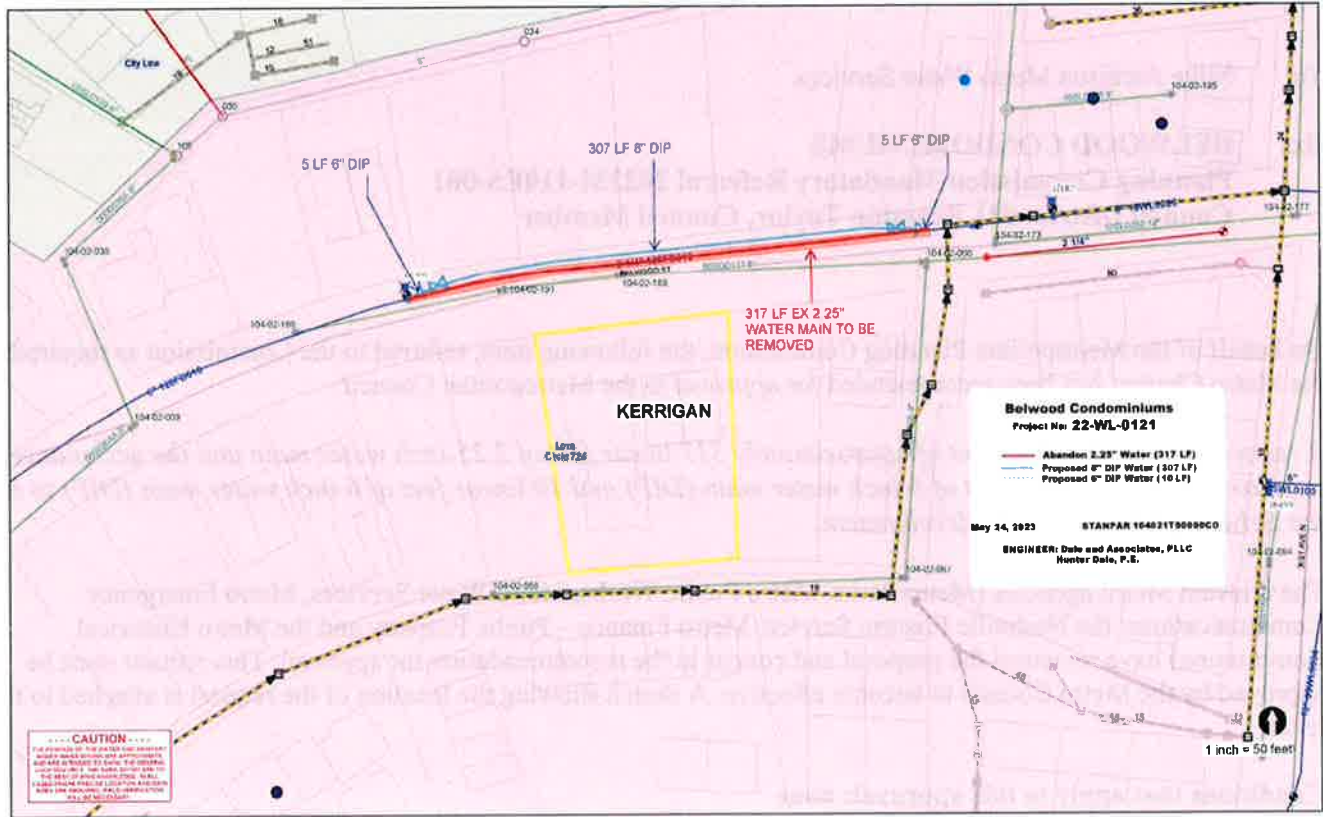

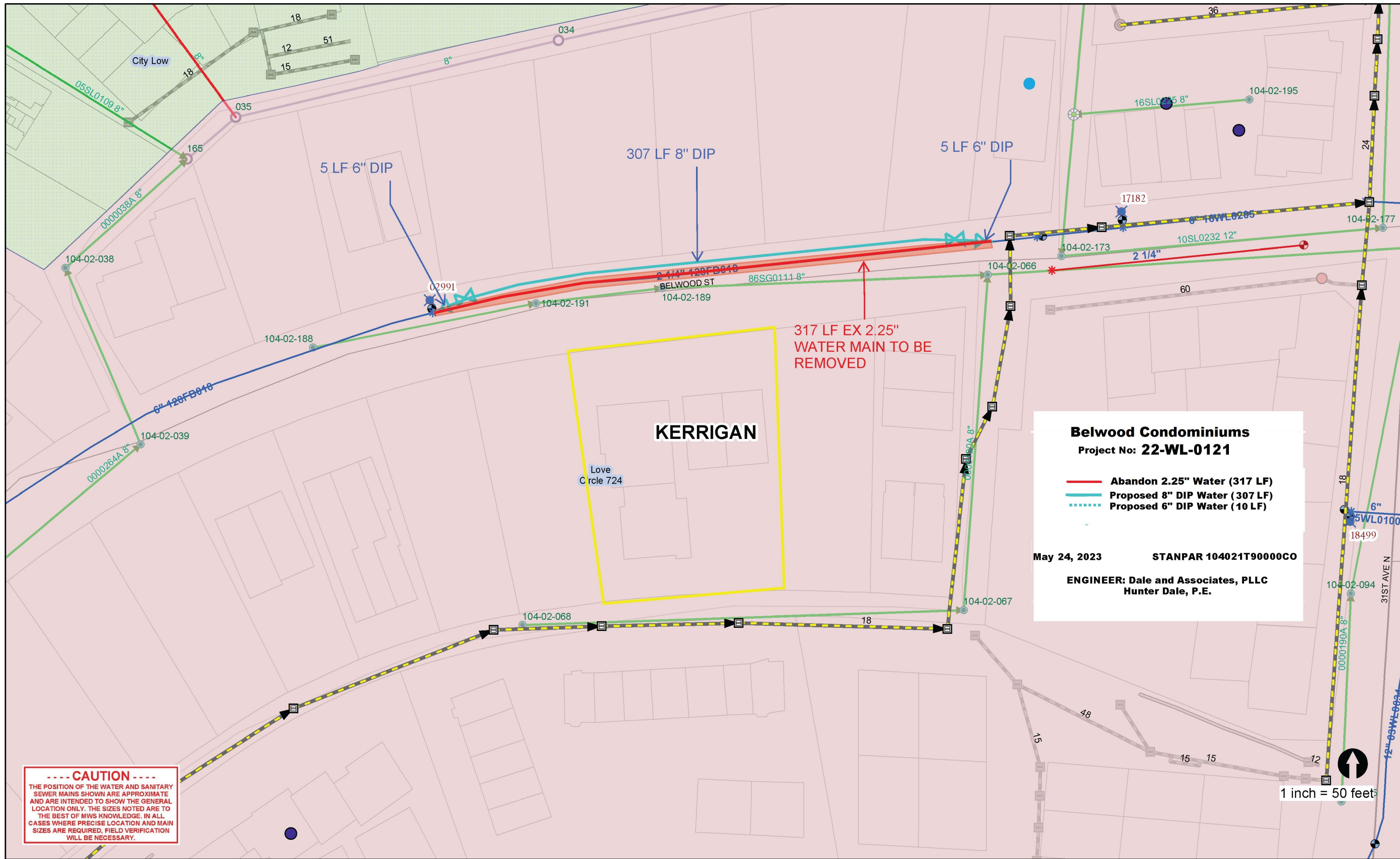

Belwood Condominiums
 Project No: **22-WL-0121**

— **Abandon 2.25" Water (317 LF)**
— **Proposed 8" DIP Water (307 LF)**
- - - **Proposed 6" DIP Water (10 LF)**

May 24, 2023 STANPAR 104021T90000CO
ENGINEER: Dale and Associates, PLLC
 Hunter Dale, P.E.

----- CAUTION -----
 THE POSITION OF THE WATER AND SANITARY SEWER MAINS SHOWN ARE APPROXIMATE AND ARE INTENDED TO SHOW THE GENERAL LOCATION ONLY. THE SIZES NOTED ARE TO THE BEST OF MWS KNOWLEDGE. IN ALL CASES WHERE PRECISE LOCATION AND MAIN SIZES ARE REQUIRED, FIELD VERIFICATION WILL BE NECESSARY.

1 inch = 50 feet