



**METROPOLITAN GOVERNMENT
OF NASHVILLE AND DAVIDSON COUNTY**

Planning Department
Metro Office Building
800 Second Avenue South
Nashville, Tennessee 37201

March 28, 2022

To: Mike Atchison, Metro Water Services

**Re: KROGER U-502 - FIRE HYDRANT RELOCATION
Planning Commission Mandatory Referral #2022M-048ES-001
Council District #19– Freddie O’Connell, Council Member**

On behalf of the Metropolitan Planning Commission, the following item, referred to the Commission as required by the Metro Charter, has been recommended for *approval* to the Metropolitan Council:

A request for the relocation of one fire hydrant assembly to serve the Kroger U-502 development.

The relevant Metro agencies (Metro Parks, Metro Public Works, Metro Water Services, Metro Emergency Communications, the Nashville Electric Service, Metro Finance – Public Property and the Metro Historical Commission) have reviewed the proposal and concur in the recommendation for approval. This request must be approved by the Metro Council to become effective. A sketch showing the location of the request is attached to this letter.

Conditions that apply to this approval: none

This recommendation for approval is given as set forth in the Metropolitan Planning Commission Rules and Procedures. If you have any questions about this matter, please contact Delilah Rhodes at Delilah.rhodes@nashville.gov or 615-862-7208.

Sincerely,

A handwritten signature in cursive script that reads "Robert Leeman".

Robert Leeman
Deputy Director
Metro Planning Department
cc: *Metro Clerk*

Re: KROGER U-502 - FIRE HYDRANT RELOCATION
Planning Commission Mandatory Referral #2022M-048ES-001
Council District #19- Freddie O'Connell, Council Member

A request for the relocation of one fire hydrant assembly to serve the Kroger U-502 development.

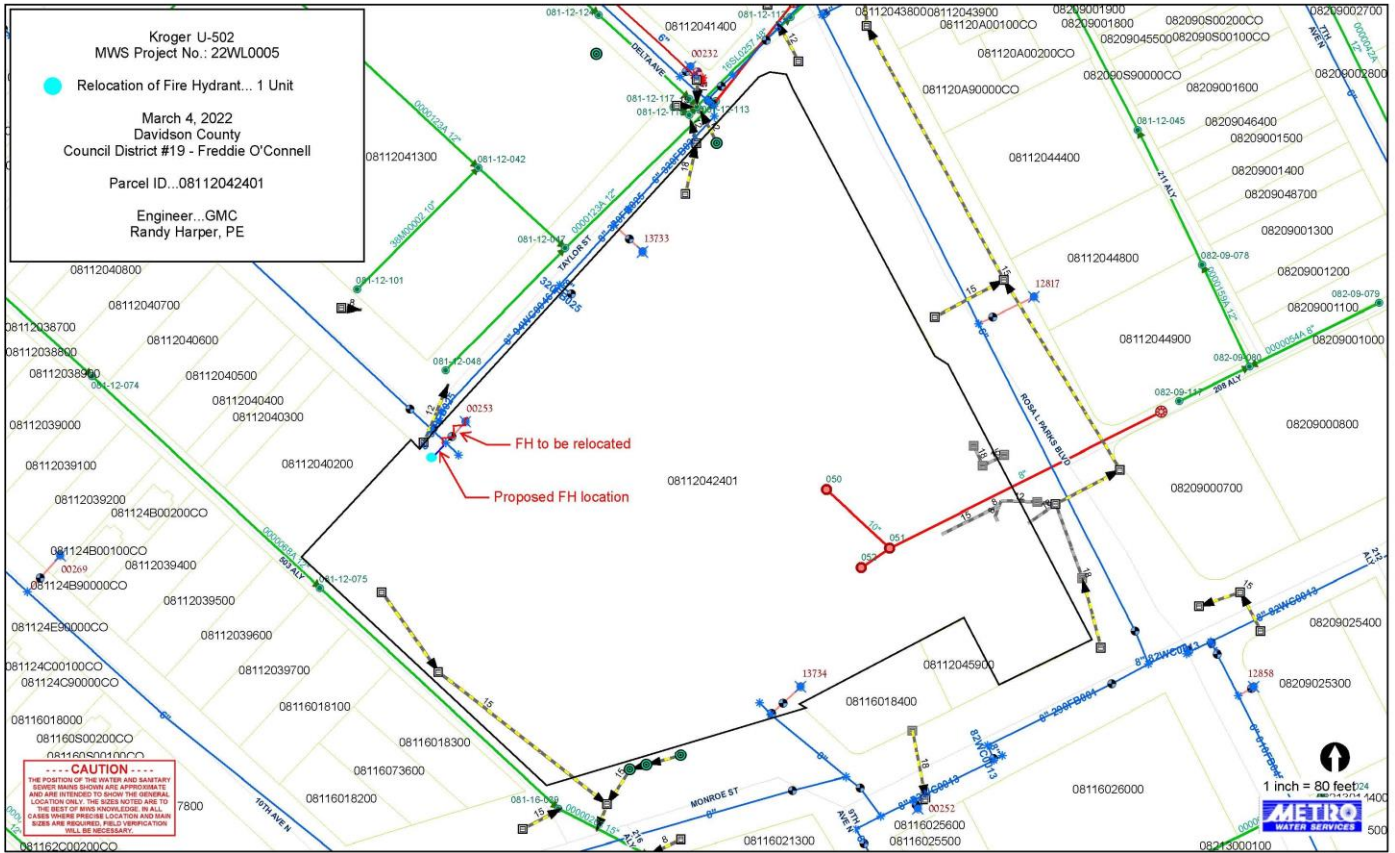

Kroger U-502
 MWS Project No.: 22WL0005

● Relocation of Fire Hydrant... 1 Unit

March 4, 2022
 Davidson County
 Council District #19 - Freddie O'Connell

Parcel ID...08112042401

Engineer...GMC
 Randy Harper, PE

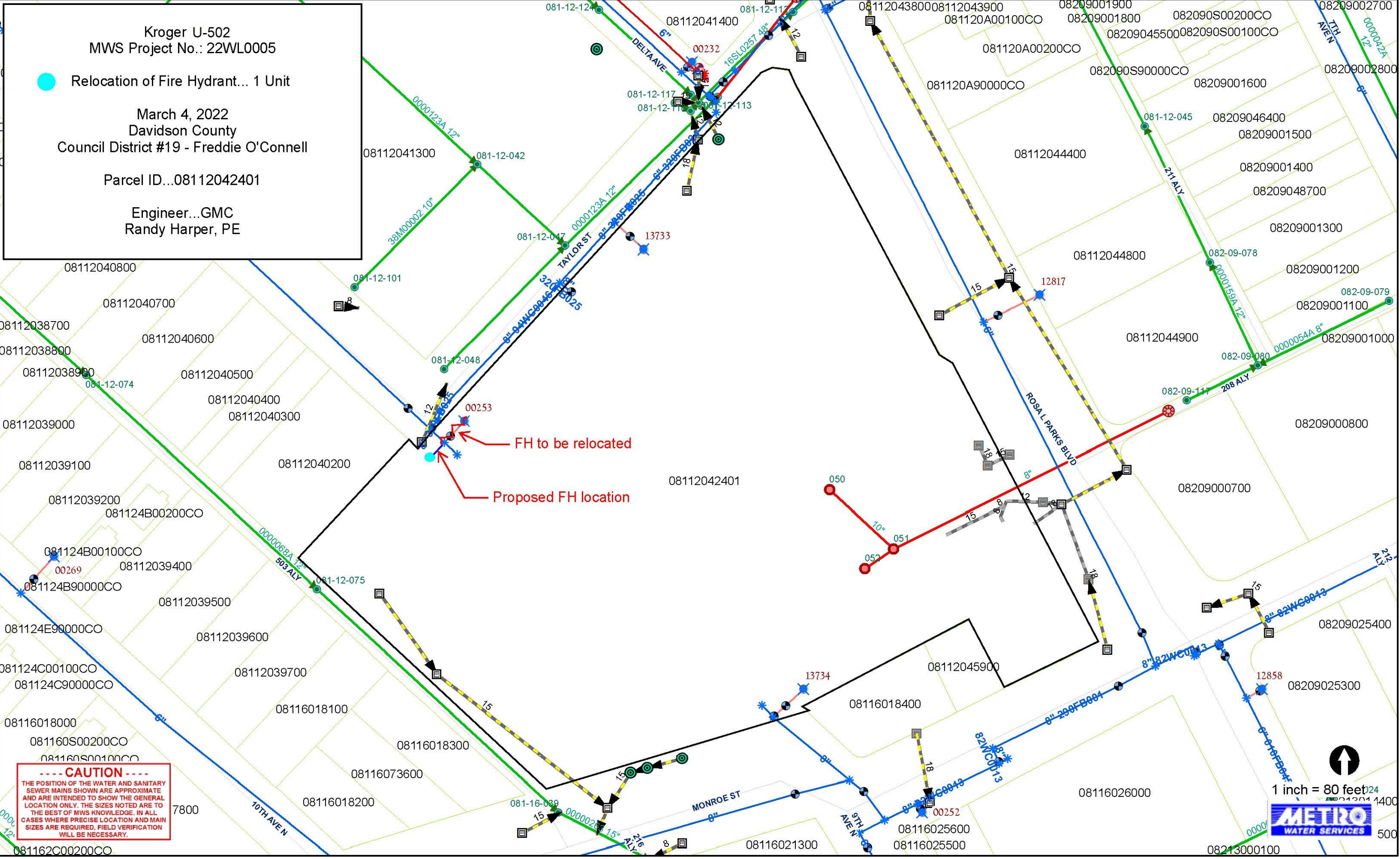

----- CAUTION -----
 THE POSITION OF THE WATER AND SANITARY SEWER MAINS SHOWN ARE APPROXIMATE AND ARE INTENDED TO SHOW THE GENERAL LOCATION ONLY. THE SIZES NOTED ARE TO THE BEST OF MWS KNOWLEDGE. IN ALL CASES WHERE PRECISE LOCATION AND MAIN SIZES ARE REQUIRED, FIELD VERIFICATION WILL BE NECESSARY.

1 inch = 80 feet
METRO
 WATER SERVICES