



**METROPOLITAN GOVERNMENT OF NASHVILLE
AND DAVIDSON COUNTY**

Metro Office Building
800 President Ronald Reagan Way
P.O. Box 196300
Nashville, TN 37219-6300

July 12, 2023

To: Mike Atchison Metro Water Services

**Re: CANEBRAKE SUBDIVISION - PHASE 1A
Planning Commission Mandatory Referral 2023M-112ES-001**

On behalf of the Metropolitan Planning Commission, the following item, referred to the Commission as required by the Metro Charter, has been recommended for *approval* to the Metropolitan Council:

A request or the acceptance of approximately 1,365 linear feet of eight-inch sanitary sewer main (DIP), 1,801 linear feet of eight-inch sanitary sewer main (PVC), 22 sanitary sewer manholes, and associated easements to serve Phase 1A of the Canebrake Subdivision development.

The relevant Metro agencies (Metro Parks, Metro Public Works, Metro Water Services, Metro Emergency Communications, the Nashville Electric Service, Metro Finance – Public Property and the Metro Historical Commission) have reviewed the proposal and concur in the recommendation for approval. This request must be approved by the Metro Council to become effective. A sketch showing the location of the request is attached to this letter.

Conditions that apply to this approval: none

This recommendation for approval is given as set forth in the Metropolitan Planning Commission Rules and Procedures. If you have any questions about this matter, please contact Delilah Rhodes at delilah.rhodes@nashville.gov or 615-862-7208.

Sincerely,

A handwritten signature in blue ink, appearing to read 'Lisa Milligan', written over a circular stamp.

Lisa Milligan
Land Development Manager
Metro Planning Department
cc: *Metro Clerk*

**Re: CANEBRAKE SUBDIVISION - PHASE 1A
Planning Commission Mandatory Referral # 2023M-112ES-001**

A request for the acceptance of approximately 1,365 linear feet of eight-inch sanitary sewer main (DIP), 1,801 linear feet of eight-inch sanitary sewer main (PVC), 22 sanitary sewer manholes, and associated easements to serve Phase 1A of the Canebrake Subdivision development.

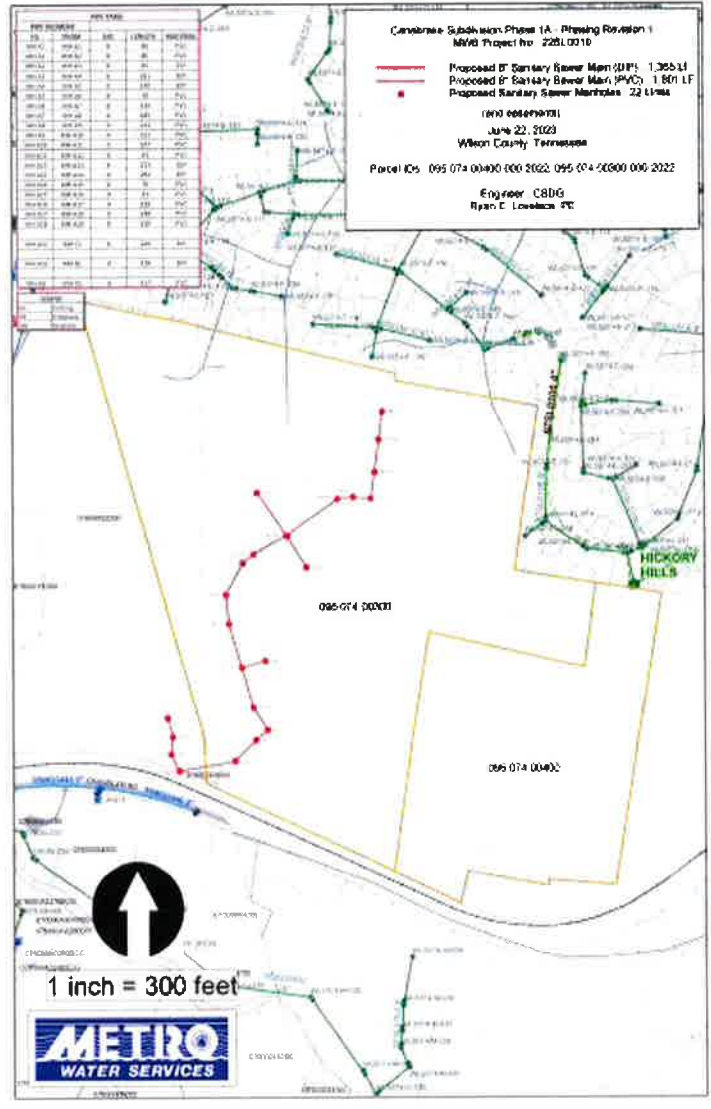

PIPE TABLE				
PIPE SEGMENT TO	FROM	SIZE	LENGTH	MATERIAL
MH K7	MH A1	8	88	PVC
MH A1	MH A2	8	80	PVC
MH A2	MH A3	8	85	DIP
MH A3	MH A4	8	261	DIP
MH A4	MH A5	8	140	DIP
MH A5	MH A6	8	70	PVC
MH A6	MH A7	8	126	PVC
MH A7	MH A8	8	189	PVC
MH A8	MH A9	8	214	PVC
MH A9	MH A10	8	132	PVC
MH A10	MH A11	8	167	PVC
MH A11	MH A12	8	63	PVC
MH A12	MH A13	8	173	DIP
MH A13	MH A14	8	292	DIP
MH A14	MH A15	8	70	PVC
MH A15	MH A16	8	83	PVC
MH A16	MH A17	8	126	PVC
MH A17	MH A18	8	146	PVC
MH A18	MH A19	8	130	PVC
MH A13	MH C1	8	236	DIP
MH A13	MH B1	8	178	DIP
MH A8	MH D1	8	117	PVC

LEGEND	
EX	Existing
PR	Proposed
MH	Mnahole

Canebrake Subdivision Phase 1A - Phasing Revision 1
MWS Project No.: 22SL0019

— Proposed 8" Sanitary Sewer Main (DIP)...1,365 LF
— Proposed 8" Sanitary Sewer Main (PVC)...1,801 LF
● Proposed Sanitary Sewer Manholes...22 Units

(and easements)
June 22, 2023
Wilson County, Tennessee

Parcel IDs...095 074 00400 000 2022, 095 074 00300 000 2022

Engineer...CSDG
Ryan E. Lovelace, PE

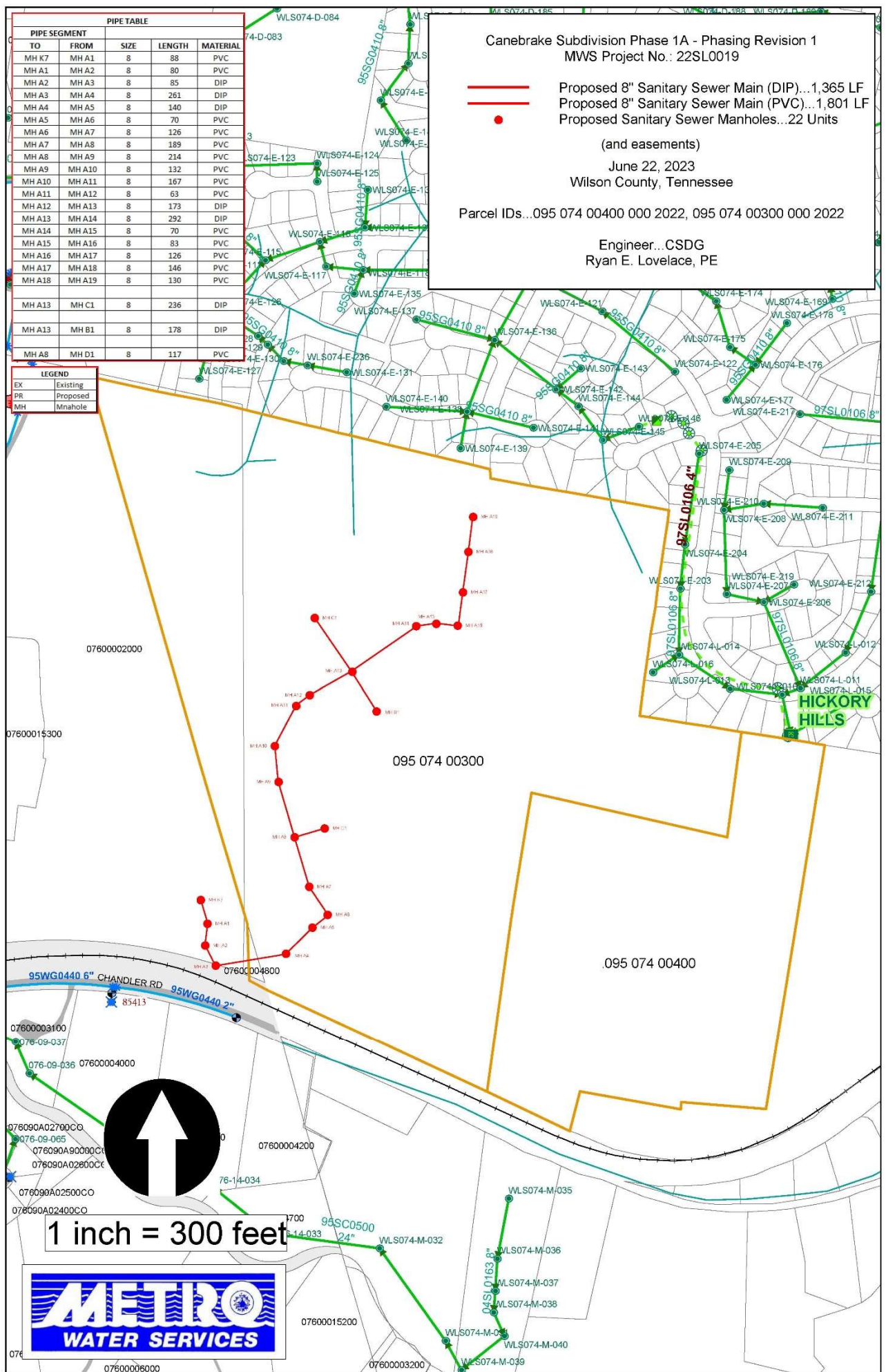

1 inch = 300 feet

