

N A S H V I L L E
P L A N N I N G

March 20, 2024

To: Stephanie James Metro Water Services

Re: **6501 Pennywell Drive**
Planning Commission Mandatory Referral 2024M-044ES-001
Council District #23 Thom Druffel, Council Member

On behalf of the Metropolitan Planning Commission, the following item, referred to the Commission as required by the Metro Charter, has been recommended for *approval* to the Metropolitan Council:

A request for the acceptance approximately 140 linear feet of eight-inch water main (DIP) to serve the development at 6501 Pennywell Drive.

The relevant Metro agencies (Metro Parks, Nashville Department of Transportation, Metro Water Services, Metro Emergency Communications, the Nashville Electric Service, Metro Finance – Public Property and the Metro Historical Commission) have reviewed the proposal and concur in the recommendation for approval. This request must be approved by the Metro Council to become effective. A sketch showing the location of the request is attached to this letter.

Conditions that apply to this approval: none

This recommendation for approval is given as set forth in the Metropolitan Planning Commission Rules and Procedures. If you have any questions about this matter, please contact Delilah Rhodes at Delilah.Rhodes@nashville.gov or 615-862-7208

Sincerely,



Lisa Milligan
Assistant Director Land Development
Metro Planning Department
cc: *Metro Clerk*

**Re: 6501 Pennywell Drive
Planning Commission Mandatory Referral 2024M-044ES-001
Council District #23 Thom Druffel, Council Member**

A request for the acceptance approximately 140 linear feet of eight-inch water main (DIP) to serve the development at 6501 Pennywell Drive.



6501 Pennywell Drive
23WL0084
Proposed Water Main
Davidson County, TN
Council District 23

Proposed 8-Inch Water Main (DIP)...140 LF

Map 115-06, Parcel 360
December 19, 2023
Dale and Associates, PLLC
(Michael Garrigan, P.E.)

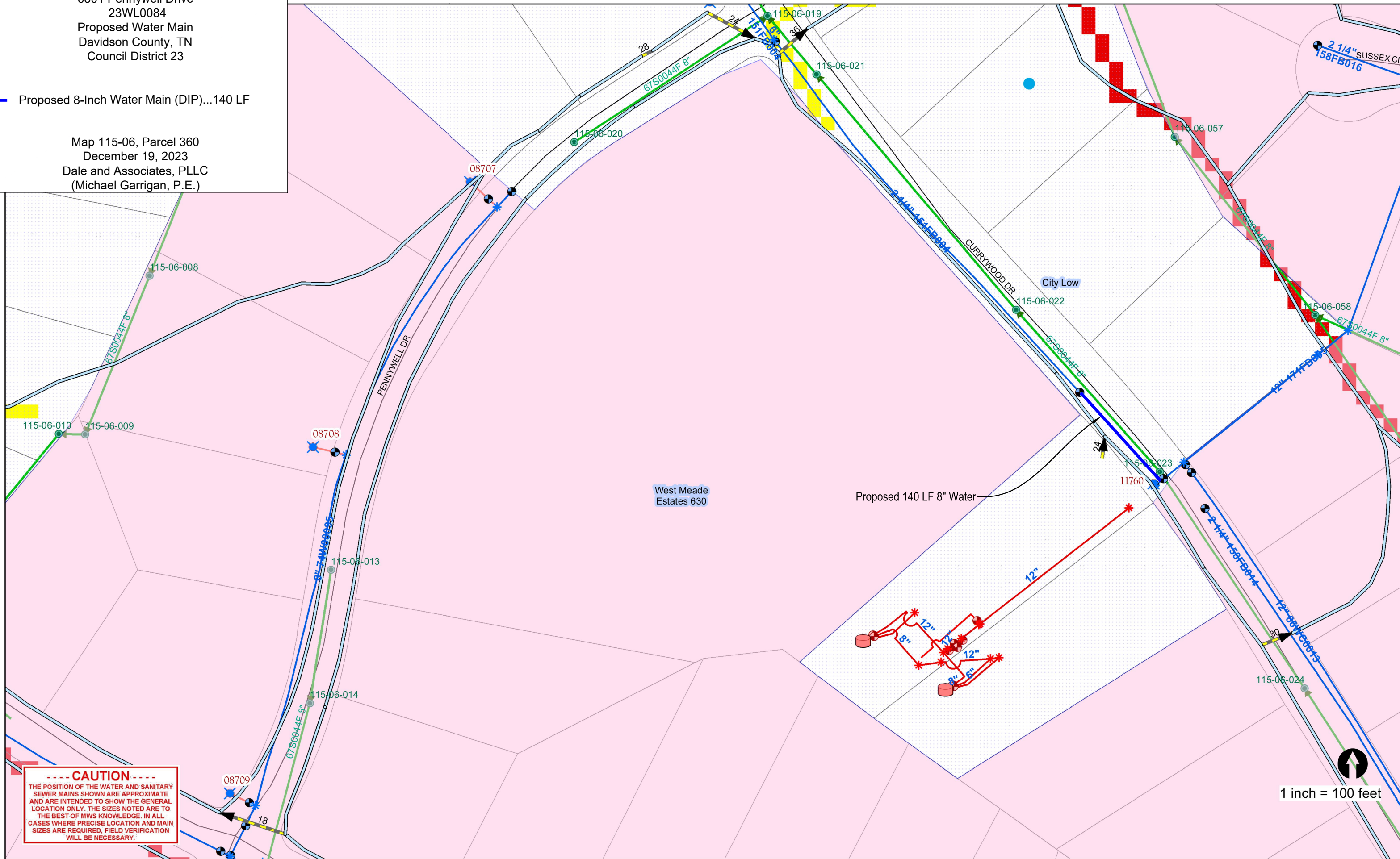

----- CAUTION -----
THE POSITION OF THE WATER AND SANITARY SEWER MAINS SHOWN ARE APPROXIMATE AND ARE INTENDED TO SHOW THE GENERAL LOCATION ONLY. THE SIZES NOTED ARE TO THE BEST OF MWS KNOWLEDGE. IN ALL CASES WHERE PRECISE LOCATION AND MAIN SIZES ARE REQUIRED, FIELD VERIFICATION WILL BE NECESSARY.

1 inch = 100 feet