



PIPE TABLE

TO	FROM	SIZE	LENGTH	MATERIAL
MH C1	MH C2	8	172	DIP
MH C2	MH C3	8	176	DIP
MH M1	MH M2	8	83	PVC
MH M2	MH M3	8	135	PVC
MH F1	MH F2	8	311	PVC
MH F2	MH F3	8	124	PVC
MH F3	MH F4	8	245	PVC
MH F4	MH F5	8	184	PVC
MH F4	MH G1	8	268	PVC
MH A4	MH J1	8	66	PVC
MH J1	MH J2	8	279	PVC
MH J2	MH J3	8	127	DIP
MH J3	MH J4	8	151	DIP
MH J4	MH J5	8	254	DIP
MH J5	MH J6	8	109	PVC

Canebrake Subdivision Phase 2A
MWS Project No.: 23SL0141

-  Proposed 8" Sanitary Sewer Main (PVC)...1,804LF and Associated Easements
-  Proposed 8" Sanitary Sewer Main (DIP)...880 LF and Associated Easements
-  Proposed Sanitary Sewer Manholes...15 Units and Associated Easements

May 31, 2024
Wilson County, Tennessee

Parcel IDs...095 074 00400 000 2022, 095 074 00300 000 2022

Engineer...CSDG
Ryan E. Lovelace, PE

LEGEND	
EX	Existing
PR	Proposed
MH	Manhole

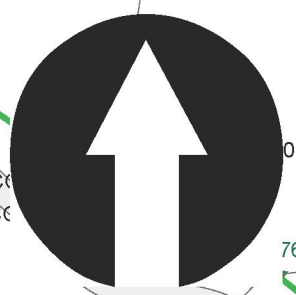
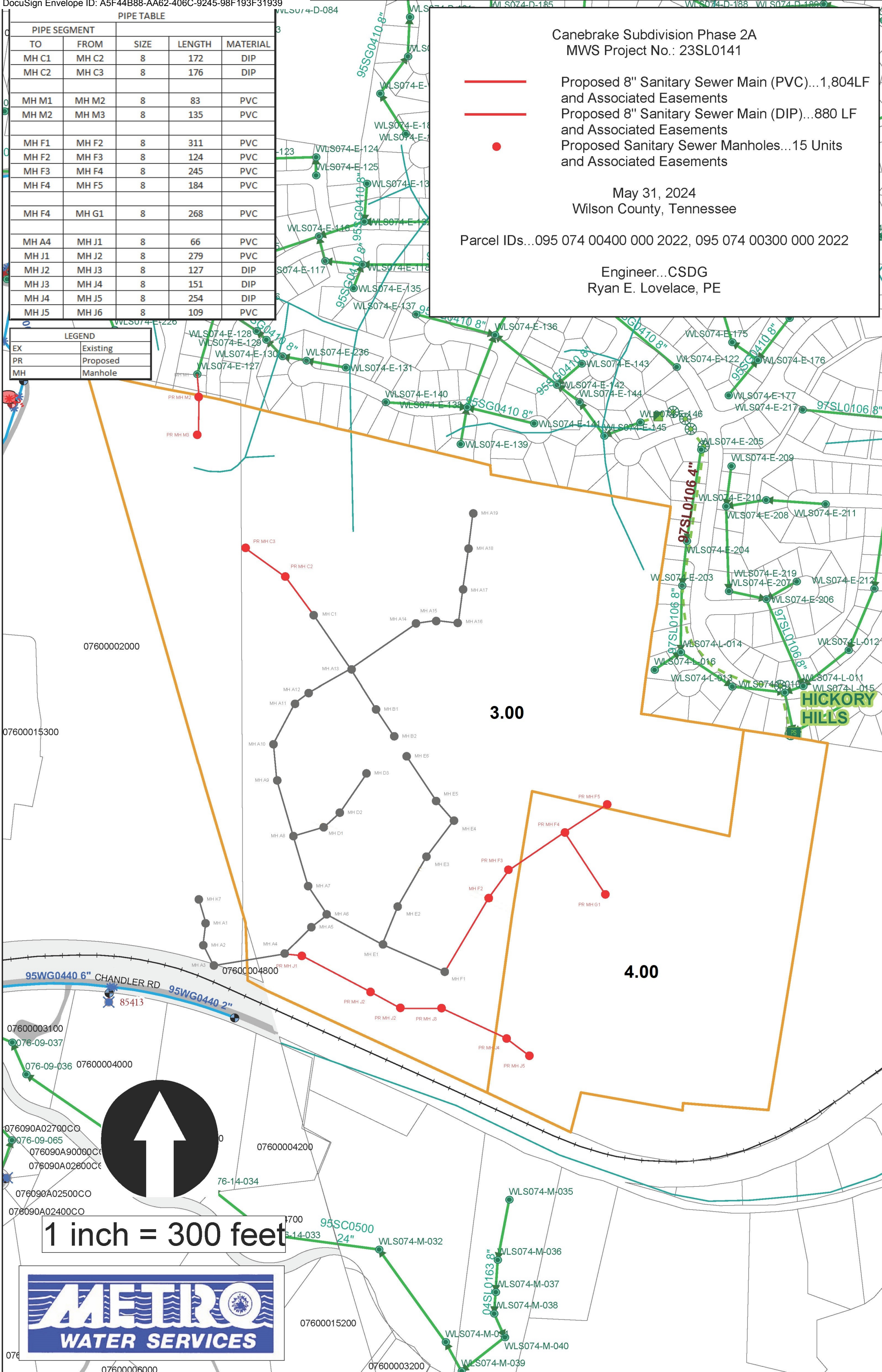

1 inch = 300 feet



HICKORY HILLS



June 14, 2024

To: Mike Atchison Metro Water Services

Re: **Canebrake Subdivision Phase 2A
Planning Commission Mandatory Referral 2024M-081ES-001**

On behalf of the Metropolitan Planning Commission, the following item, referred to the Commission as required by the Metro Charter, has been recommended for *approval* to the Metropolitan Council:

A request for the acceptance of approximately 1,804 linear feet of eight-inch sanitary sewer mains (PVC), approximately 880 linear feet of eight-inch sanitary sewer mains (DIP), 15 sanitary sewer manholes and easements to serve the Canebrake Subdivision Phase 2A development.

The relevant Metro agencies (Metro Parks, Nashville Department of Transportation, Metro Water Services, Metro Emergency Communications, the Nashville Electric Service, Metro Finance – Public Property and the Metro Historical Commission) have reviewed the proposal and concur in the recommendation for approval. This request must be approved by the Metro Council to become effective. A sketch showing the location of the request is attached to this letter.

Conditions that apply to this approval: none

This recommendation for approval is given as set forth in the Metropolitan Planning Commission Rules and Procedures. If you have any questions about this matter, please contact Delilah Rhodes at Delilah.Rhodes@nashville.gov or 615-862-7208

Sincerely,

A handwritten signature in blue ink that reads "Lisa Milligan".

Lisa Milligan
Assistant Director Land Development
Metro Planning Department
cc: *Metro Clerk*

**Re: Canebrake Subdivision Phase 2A
Planning Commission Mandatory Referral 2024M-081ES-001**

A request for the acceptance of approximately 1,804 linear feet of eight-inch sanitary sewer mains (PVC), approximately 880 linear feet of eight-inch sanitary sewer mains (DIP), 15 sanitary sewer manholes and easements to serve the Canebrake Subdivision Phase 2A development.

