



**METROPOLITAN GOVERNMENT
OF NASHVILLE AND DAVIDSON COUNTY**

Planning Department
Metro Office Building
800 Second Avenue South
Nashville, Tennessee 37201

December 22, 2021

To: Mike Atchison, Metro Water Services

Re: BluePearl Vet Development
Planning Commission Mandatory Referral #2022M-007ES-001
Council District #18 – Tom Cash, Council Member

On behalf of the Metropolitan Planning Commission, the following item, referred to the Commission as required by the Metro Charter, has been recommended for *approval* to the Metropolitan Council:

A request for the abandonment of approximately 120 linear feet of 8-inch clay sanitary sewer main, the acceptance of 120 linear feet of 8-inch sanitary sewer main (DIP), and the vertical casting adjustment of two sanitary sewer manholes to serve the BluePearl Vet development (see sketch for details).

The relevant Metro agencies (Metro Parks, Metro Public Works, Metro Water Services, Metro Emergency Communications, the Nashville Electric Service, Metro Finance – Public Property and the Metro Historical Commission) have reviewed the proposal and concur in the recommendation for approval. This request must be approved by the Metro Council to become effective. A sketch showing the location of the request is attached to this letter.

Conditions that apply to this approval: None.

This recommendation for approval is given as set forth in the Metropolitan Planning Commission Rules and Procedures. If you have any questions about this matter, please contact Michelle Hollingsworth at michelle.hollingsworth@nashville.gov or 615-862-7197.

Sincerely,

A handwritten signature in black ink that reads "Robert Leeman".

Robert Leeman
Deputy Director
Metro Planning Department
cc: *Metro Clerk, Elizabeth Waites*

Re: BluePearl Vet Development
Planning Commission Mandatory Referral #2022M-007ES-001
Council District #18 – Tom Cash, Council Member

A request for the abandonment of approximately 120 linear feet of 8-inch clay sanitary sewer main, the acceptance of 120 linear feet of 8-inch sanitary sewer main (DIP), and the vertical casting adjustment of two sanitary sewer manholes to serve the BluePearl Vet development (see sketch for details).

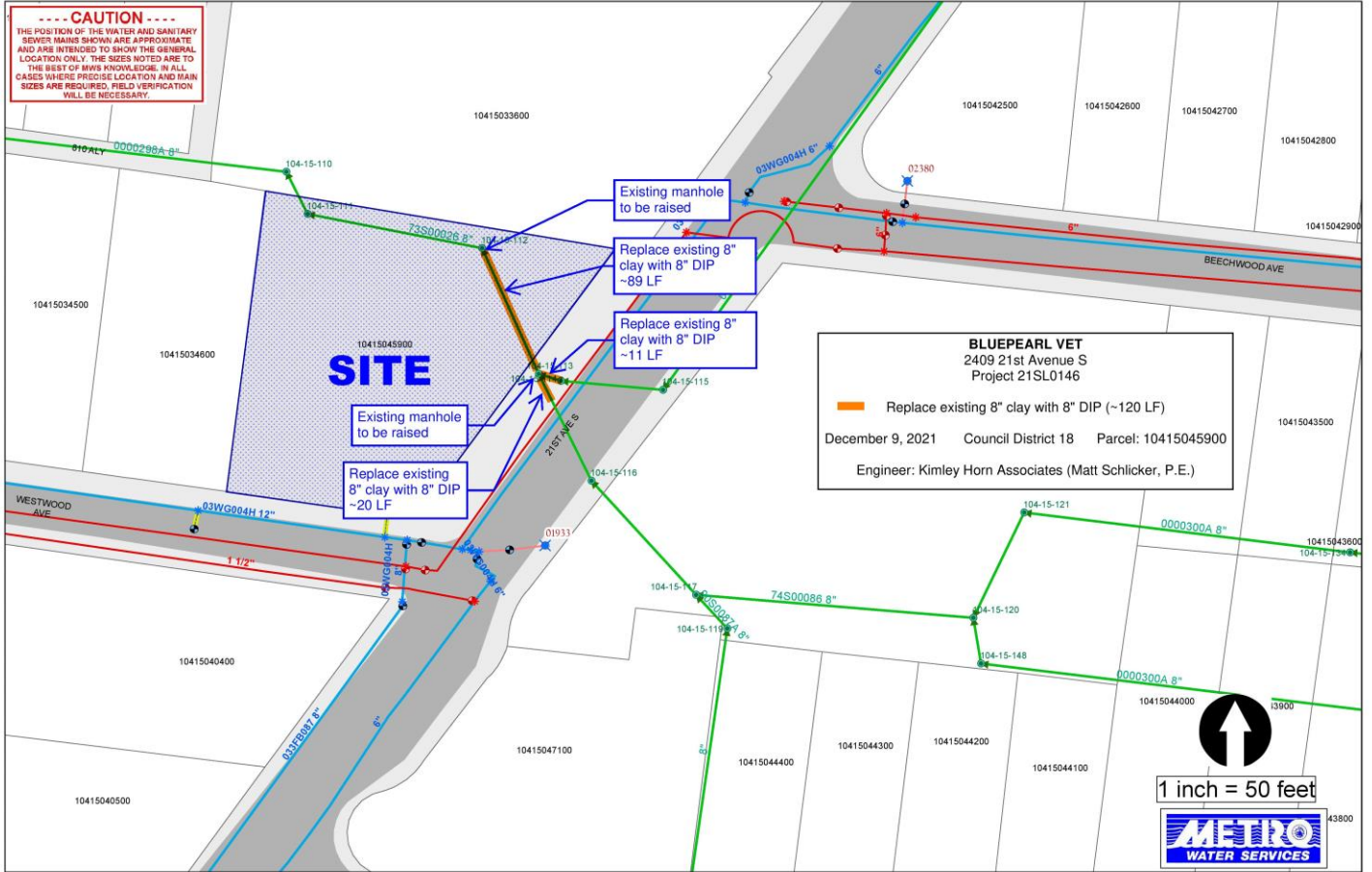

-----CAUTION-----
THE POSITION OF THE WATER AND SANITARY SEWER MAINS SHOWN ARE APPROXIMATE AND ARE INTENDED TO SHOW THE GENERAL LOCATION ONLY. THE SIZES NOTED ARE TO THE BEST OF RWIS KNOWLEDGE. IN ALL CASES WHERE PRECISE LOCATION AND MAIN SIZES ARE REQUIRED, FIELD VERIFICATION WILL BE NECESSARY.

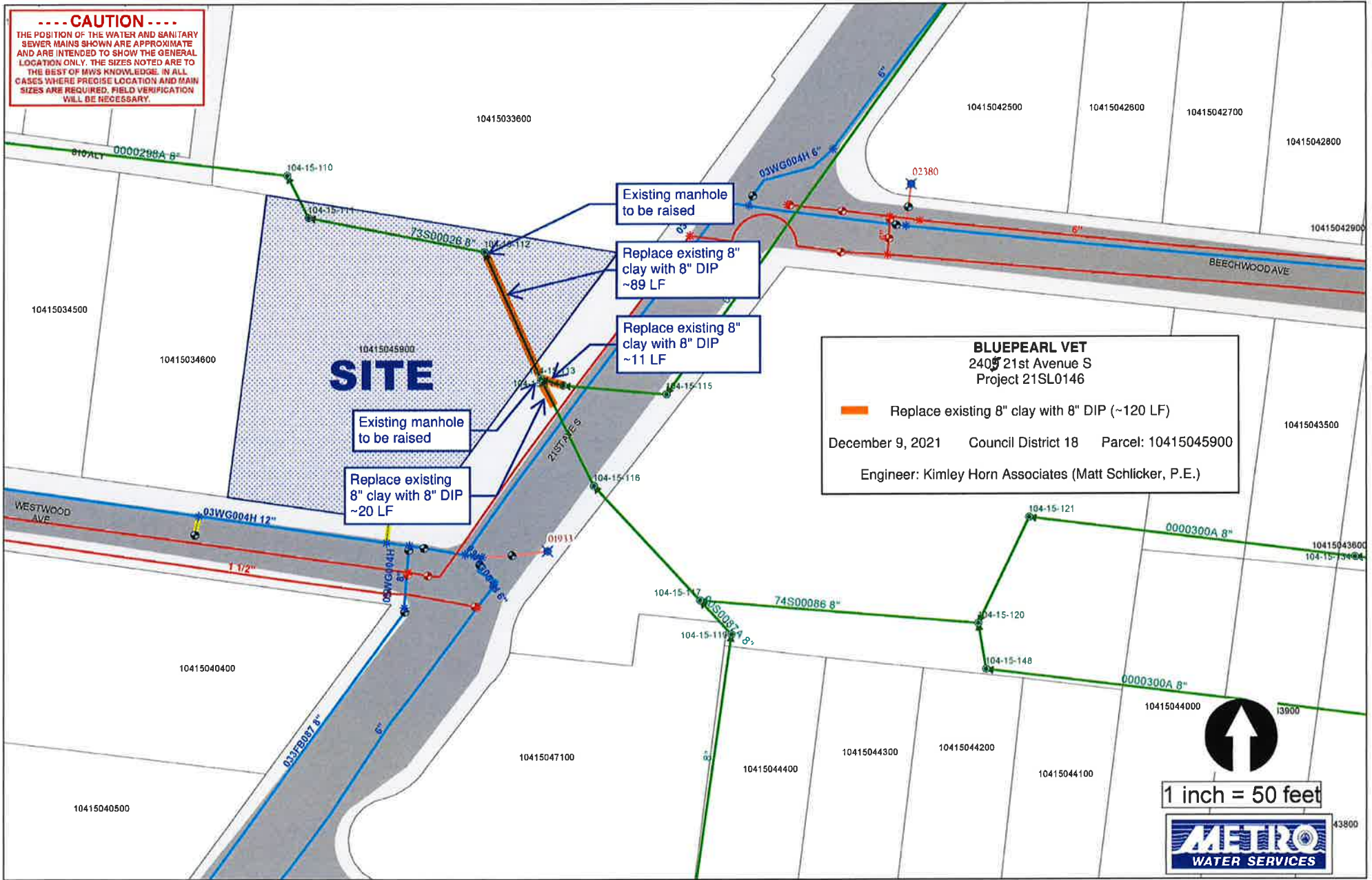

Existing manhole to be raised

Replace existing 8" clay with 8" DIP ~89 LF

Replace existing 8" clay with 8" DIP ~11 LF

Existing manhole to be raised

Replace existing 8" clay with 8" DIP ~20 LF

BLUEPEARL VET
2405 21st Avenue S
Project 21SL0146

December 9, 2021 Council District 18 Parcel: 10415045900
Engineer: Kimley Horn Associates (Matt Schlicker, P.E.)

1 inch = 50 feet

METRO
WATER SERVICES