

PIPE TABLE				
TO	FROM	SIZE	LENGTH	MATERIAL
MH A6	MH E1	8	227	PVC
MH E1	MH E2	8	151	PVC
MH E2	MH E3	8	208	PVC
MH E3	MH E4	8	161	PVC
MH E4	MH E5	8	96	PVC
MH E5	MH E6	8	194	PVC
MH E1	MH F1	8	248	PVC
MH B1	MH B2	8	113	PVC
MH D1	MH D2	8	76	PVC
MH D2	MH D3	8	174	PVC

LEGEND	
EX	Existing
PR	Proposed
MH	Manhole

Canebrake Subdivision Phase 1B - Phasing Revision 2  
 MWS Project No.: 22SL0287

Proposed 8" Sanitary Sewer Main (PVC)...1,648 LF  
 and Associated Easements  
 Proposed Sanitary Sewer Manholes...10 Units

June 3, 2024  
 Wilson County, Tennessee

Parcel IDs...095 074 00400 000 2022, 095 074 00300 000 2022

Engineer...CSDG  
 Ryan E. Lovelace, PE

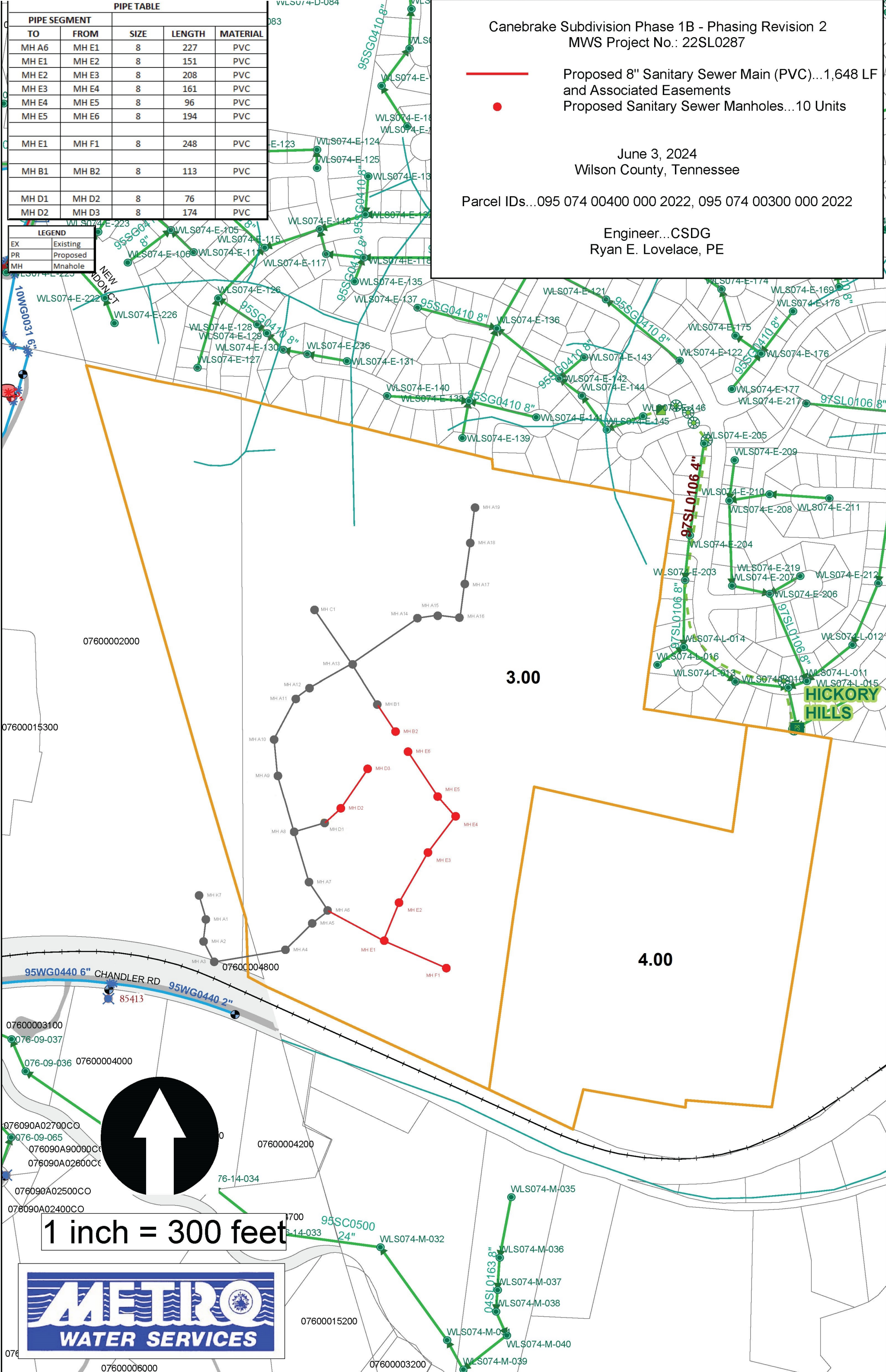

07600002000

3.00

4.00

HICKORY HILLS

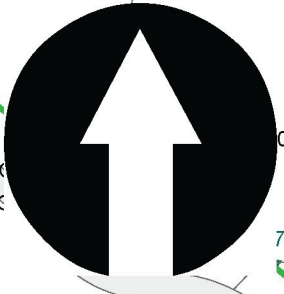

1 inch = 300 feet





June 14, 2024

To: Mike Atchison Metro Water Services

Re: **Canebrake Subdivision Phase 1B, Revision 2 (Amendment)**  
**Planning Commission Mandatory Referral 2023M-113ES-002**

On behalf of the Metropolitan Planning Commission, the following item, referred to the Commission as required by the Metro Charter, has been recommended for *approval* to the Metropolitan Council:

*A request to amend Council ordinance BL2023-16 and Proposal No. 2023M-113ES-001 for the purpose of accepting an additional 248 linear feet of eight-inch sanitary sewer main (PVC), one additional sanitary sewer manhole, and the associated easement. Specific infrastructure instead now will be the acceptance of approximately 1,648 linear feet of eight-inch sanitary sewer mains (PVC), 10 sanitary sewer manholes and easements to serve the Canebrake Subdivision Phase 1B, Revision 2 development.*

The relevant Metro agencies (Metro Parks, Nashville Department of Transportation, Metro Water Services, Metro Emergency Communications, the Nashville Electric Service, Metro Finance – Public Property and the Metro Historical Commission) have reviewed the proposal and concur in the recommendation for approval. This request must be approved by the Metro Council to become effective. A sketch showing the location of the request is attached to this letter.

**Conditions that apply to this approval: none**

This recommendation for approval is given as set forth in the Metropolitan Planning Commission Rules and Procedures. If you have any questions about this matter, please contact Delilah Rhodes at [Delilah.Rhodes@nashville.gov](mailto:Delilah.Rhodes@nashville.gov) or 615-862-7208

Sincerely,

A handwritten signature in blue ink that reads "Lisa Milligan".

Lisa Milligan  
Assistant Director Land Development  
Metro Planning Department  
cc: *Metro Clerk*



**Re: Canebrake Subdivision Phase 1B, Revision 2 (Amendment)  
 Planning Commission Mandatory Referral 2023M-113ES-002**

*A request to amend Council ordinance BL2023-16 and Proposal No. 2023M-113ES-001 for the purpose of accepting an additional 248 linear feet of eight-inch sanitary sewer main (PVC), one additional sanitary sewer manhole, and the associated easement. Specific infrastructure instead now will be the acceptance of approximately 1,648 linear feet of eight-inch sanitary sewer mains (PVC), 10 sanitary sewer manholes and easements to serve the Canebrake Subdivision Phase 1B, Revision 2 development.*

