



**METROPOLITAN GOVERNMENT OF NASHVILLE
AND DAVIDSON COUNTY**

Metro Office Building
800 President Ronald Reagan Way
P.O. Box 196300
Nashville, TN 37219-6300

August 9, 2023

To: Mike Atchison Metro Water Services

**Re: 9853 SPLIT LOG ROAD (BRENTWOOD)
Planning Commission Mandatory Referral 2023M-132ES-001**

On behalf of the Metropolitan Planning Commission, the following item, referred to the Commission as required by the Metro Charter, has been recommended for *approval* to the Metropolitan Council:

A request for the acceptance of approximately 363 linear feet of eight-inch sanitary sewer mains (DIP), two sewer manholes, and easements to serve the development at 9853 Split Log Road in Williamson County.

The relevant Metro agencies (Metro Parks, Metro Public Works, Metro Water Services, Metro Emergency Communications, the Nashville Electric Service, Metro Finance – Public Property and the Metro Historical Commission) have reviewed the proposal and concur in the recommendation for approval. This request must be approved by the Metro Council to become effective. A sketch showing the location of the request is attached to this letter.

Conditions that apply to this approval: none

This recommendation for approval is given as set forth in the Metropolitan Planning Commission Rules and Procedures. If you have any questions about this matter, please contact Delilah Rhodes at delilah.rhodes@nashville.gov or 615-862-7208.

Sincerely,

A handwritten signature in blue ink that reads "Lisa Milligan".

Lisa Milligan
Land Development Manager
Metro Planning Department
cc: Metro Clerk

Re: 9853 SPLIT LOG ROAD (BRENTWOOD)
Planning Commission Mandatory Referral # 2023M-132ES-001

A request for the acceptance of approximately 363 linear feet of eight inch sanitary sewer mains (DIP), two sewer manholes, and easements to serve the development at 9853 Split Log Road in Williamson County.

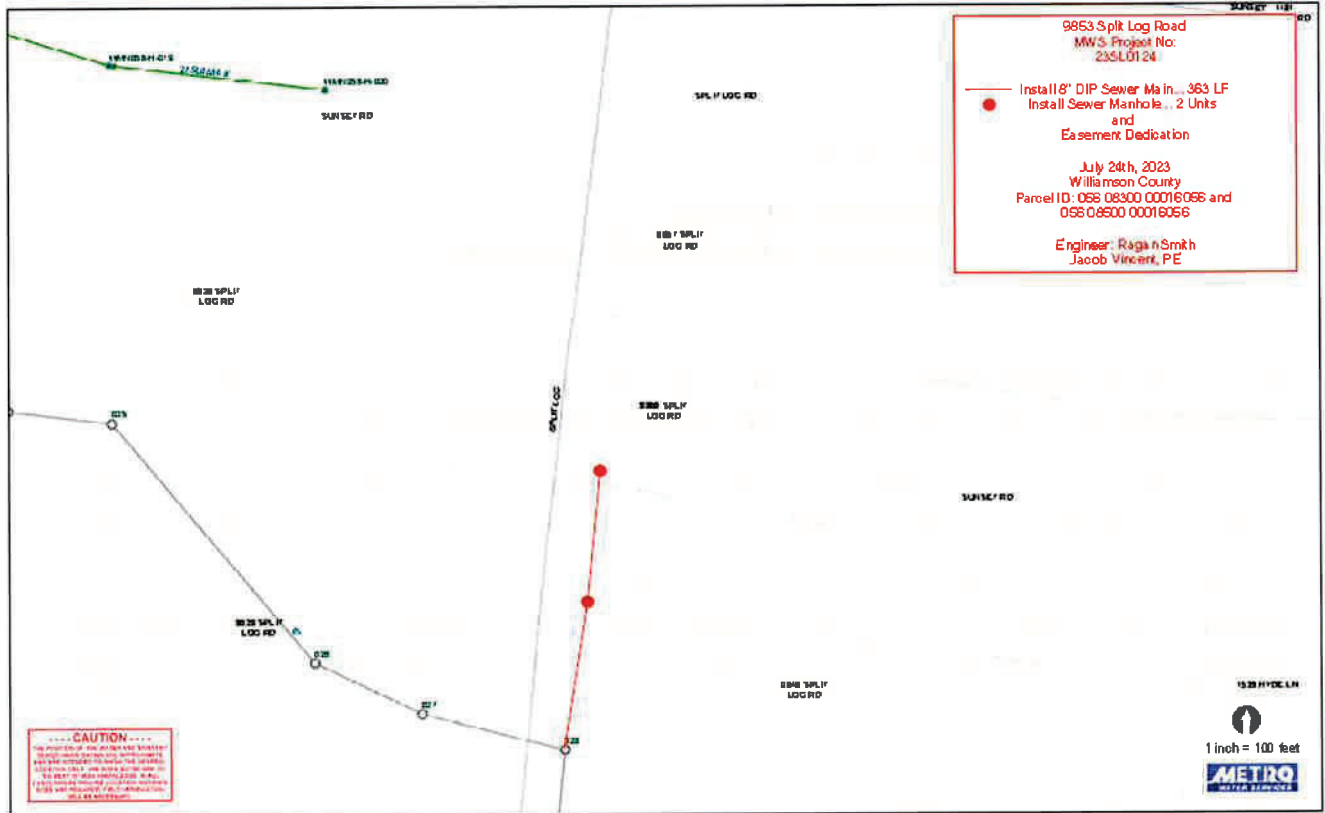

WMN056-H-019
21SL0086 8"
WMN056-H-020
SUNSET RD

9853 Split Log Road
MWS Project No:
23SL0124

— Install 8" DIP Sewer Main... 363 LF
● Install Sewer Manhole... 2 Units
and
Easement Dedication

July 24th, 2023
Williamson County
Parcel ID: 056 08300 00016056 and
056 08500 00016056

Engineer: Ragan Smith
Jacob Vincent, PE

9828 SPLIT LOG RD

9857 SPLIT LOG RD

SPLIT LOG

9853 SPLIT LOG RD

SUNSET RD

025

9829 SPLIT LOG RD
8"

026

027

028

9837 SPLIT LOG RD

1529 HYDE LN

----- CAUTION -----
THE POSITION OF THE WATER AND SANITARY SEWER MAINS SHOWN ARE APPROXIMATE AND ARE INTENDED TO SHOW THE GENERAL LOCATION ONLY. THE SIZES NOTED ARE TO THE BEST OF MWS KNOWLEDGE. IN ALL CASES WHERE PRECISE LOCATION AND MAIN SIZES ARE REQUIRED, FIELD VERIFICATION WILL BE NECESSARY.

↑
1 inch = 100 feet
METRO
WATER SERVICES