



**METROPOLITAN GOVERNMENT
OF NASHVILLE AND DAVIDSON COUNTY**

Planning Department
Metro Office Building
800 Second Avenue South
Nashville, Tennessee 37201

March 1, 2022

To: Mike Atchison, Metro Water Services

**Re: 2 Dell Parkway
Planning Commission Mandatory Referral #2022M-027ES-001
Council District #13 – Russ Bradford, Council Member**

On behalf of the Metropolitan Planning Commission, the following item, referred to the Commission as required by the Metro Charter, has been recommended for *approval* to the Metropolitan Council:

A request for the abandonment of 548 linear feet of 10-inch water main and easements and the acceptance of 300 linear feet of 10-inch water main, two fire hydrant assemblies, and easements to serve the 2 Dell Parkway development (see sketch for details).

The relevant Metro agencies (Metro Parks, Metro Public Works, Metro Water Services, Metro Emergency Communications, the Nashville Electric Service, Metro Finance – Public Property and the Metro Historical Commission) have reviewed the proposal and concur in the recommendation for approval. This request must be approved by the Metro Council to become effective. A sketch showing the location of the request is attached to this letter.

Conditions that apply to this approval: none

This recommendation for approval is given as set forth in the Metropolitan Planning Commission Rules and Procedures. If you have any questions about this matter, please contact Michelle Hollingsworth at michelle.hollingsworth@nashville.gov or 615-862-7197.

Sincerely,

A handwritten signature in black ink that reads "Robert Leeman".

Robert Leeman
Deputy Director
Metro Planning Department
cc: *Metro Clerk*

**Re: 2 Dell Parkway
Planning Commission Mandatory Referral #2022M-027ES-001
Council District #13 – Russ Bradford, Council Member**

A request for the abandonment of 548 linear feet of 10-inch water main and easements and the acceptance of 300 linear feet of 10-inch water main, two fire hydrant assemblies, and easements to serve the 2 Dell Parkway development (see sketch for details).

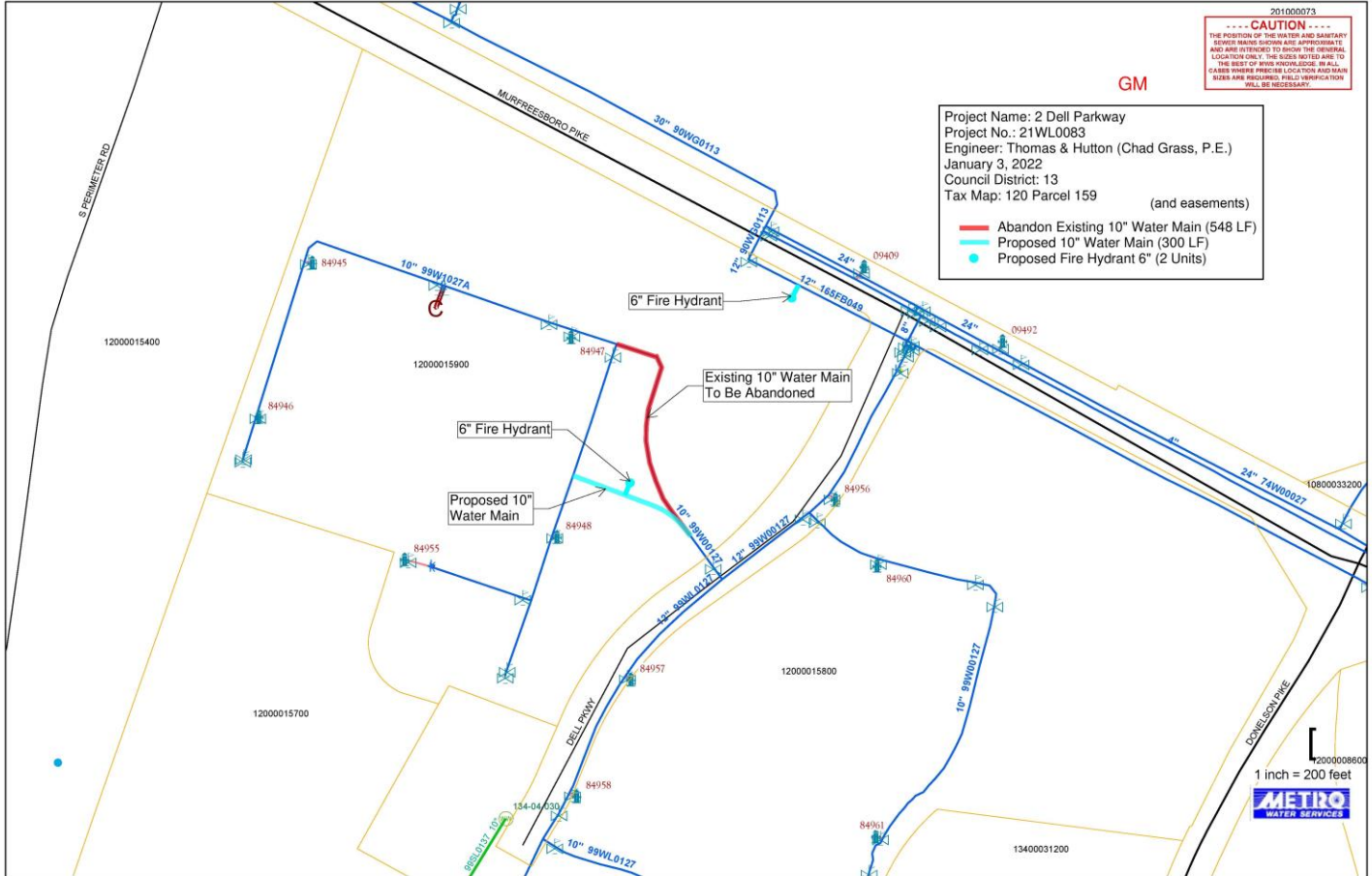

----- CAUTION -----
 THE POSITION OF THE WATER AND SANITARY SEWER MAINS SHOWN ARE APPROXIMATE AND ARE INTENDED TO SHOW THE GENERAL LOCATION ONLY. THE SIZES NOTED ARE TO THE BEST OF MWS KNOWLEDGE. IN ALL CASES WHERE PRECISE LOCATION AND MAIN SIZES ARE REQUIRED, FIELD VERIFICATION WILL BE NECESSARY.

GM

Project Name: 2 Dell Parkway
 Project No.: 21WL0083
 Engineer: Thomas & Hutton (Chad Grass, P.E.)
 January 3, 2022
 Council District: 13
 Tax Map: 120 Parcel 159 (and easements)

- Abandon Existing 10" Water Main (548 LF)
- Proposed 10" Water Main (300 LF)
- Proposed Fire Hydrant 6" (2 Units)

