



METROPOLITAN GOVERNMENT OF NASHVILLE

AND DAVIDSON COUNTY

Metro Office Building
800 President Ronald Reagan Way
P.O. Box 196300
Nashville, TN 37219-6300

August 23, 2023

To: Mike Atchison Metro Water Services

Re: BEN ALLEN RIDGE APARTMENTS
Planning Commission Mandatory Referral 2023M-133ES-001
Council District #08 Nancy VanReece, Council Member

On behalf of the Metropolitan Planning Commission, the following item, referred to the Commission as required by the Metro Charter, has been recommended for *approval* to the Metropolitan Council:

A request for the acceptance of approximately 1,398 linear feet of eight-inch sanitary sewer main (PVC), 113 linear feet of eight-inch sanitary sewer main (DIP), seven sanitary sewer manholes, and any associated easements to serve the Onsite portion of the Ben Allen Ridge Apartments development.

The relevant Metro agencies (Metro Parks, Metro Public Works, Metro Water Services, Metro Emergency Communications, the Nashville Electric Service, Metro Finance – Public Property and the Metro Historical Commission) have reviewed the proposal and concur in the recommendation for approval. This request must be approved by the Metro Council to become effective. A sketch showing the location of the request is attached to this letter.

Conditions that apply to this approval: none

This recommendation for approval is given as set forth in the Metropolitan Planning Commission Rules and Procedures. If you have any questions about this matter, please contact Delilah Rhodes at delilah.rhodes@nashville.gov or 615-862-7208.

Sincerely,

A handwritten signature in blue ink that reads "Lisa Milligan".

Lisa Milligan
Land Development Manager
Metro Planning Department
cc: Metro Clerk

Re: BEN ALLEN RIDGE APARTMENTS
Planning Commission Mandatory Referral # 2023M-133ES-001
Council District #08 Nancy VanReece, Council Member

A request for the acceptance of approximately 1,398 linear feet of eight-inch sanitary sewer main (PVC), 113 linear feet of eight-inch sanitary sewer main (DIP), seven sanitary sewer manholes, and any associated easements to serve the Onsite portion of the Ben Allen Ridge Apartments development.

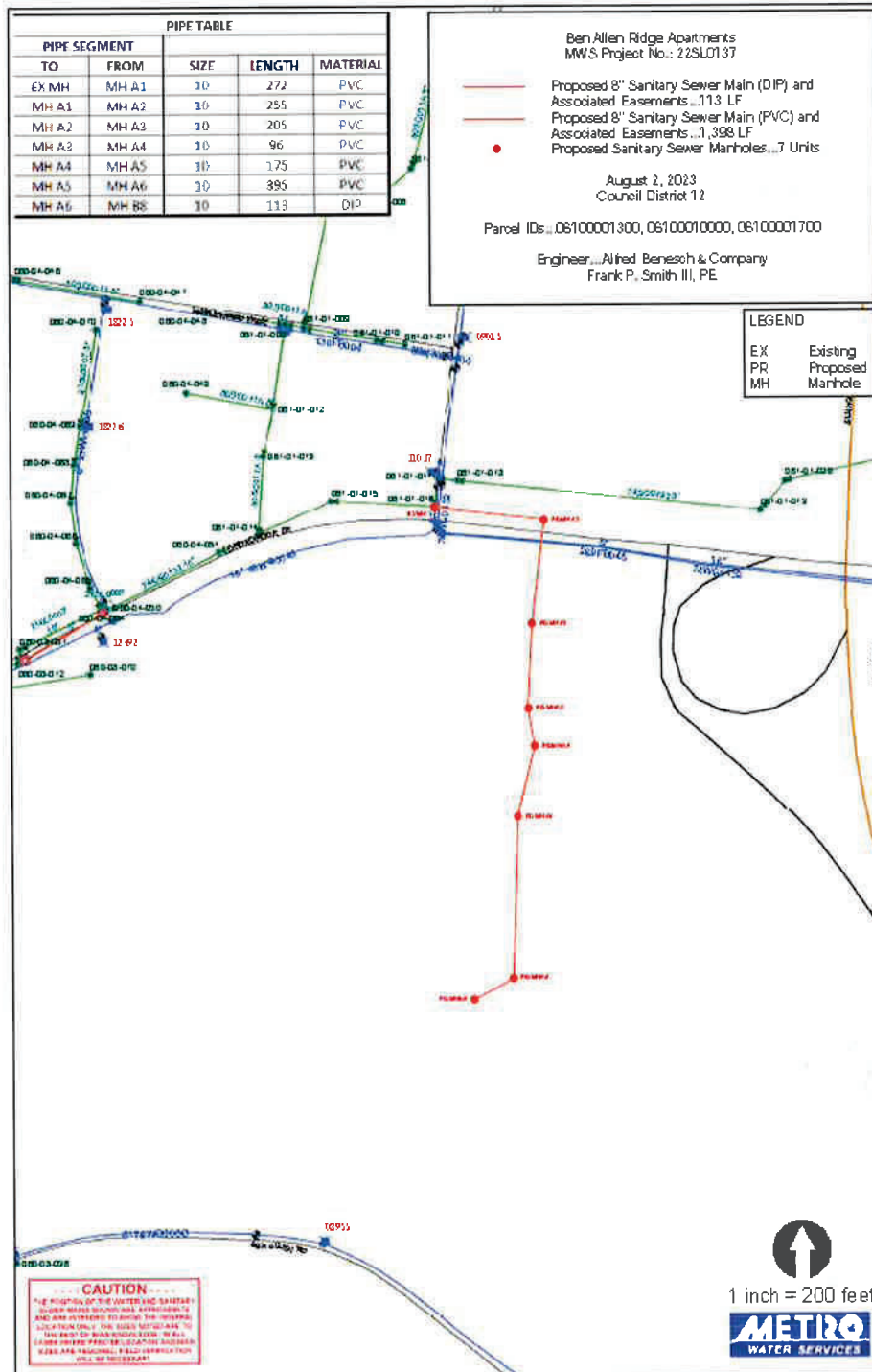

PIPE TABLE				
PIPE SEGMENT				
TO	FROM	SIZE	LENGTH	MATERIAL
EX MH	MH A1	10	272	PVC
MH A1	MH A2	10	255	PVC
MH A2	MH A3	10	205	PVC
MH A3	MH A4	10	96	PVC
MH A4	MH A5	10	175	PVC
MH A5	MH A6	10	395	PVC
MH A6	MH B8	10	113	DIP

Ben Allen Ridge Apartments
MWS Project No.: 22SL0137

Proposed 8" Sanitary Sewer Main (DIP) and Associated Easements...113 LF
Proposed 8" Sanitary Sewer Main (PVC) and Associated Easements...1,398 LF
Proposed Sanitary Sewer Manholes...7 Units

August 2, 2023
Council District 12

Parcel IDs...06100001300, 06100010000, 06100001700

Engineer...Alfred Benesch & Company
Frank P. Smith III, PE

LEGEND	
EX	Existing
PR	Proposed
MH	Manhole

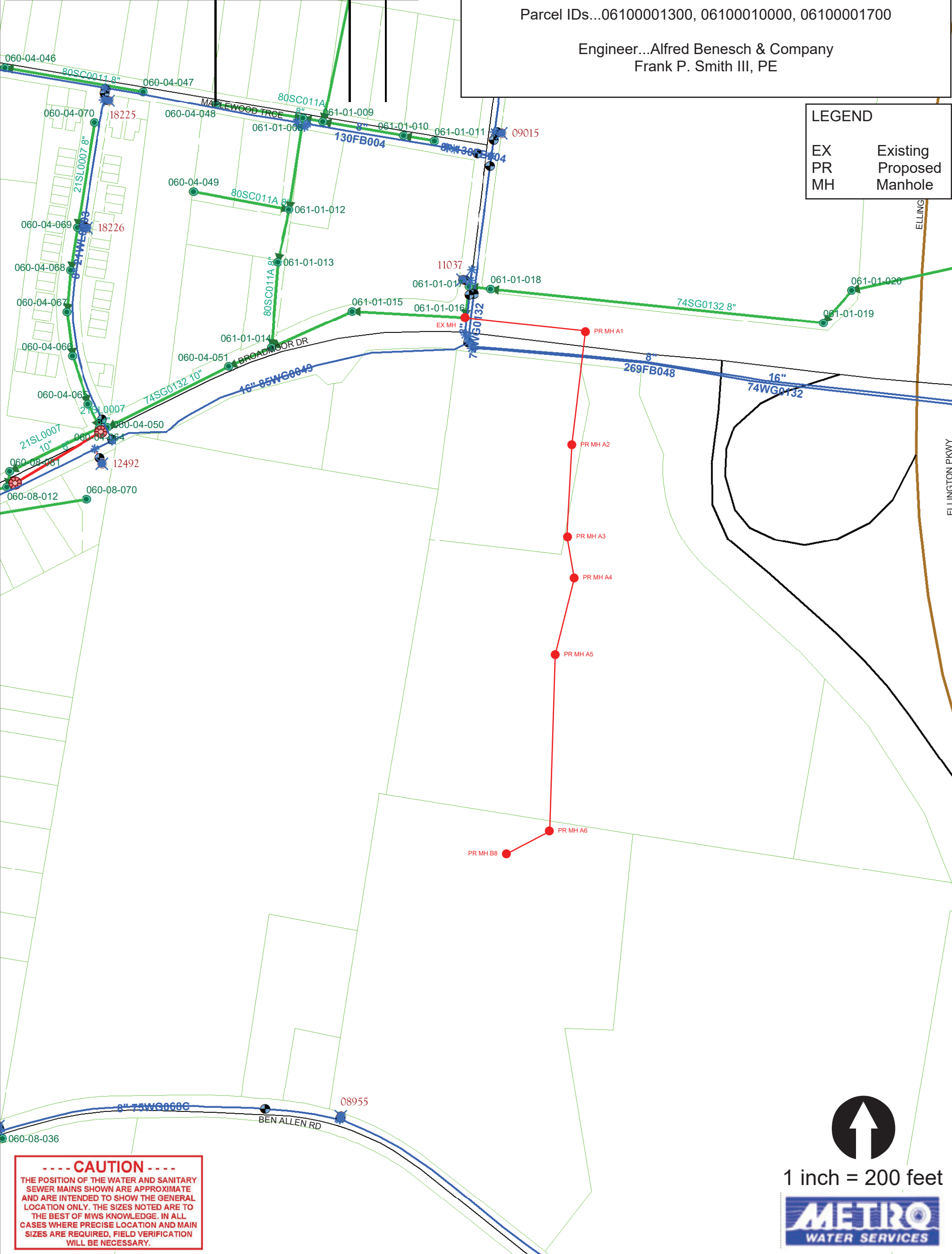

----- CAUTION -----
THE POSITION OF THE WATER AND SANITARY SEWER MAINS SHOWN ARE APPROXIMATE AND ARE INTENDED TO SHOW THE GENERAL LOCATION ONLY. THE SIZES NOTED ARE TO THE BEST OF MWS KNOWLEDGE. IN ALL CASES WHERE PRECISE LOCATION AND MAIN SIZES ARE REQUIRED, FIELD VERIFICATION WILL BE NECESSARY.

1 inch = 200 feet