



January 03, 2024

To: George Reagan Metro Water Services

Re: **MNAA Tari RWM**  
**Planning Commission Mandatory Referral 2023M-214ES-001**  
**Council District #13 Russ Bradford, Council Member**

On behalf of the Metropolitan Planning Commission, the following item, referred to the Commission as required by the Metro Charter, has been recommended for *approval* to the Metropolitan Council:

*A request for the acceptance of approximately 7,160 LF of 24-inch water mains (DIP); and any associated easements to serve the MNAA TARI RWM development.*

The relevant Metro agencies (Metro Parks, Metro Public Works, Metro Water Services, Metro Emergency Communications, the Nashville Electric Service, Metro Finance – Public Property and the Metro Historical Commission) have reviewed the proposal and concur in the recommendation for approval. This request must be approved by the Metro Council to become effective. A sketch showing the location of the request is attached to this letter.

**Conditions that apply to this approval: none**

This recommendation for approval is given as set forth in the Metropolitan Planning Commission Rules and Procedures. If you have any questions about this matter, please contact Delilah Rhodes at [Delilah.Rhodes@nashville.gov](mailto:Delilah.Rhodes@nashville.gov) or 615-862-7208

Sincerely,

A handwritten signature in blue ink that reads "Lisa Milligan".

Lisa Milligan  
Assistant Director Land Development  
Metro Planning Department  
cc: *Metro Clerk*

**Re: MNAA Tari RWM  
Planning Commission Mandatory Referral 2023M-214ES-001  
Council District #13 Russ Bradford, Council Member**

*A request for the acceptance of approximately 7,160 LF of 24-inch water mains (DIP); and any associated easements to serve the MNAA TARI RWM development.*



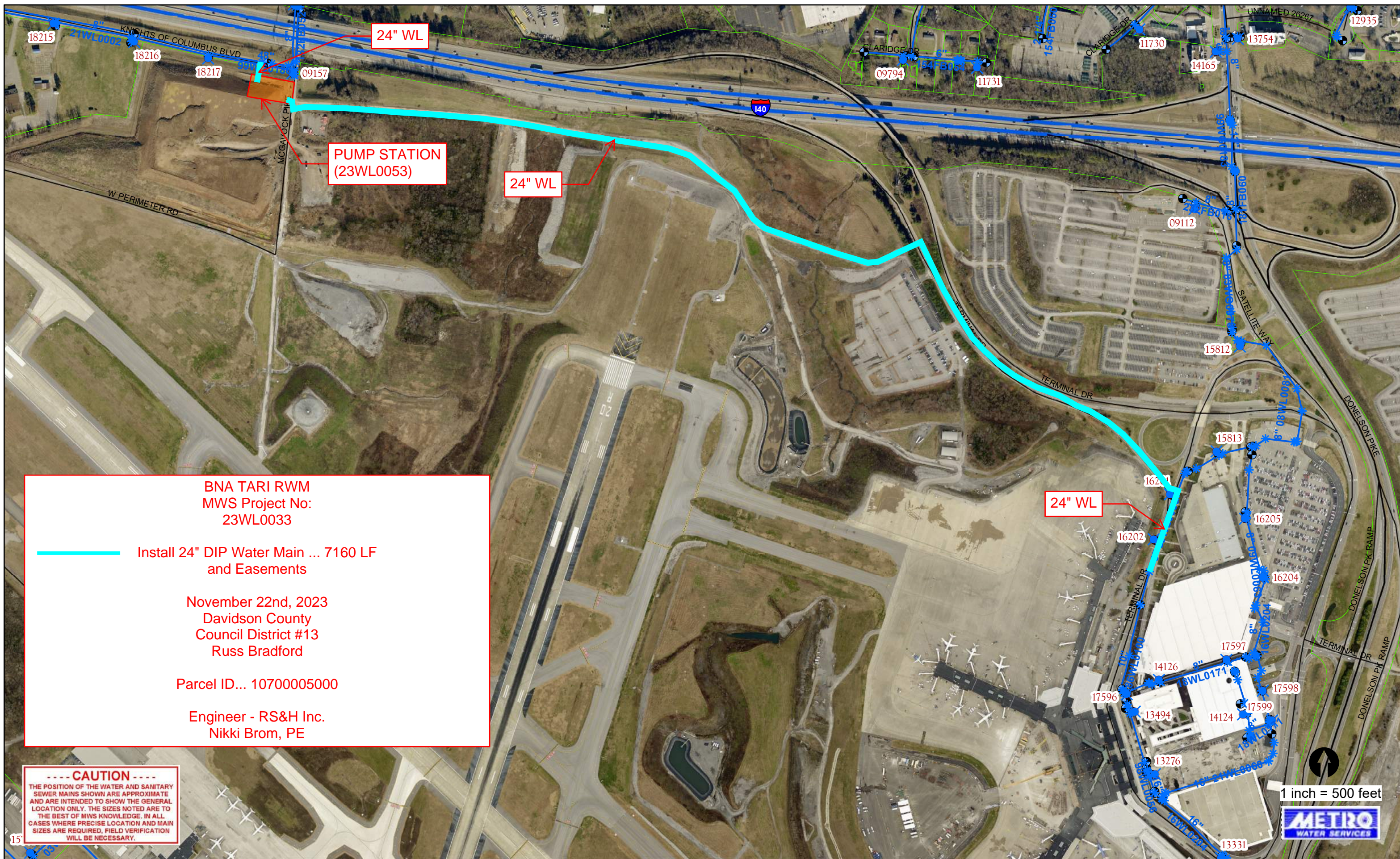

**BNA TARI RWM**  
**MWS Project No:**  
**23WL0033**

Install 24" DIP Water Main ... 7160 LF  
 and Easements

November 22nd, 2023  
 Davidson County  
 Council District #13  
 Russ Bradford

Parcel ID... 10700005000

Engineer - RS&H Inc.  
 Nikki Brom, PE

**----- CAUTION -----**  
 THE POSITION OF THE WATER AND SANITARY  
 SEWER MAINS SHOWN ARE APPROXIMATE  
 AND ARE INTENDED TO SHOW THE GENERAL  
 LOCATION ONLY. THE SIZES NOTED ARE TO  
 THE BEST OF MWS KNOWLEDGE. IN ALL  
 CASES WHERE PRECISE LOCATION AND MAIN  
 SIZES ARE REQUIRED, FIELD VERIFICATION  
 WILL BE NECESSARY.

1 inch = 500 feet  
**METRO**  
 WATER SERVICES