



**METROPOLITAN GOVERNMENT OF NASHVILLE  
AND DAVIDSON COUNTY**

Metro Office Building  
800 President Ronald Reagan Way  
P.O. Box 196300  
Nashville, TN 37219-6300

September 18, 2022

To: Mike Atchison, Metro Water Services

**Re: TRIMBLE STREET COTTAGE HOMES  
Planning Commission Mandatory Referral #2022M-138ES-001  
Council District #17 Colby Sledge, Council Member**

On behalf of the Metropolitan Planning Commission, the following item, referred to the Commission as required by the Metro Charter, has been recommended for *approval* to the Metropolitan Council:

*A request for approval for the acceptance of approximately 185 linear feet of eight inch sanitary sewer main (PVC) and two sanitary sewer manholes to serve the Trimble Street Cottage Homes.*

The relevant Metro agencies (Metro Parks, Metro Public Works, Metro Water Services, Metro Emergency Communications, the Nashville Electric Service, Metro Finance – Public Property and the Metro Historical Commission) have reviewed the proposal and concur in the recommendation for approval. This request must be approved by the Metro Council to become effective. A sketch showing the location of the request is attached to this letter.

**Conditions that apply to this approval: none**

This recommendation for approval is given as set forth in the Metropolitan Planning Commission Rules and Procedures. If you have any questions about this matter, please contact Delilah Rhodes at [delilah.rhodes@nashville.gov](mailto:delilah.rhodes@nashville.gov) or 615-862-7208.

Sincerely,

A handwritten signature in blue ink that reads "Lisa Milligan".

Lisa Milligan  
Land Development Manager  
Metro Planning Department  
cc: *Metro Clerk*

**Re: TRIMBLE STREET COTTAGE HOMES**  
**Planning Commission Mandatory Referral #2022M-138ES-001**  
**Council District #17 Colby Sledge, Council Member**

*A request for approval for the acceptance of approximately 185 linear feet of eight inch sanitary sewer main (PVC) and two sanitary sewer manholes to serve the Trimble Street Cottage Homes.*

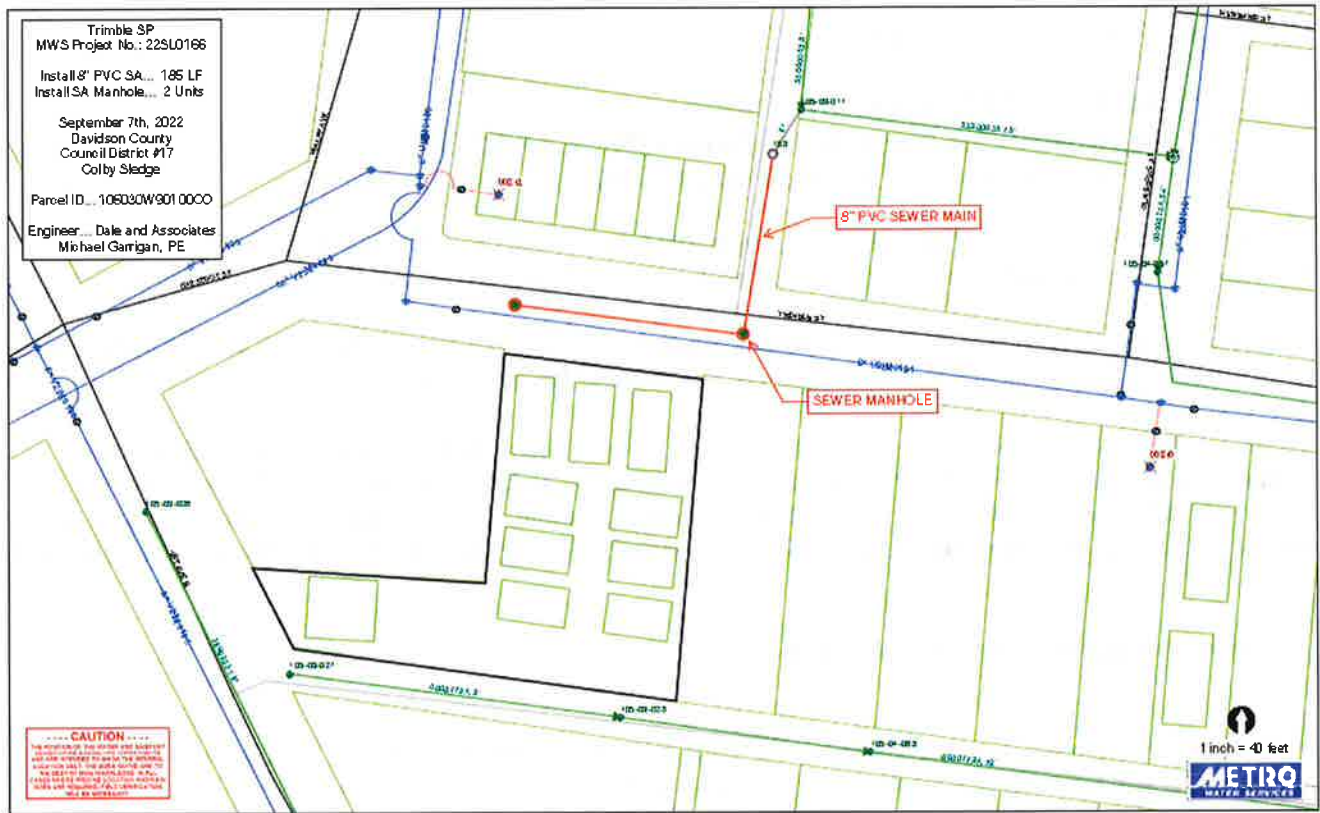

Trimble SP  
 MWS Project No.: 22SL0166  
 Install 8" PVC SA... 185 LF  
 Install SA Manhole... 2 Units

September 7th, 2022  
 Davidson County  
 Council District #17  
 Colby Sledge

Parcel ID... 105030W90100CO  
 Engineer... Dale and Associates  
 Michael Garrigan, PE

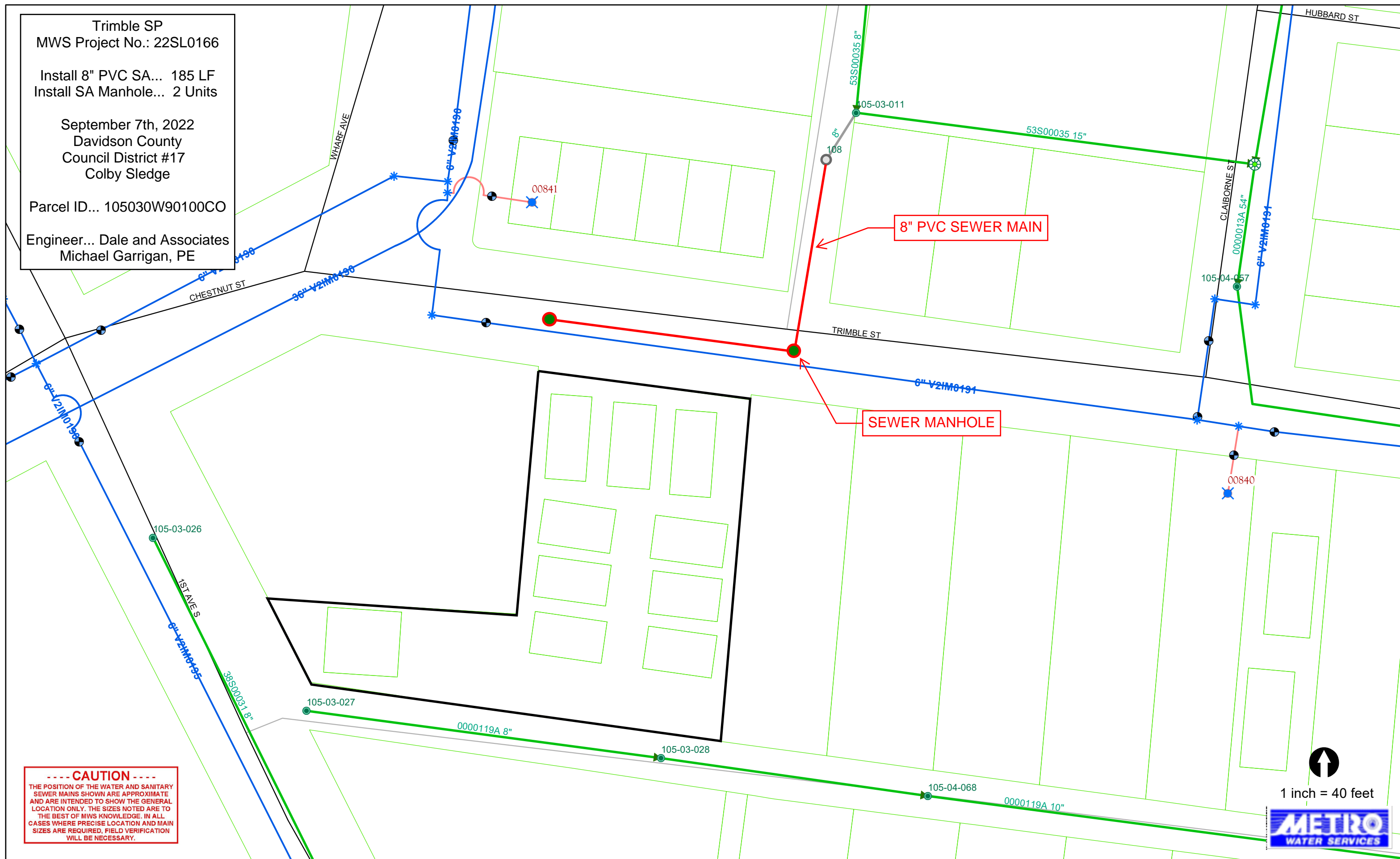

**----- CAUTION -----**  
 THE POSITION OF THE WATER AND SANITARY SEWER MAINS SHOWN ARE APPROXIMATE AND ARE INTENDED TO SHOW THE GENERAL LOCATION ONLY. THE SIZES NOTED ARE TO THE BEST OF MWS KNOWLEDGE. IN ALL CASES WHERE PRECISE LOCATION AND MAIN SIZES ARE REQUIRED, FIELD VERIFICATION WILL BE NECESSARY.

1 inch = 40 feet