

Camden Nations MWS Project # 22SL0203

- Sanitary Sewer to be Abandoned... 1,187 LF
- Sanitary Sewer 15-inch (PVC)... 425 LF
- Sanitary Sewer 14-inch (DIP)... 232 LF
- Sanitary Sewer 12-inch (PVC)... 155 LF
- Sanitary Sewer 8-inch (PVC)... 552 LF
- Sanitary Sewer Manholes... 10 Units

July 26, 2023 Council District: 20 Tax Map: 091-07 Parcels:
48, 49, 50, 51, 52, 53, 54, 55, 101, 102, 103, 359, and 360

Kimley-Horn
(Matt Schlicker, PE)

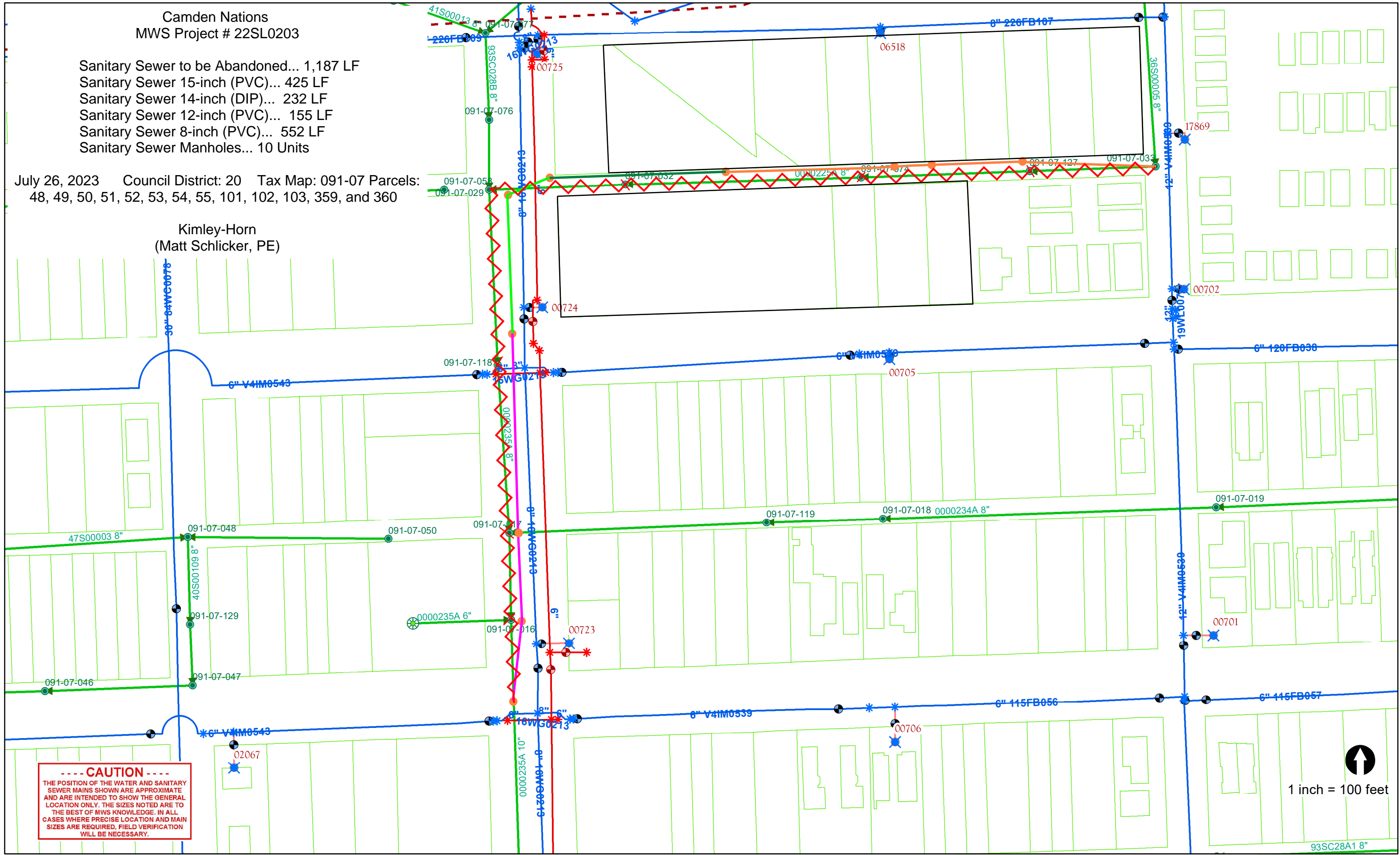

----- CAUTION -----
 THE POSITION OF THE WATER AND SANITARY
 SEWER MAINS SHOWN ARE APPROXIMATE
 AND ARE INTENDED TO SHOW THE GENERAL
 LOCATION ONLY. THE SIZES NOTED ARE TO
 THE BEST OF MWS KNOWLEDGE. IN ALL
 CASES WHERE PRECISE LOCATION AND MAIN
 SIZES ARE REQUIRED, FIELD VERIFICATION
 WILL BE NECESSARY.

↑
1 inch = 100 feet

CAMDEN NATIONS PROJECT NO. 22-SL-203
Parcel List

| <u>Address</u> | <u>Map/Parcels</u> | <u>Property Owners</u> |
|-----------------------|---------------------------|-------------------------------|
| 4901 Louisiana Ave | 09107004800 | Camden Nations, LLC |
| 4903 Louisiana Ave | 09107004900 | Camden Nations, LLC |
| 4905 Louisiana Ave | 09107005000 | Camden Nations, LLC |
| 4907 Louisiana Ave | 09107005100 | Camden Nations, LLC |
| 4909 Louisiana Ave | 09107005200 | Camden Nations, LLC |
| 4911 Louisiana Ave | 09107005300 | Camden Nations, LLC |
| 5001 Louisiana Ave | 09107005400 | Camden Nations, LLC |
| 5003 Louisiana Ave | 09107005500 | Camden Nations, LLC |
| 5010 Tennessee Ave | 09107010100 | Camden Nations, LLC |
| 4910 Tennessee Ave | 09107010200 | Camden Nations, LLC |
| 4908 Tennessee Ave | 09107010300 | Camden Nations, LLC |
| 4915 Louisiana Ave | 09107035900 | Camden Nations, LLC |
| 4912 Tennessee Ave | 09107036000 | Camden Nations, LLC |



November 30, 2023

To: Mike Atchison Metro Water Services

Re: **CAMDEN NATIONS**
Planning Commission Mandatory Referral 2023M-187ES-001
Council District #20 Rollin Horton, Council Member

On behalf of the Metropolitan Planning Commission, the following item, referred to the Commission as required by the Metro Charter, has been recommended for *approval* to the Metropolitan Council:

A request for the abandonment of 1,187 linear feet of sanitary sewer main and six sanitary sewer manholes, and the acceptance of approximately 425 linear feet of 15-inch sanitary sewer main (PVC), 232 linear feet of 14-inch sanitary sewer main (DIP), 155 linear feet of 12-inch sanitary sewer main (PVC), and 552 linear feet of 8-inch sanitary sewer main (PVC) and ten sanitary sewer manholes and to serve the Camden Nations development.

The relevant Metro agencies (Metro Parks, Metro Public Works, Metro Water Services, Metro Emergency Communications, the Nashville Electric Service, Metro Finance – Public Property and the Metro Historical Commission) have reviewed the proposal and concur in the recommendation for approval. This request must be approved by the Metro Council to become effective. A sketch showing the location of the request is attached to this letter.

Conditions that apply to this approval: none

This recommendation for approval is given as set forth in the Metropolitan Planning Commission Rules and Procedures. If you have any questions about this matter, please contact Delilah Rhodes at Delilah.Rhodes@nashville.gov or 615-862-7208

Sincerely,

A handwritten signature in blue ink that reads "Lisa Milligan".

Lisa Milligan
Assistant Director Land Development
Metro Planning Department
cc: *Metro Clerk*

**Re: CAMDEN NATIONS
Planning Commission Mandatory Referral 2023M-187ES-001
Council District #20 Rollin Horton, Council Member**

A request for the abandonment of 1,187 linear feet of sanitary sewer main and six sanitary sewer manholes, and the acceptance of approximately 425 linear feet of 15-inch sanitary sewer main (PVC), 232 linear feet of 14-inch sanitary sewer main (DIP), 155 linear feet of 12-inch sanitary sewer main (PVC), and 552 linear feet of 8-inch sanitary sewer main (PVC) and ten sanitary sewer manholes and to serve the Camden Nations development.

