

ORDINANCE NO. BL2021-616

An ordinance authorizing The Metropolitan Government of Nashville and Davidson County to abandon existing public water main and easements, and to accept new water and sanitary sewer mains, fire hydrant assemblies, sanitary sewer manholes, pressure reducing valve and easements, for property located at Brick Church Lane (unnumbered), also known as Heartland North Phase 1 (MWS Project Nos. 18-WL-172 and 18-SL-226 and Proposal No. 2020M-110ES-001).

WHEREAS, the abandonment of approximately 1,350 linear feet of existing eight inch water main and easements, and the acceptance of approximately 1,655 linear feet of new 12 inch water main (DIP), approximately 2,866 linear feet of new eight inch water main (DIP), approximately 2,254 linear feet of new eight inch sanitary sewer main, five hydrant assemblies, 18 sanitary sewer manholes, one pressure reducing valve, reconnection of three existing fire hydrant assemblies and easements, for property located at Brick Church Lane (unnumbered), also known as Heartland North Phase 1, are needed to construct project numbers 18-WL-172 and 18-SL-226; and,

WHEREAS, the Metropolitan Planning Commission approved mandatory referral No. 2020M-110ES-001 on December 16, 2020, for the abandonment and acceptance of said water and sanitary sewer mains, fire hydrant assemblies, sanitary sewer manholes, pressure reducing valve and easements.

NOW, THEREFORE, BE IT ENACTED BY THE COUNCIL OF THE METROPOLITAN GOVERNMENT OF NASHVILLE AND DAVIDSON COUNTY:

Section 1. The Metropolitan Government of Nashville and Davidson County is authorized to abandon approximately 1,350 linear feet of existing eight inch water main and easements, and to accept approximately 1,655 linear feet of new 12 inch water main (DIP), approximately 2,866 linear feet of new eight inch water main (DIP), approximately 2,254 linear feet of new eight inch sanitary sewer main, five hydrant assemblies, 18 sanitary sewer manholes, one pressure reducing valve, reconnection of three existing fire hydrant assemblies and easements, for property located at Brick Church Lane (unnumbered), also known as Heartland North Phase 1, as shown on Exhibit 1, which is attached hereto and incorporated by reference.

Map & Parcel:

Address:

05000009900

Brick Church Lane (unnumbered)

Section 2. The Directors of Water and Sewerage Services and Public Property Administration are authorized to execute such documents as may be necessary and appropriate to carry out the abandonment and acceptance authorized by this ordinance.

Section 3. Amendments to this legislation shall be approved by resolution.

Section 4. This ordinance shall take effect from and after its final passage, the welfare of The Metropolitan Government of Nashville and Davidson County requiring it.

RECOMMENDED BY:

DocuSigned by:

Scott Potter

994E7D0AE02B458...

Scott A. Potter, Director
Water and Sewerage Services

DocuSigned by:

Trael Webb

D56F33C09946459

Trael Webb, Director
Public Property Administration

APPROVED AS TO THE
AVAILABILITY OF FUNDS:

DocuSigned by:

Kevin Crumbo

6ACD297069E514E9

Kevin Crumbo, Director
Department of Finance

APPROVED AS TO FORM
AND LEGALITY:

DocuSigned by:

Tara Ladd

E455157157147

Tara Ladd, Assistant Metropolitan Attorney

INTRODUCED BY:

Jennifer Arble

Kathleen Murphy

Robert Nash

Council Member(s)



**METROPOLITAN GOVERNMENT
OF NASHVILLE AND DAVIDSON COUNTY**

Planning Department
Metro Office Building
800 Second Avenue South
Nashville, Tennessee 37201

December 16, 2020

To: Mike Atchison, Metro Water Services

**Re: Heartland North Phase 1
Planning Commission Mandatory Referral #2020M-110ES-001**
Council District #03 – Jennifer Gamble, Council Member

On behalf of the Metropolitan Planning Commission, the following item, referred to the Commission as required by the Metro Charter, has been recommended for *approval* to the Metropolitan Council:

A request for the abandonment of approximately 1,350 linear feet of 8-inch water main and easements, and the acceptance of approximately 1,655 linear feet of 12-inch water main (DIP), 2,866 linear feet of 8-inch water main (DIP), five fire hydrant assemblies, one pressure reducing valve, 2,254 linear feet of 8-inch sanitary sewer main, 18 sanitary sewer manholes, easements, and the reconnection of three existing fire hydrant assemblies to serve the Heartland North Phase 1 development. (see sketch for details). (MWS Project Nos. 18-SL-226 and 18-WL-172).

The relevant Metro agencies (Metro Parks, Metro Public Works, Metro Water Services, Metro Emergency Communications, the Nashville Electric Service, Metro Finance – Public Property and the Metro Historical Commission) have reviewed the proposal and concur in the recommendation for approval. This request must be approved by the Metro Council to become effective. A sketch showing the location of the request is attached to this letter.

Conditions that apply to this approval: None.

This recommendation for approval is given as set forth in the Metropolitan Planning Commission Rules and Procedures. If you have any questions about this matter, please contact Sharon O'Conner at Sharon.oconner@nashville.gov or 615-862-7208.

Sincerely,

A handwritten signature in black ink that reads 'Robert Leeman'.

Robert Leeman, AICP
Deputy Director
Metro Planning Department
cc: Metro Clerk, Elizabeth Waites

Re: Heartland North Phase 1
Planning Commission Mandatory Referral #2020M-110ES-001
Council District #03 – Jennifer Gamble, Council Member

A request for the abandonment of approximately 1,350 linear feet of 8-inch water main and easements, and the acceptance of approximately 1,655 linear feet of 12-inch water main (DIP), 2,866 linear feet of 8-inch water main (DIP), five fire hydrant assemblies, one pressure reducing valve, 2,254 linear feet of 8-inch sanitary sewer main, 18 sanitary sewer manholes, easements, and the reconnection of three existing fire hydrant assemblies to serve the Heartland North Phase 1 development. (see sketch for details). (MWS Project Nos. 18-SL-226 and 18-WL-172).

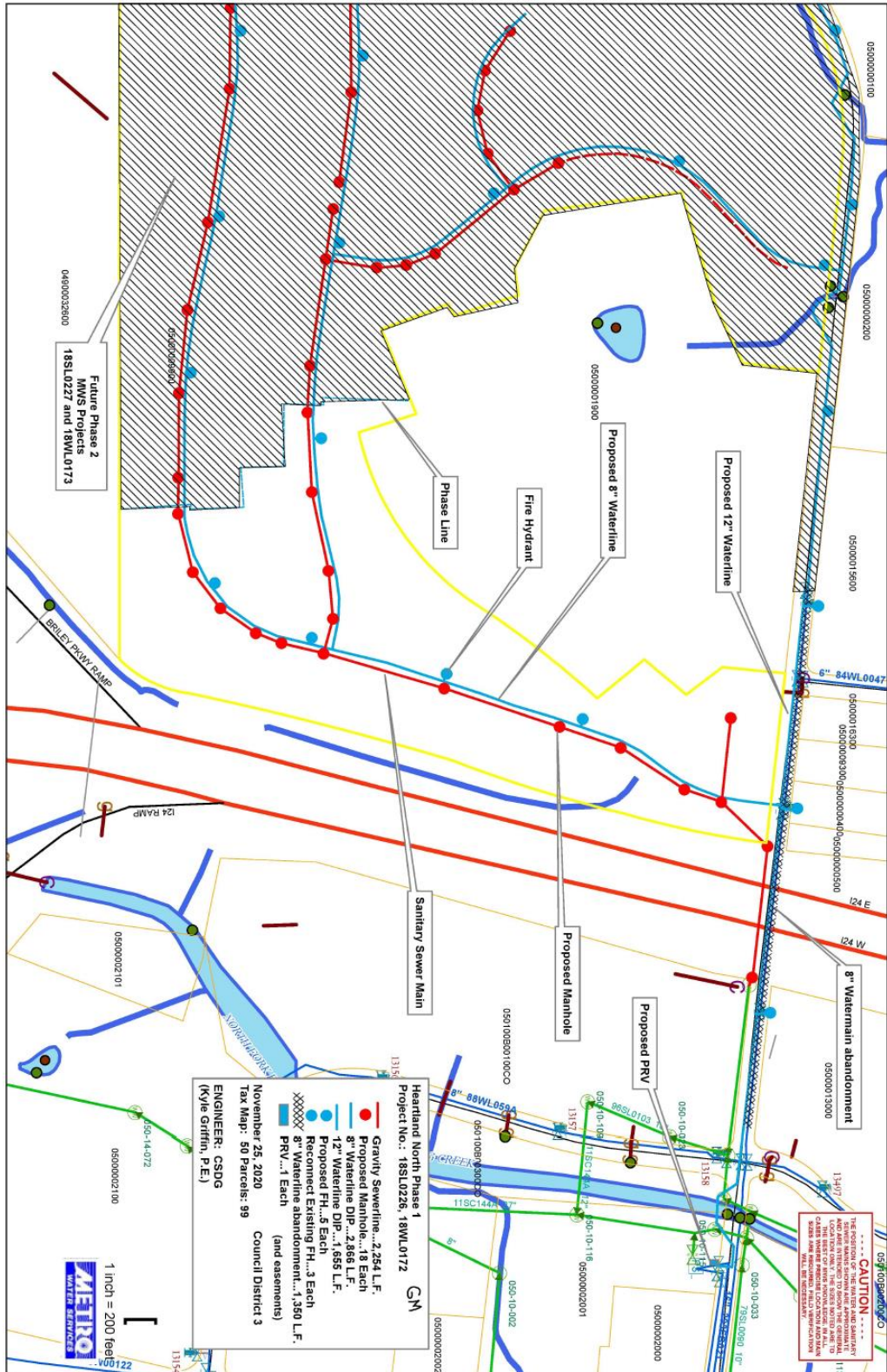

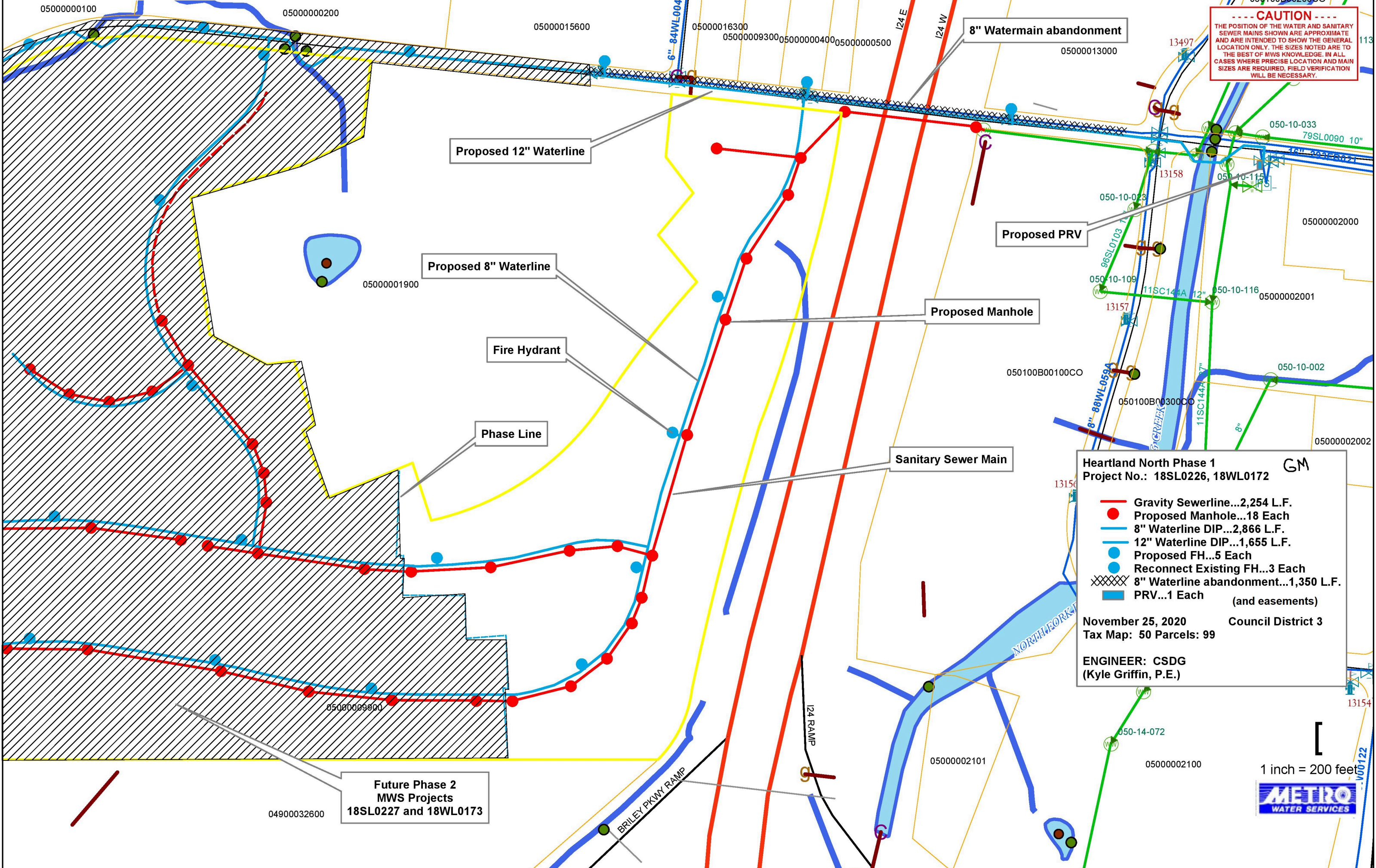

CAUTION
 THE POSITION OF THE WATER AND SANITARY SEWER MAINS SHOWN ARE APPROXIMATE AND ARE INTENDED TO SHOW THE GENERAL LOCATION ONLY. THE SIZES NOTED ARE TO THE BEST OF MWS KNOWLEDGE. IN ALL CASES WHERE PRECISE LOCATION AND MAIN SIZES ARE REQUIRED, FIELD VERIFICATION WILL BE NECESSARY.

Heartland North Phase 1 GM
 Project No.: 18SL0226, 18WL0172

- Gravity Sewerline...2,254 L.F.
- Proposed Manhole...18 Each
- 8" Waterline DIP...2,866 L.F.
- 12" Waterline DIP...1,655 L.F.
- Proposed FH...5 Each
- Reconnect Existing FH...3 Each
- 8" Waterline abandonment...1,350 L.F.
- PRV...1 Each (and easements)

November 25, 2020 Council District 3
 Tax Map: 50 Parcels: 99

ENGINEER: CSDG
 (Kyle Griffin, P.E.)

Future Phase 2
 MWS Projects
 18SL0227 and 18WL0173

1 inch = 200 feet