

Parks at Cane Ridge - Phase 2B
MWS Project Nos.: 23SL0280 & 23WL0106

- Proposed 8" Sanitary Sewer Main (DIP)...186 LF
- Proposed 8" Sanitary Sewer Main (PVC)...1,107 LF
- Proposed 2" Sanitary Sewer Force Main (PVC)...247 LF
- Proposed Sanitary Sewer Manholes...6 Units
- Proposed 8" Water Main (DIP)...3,000 LF
- Proposed Fire Hydrant Assemblies...6 Units

January 7, 2025
Council District 33

Parcel IDs...18200024300, 18200020900, 18200023800

Engineer...Kimley Horn
Kelley Frank, PE

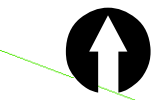
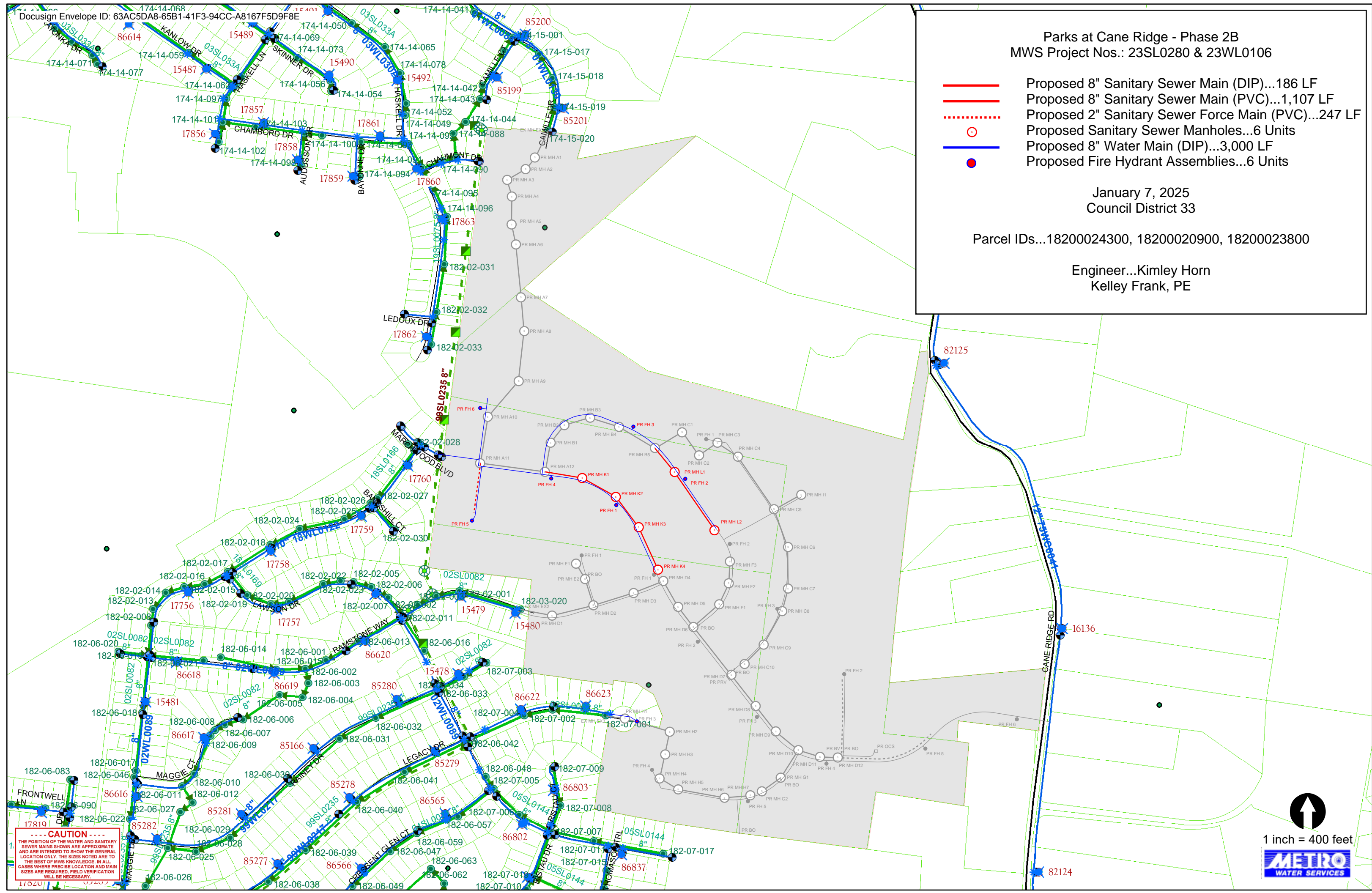

1 inch = 400 feet



-----CAUTION-----
THE POSITION OF THE WATER AND SANITARY SEWER MAINS SHOWN ARE APPROXIMATE AND ARE INTENDED TO SHOW THE GENERAL LOCATION ONLY. THE SIZES NOTED ARE TO THE BEST OF MWS KNOWLEDGE. IN ALL CASES WHERE PRECISE LOCATION AND MAIN SIZES ARE REQUIRED, FIELD VERIFICATION WILL BE NECESSARY.



January 17, 2025

To: Stephanie James Metro Water Services

Re: **Parks at Cane Ridge Phase 2B**
Planning Commission Mandatory Referral 2025M-004ES-001
Council District # 33 Antoinette Lee, Council Member

On behalf of the Metropolitan Planning Commission, the following item, referred to the Commission as required by the Metro Charter, has been recommended for *approval* to the Metropolitan Council:

A request for the acceptance of approximately 186 linear feet of eight-inch sanitary sewer main (DIP), 1,107 linear feet of eight-inch sanitary sewer mains (PVC), 247 linear feet of two-inch sanitary sewer force main (PVC), six sanitary sewer manholes and approximately 3,000 linear feet of eight-inch water mains (DIP), and six fire hydrant assemblies to serve the Parks at Cane Ridge – Phase 2B development.

The relevant Metro agencies (Metro Parks, Nashville Department of Transportation, Metro Water Services, Metro Emergency Communications, the Nashville Electric Service, Metro Finance – Public Property and the Metro Historical Commission) have reviewed the proposal and concur in the recommendation for approval. This request must be approved by the Metro Council to become effective. A sketch showing the location of the request is attached to this letter.

Conditions that apply to this approval: none

This recommendation for approval is given as set forth in the Metropolitan Planning Commission Rules and Procedures. If you have any questions about this matter, please contact Delilah Rhodes at Delilah.Rhodes@nashville.gov or 615-862-7208

Sincerely,

A handwritten signature in blue ink that reads "Lisa Milligan". The signature is fluid and cursive.

Lisa Milligan
Assistant Director Land Development
Metro Planning Department
cc: Metro Clerk

Re: Parks at Cane Ridge Phase 2B
Planning Commission Mandatory Referral 2025M-004ES-001
Council District # 33 Antoinette Lee, Council Member

A request for the acceptance of approximately 186 linear feet of eight-inch sanitary sewer main (DIP), 1,107 linear feet of eight-inch sanitary sewer mains (PVC), 247 linear feet of two-inch sanitary sewer force main (PVC), six sanitary sewer manholes and approximately 3,000 linear feet of eight-inch water mains (DIP), and six fire hydrant assemblies to serve the Parks at Cane Ridge – Phase 2B development.

