



**METROPOLITAN GOVERNMENT OF NASHVILLE  
AND DAVIDSON COUNTY**

Metro Office Building  
800 President Ronald Reagan Way  
P.O. Box 196300  
Nashville, TN 37219-6300

March 20, 2023

To: Edward Thurman Metro Water Services

Re: **HOBSON FLATS**  
**Planning Commission Mandatory Referral # 2023M-040ES-001**  
**Council District #33 Antoinette Lee, Council Member**

On behalf of the Metropolitan Planning Commission, the following item, referred to the Commission as required by the Metro Charter, has been recommended for *approval* to the Metropolitan Council:

*A request for the acceptance of approximately 174 linear feet of 8-inch sanitary sewer main (PVC), two sanitary sewer manholes and easements to serve the Hobson Flats development.*

The relevant Metro agencies (Metro Parks, Metro Public Works, Metro Water Services, Metro Emergency Communications, the Nashville Electric Service, Metro Finance – Public Property and the Metro Historical Commission) have reviewed the proposal and concur in the recommendation for approval. This request must be approved by the Metro Council to become effective. A sketch showing the location of the request is attached to this letter.

**Conditions that apply to this approval: none**

This recommendation for approval is given as set forth in the Metropolitan Planning Commission Rules and Procedures. If you have any questions about this matter, please contact Delilah Rhodes at [delilah.rhodes@nashville.gov](mailto:delilah.rhodes@nashville.gov) or 615-862-7208.

Sincerely,

A handwritten signature in blue ink, appearing to read "Lisa Milligan".

Lisa Milligan  
Land Development Manager  
Metro Planning Department  
cc: *Metro Clerk*



22SL0208

### Proposed Sewer Main Davidson County, TN Council District 33

- Proposed 8-inch (PVC) Sewer Main... 174 LF
  - Proposed Sanitary Sewer Manholes...2 Units
- And Associated Easements  
Map 164, Parcels 16400020400,  
164040C90700CO, 164080B05700CO  
February 15, 2023  
Dale and Associates, PLLC  
(Michael Garrigan, P.E.)

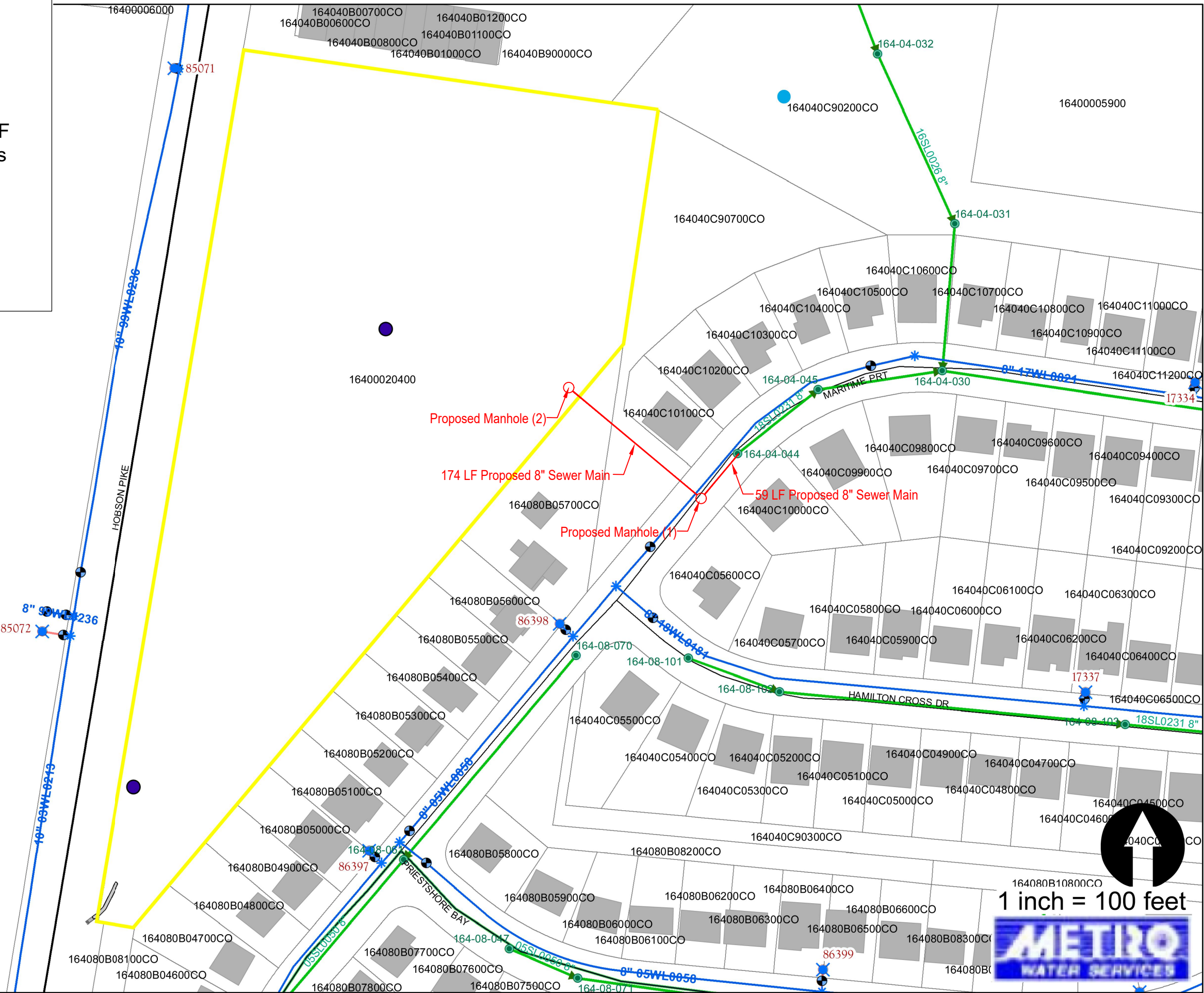

**----- CAUTION -----**  
 THE POSITION OF THE WATER AND SANITARY  
 SEWER MAINS SHOWN ARE APPROXIMATE  
 AND ARE INTENDED TO SHOW THE GENERAL  
 LOCATION ONLY. THE SIZES NOTED ARE TO  
 THE BEST OF MWS KNOWLEDGE. IN ALL  
 CASES WHERE PRECISE LOCATION AND MAIN  
 SIZES ARE REQUIRED, FIELD VERIFICATION  
 WILL BE NECESSARY.

1 inch = 100 feet