

ROSEBROOKE SECTION 6  
MWS PROJECT NUMBER: 24SL0067

8" PVC SANITARY SEWER MAIN... 715 LF  
5 SANITARY SEWER MANHOLES  
AND EASEMENTS

MAY 15H 2024  
WILLIAMSON COUNTY  
PARCEL ID: 055 00900 00016055

ENGINEER: RAGAN SMITH  
JACOB VINCENT, PE

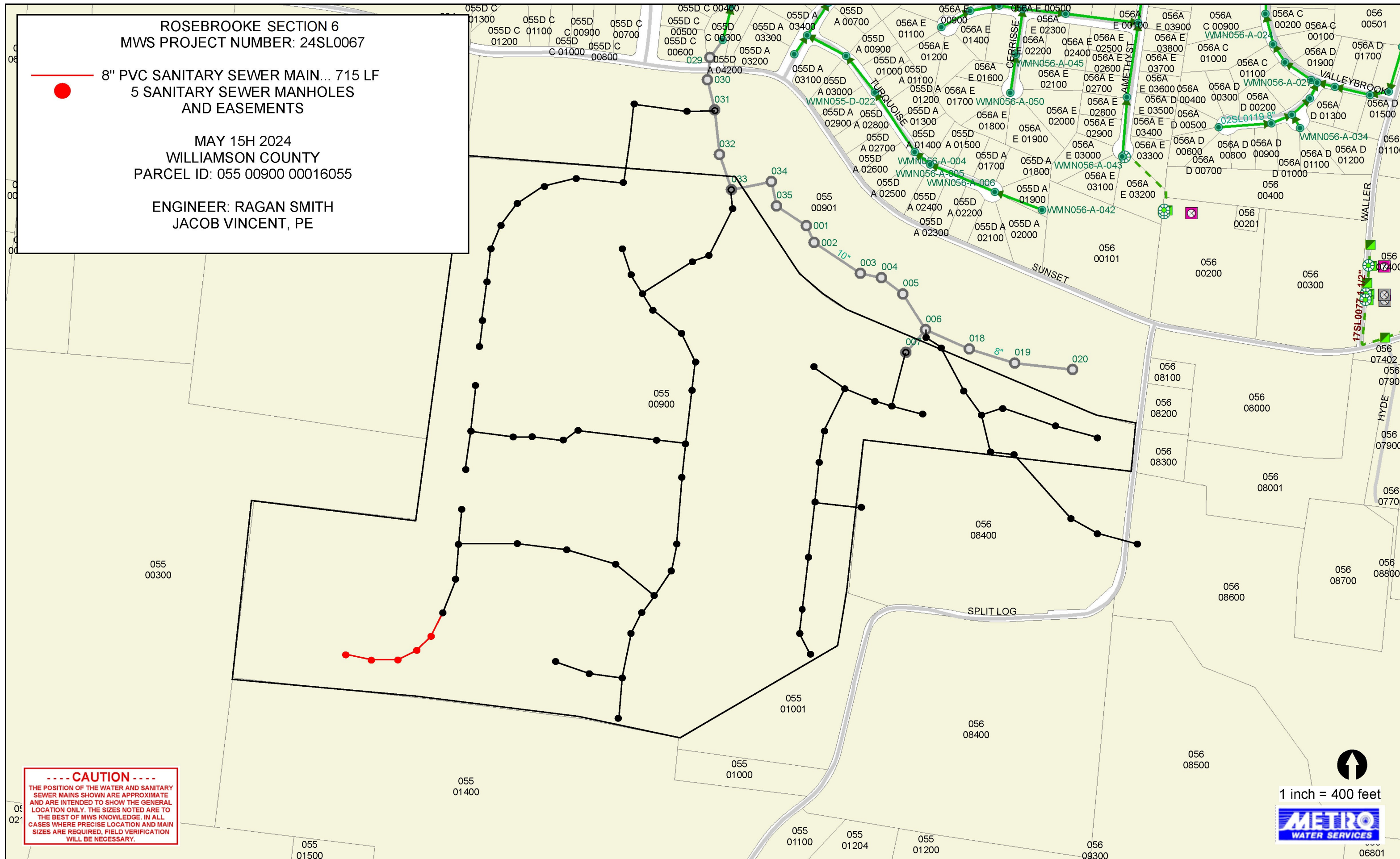

**----- CAUTION -----**  
THE POSITION OF THE WATER AND SANITARY SEWER MAINS SHOWN ARE APPROXIMATE AND ARE INTENDED TO SHOW THE GENERAL LOCATION ONLY. THE SIZES NOTED ARE TO THE BEST OF MWS KNOWLEDGE. IN ALL CASES WHERE PRECISE LOCATION AND MAIN SIZES ARE REQUIRED, FIELD VERIFICATION WILL BE NECESSARY.

1 inch = 400 feet



May 22, 2024

To: Mike Atchison Metro Water Services

Re: **Rosebrooke Section 6  
Planning Commission Mandatory Referral 2024M-073ES-001**

On behalf of the Metropolitan Planning Commission, the following item, referred to the Commission as required by the Metro Charter, has been recommended for *approval* to the Metropolitan Council:

*A request for the acceptance of approximately 715 linear feet of eight-inch sanitary sewer mains (PVC), five sanitary sewer manholes, and easements to serve the Rosebrooke Section 6 development.*

The relevant Metro agencies (Metro Parks, Nashville Department of Transportation, Metro Water Services, Metro Emergency Communications, the Nashville Electric Service, Metro Finance – Public Property and the Metro Historical Commission) have reviewed the proposal and concur in the recommendation for approval. This request must be approved by the Metro Council to become effective. A sketch showing the location of the request is attached to this letter.

**Conditions that apply to this approval: none**

This recommendation for approval is given as set forth in the Metropolitan Planning Commission Rules and Procedures. If you have any questions about this matter, please contact Delilah Rhodes at [Delilah.Rhodes@nashville.gov](mailto:Delilah.Rhodes@nashville.gov) or 615-862-7208

Sincerely,

A handwritten signature in blue ink that reads "Lisa Milligan".

Lisa Milligan  
Assistant Director Land Development  
Metro Planning Department  
cc: *Metro Clerk*

**Re: Rosebrooke Section 6  
Planning Commission Mandatory Referral 2024M-073ES-001**

*A request for the acceptance of approximately 715 linear feet of eight-inch sanitary sewer mains (PVC), five sanitary sewer manholes, and easements to serve the Rosebrooke Section 6 development.).*

