

N A S H V I L L E
P L A N N I N G

March 5, 2024

To: Stephanie James Metro Water Services

Re: **1919 Division Street**
Planning Commission Mandatory Referral 2024M-037ES-001
Council District #17 Terry Vo, Council Member

On behalf of the Metropolitan Planning Commission, the following item, referred to the Commission as required by the Metro Charter, has been recommended for *approval* to the Metropolitan Council:

A request for the abandonment of approximately 400 linear feet of six-inch water main and the acceptance of approximately 400 linear feet of eight-inch water main (DIP) to serve the development at 1919 Division Street.

The relevant Metro agencies (Metro Parks, Metro Public Works, Metro Water Services, Metro Emergency Communications, the Nashville Electric Service, Metro Finance – Public Property and the Metro Historical Commission) have reviewed the proposal and concur in the recommendation for approval. This request must be approved by the Metro Council to become effective. A sketch showing the location of the request is attached to this letter.

Conditions that apply to this approval: none

This recommendation for approval is given as set forth in the Metropolitan Planning Commission Rules and Procedures. If you have any questions about this matter, please contact Delilah Rhodes at Delilah.Rhodes@nashville.gov or 615-862-7208

Sincerely,



Lisa Milligan
Assistant Director Land Development
Metro Planning Department
cc: *Metro Clerk*

**Re: 1919 Division Street
Planning Commission Mandatory Referral 2024M-037ES-001
Council District #17 Terry Vo, Council Member**

A request for the abandonment of approximately 400 linear feet of six-inch water main and the acceptance of approximately 400 linear feet of eight-inch water main (DIP) to serve the development at 1919 Division Street.

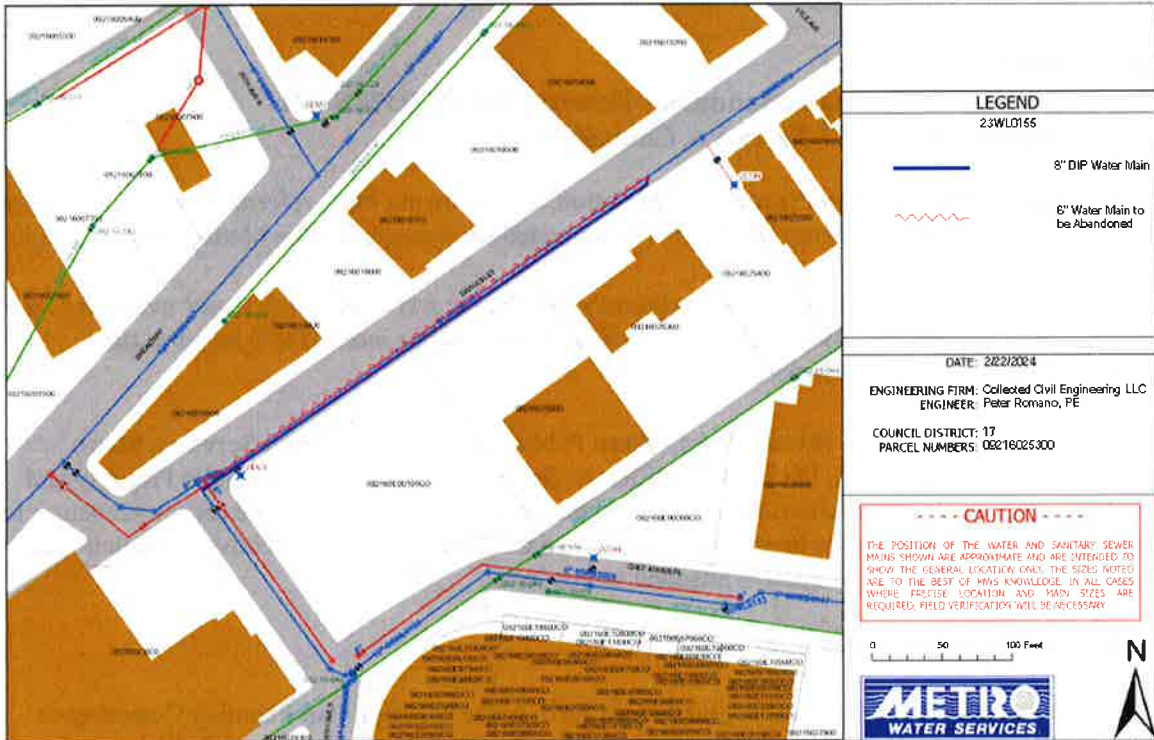

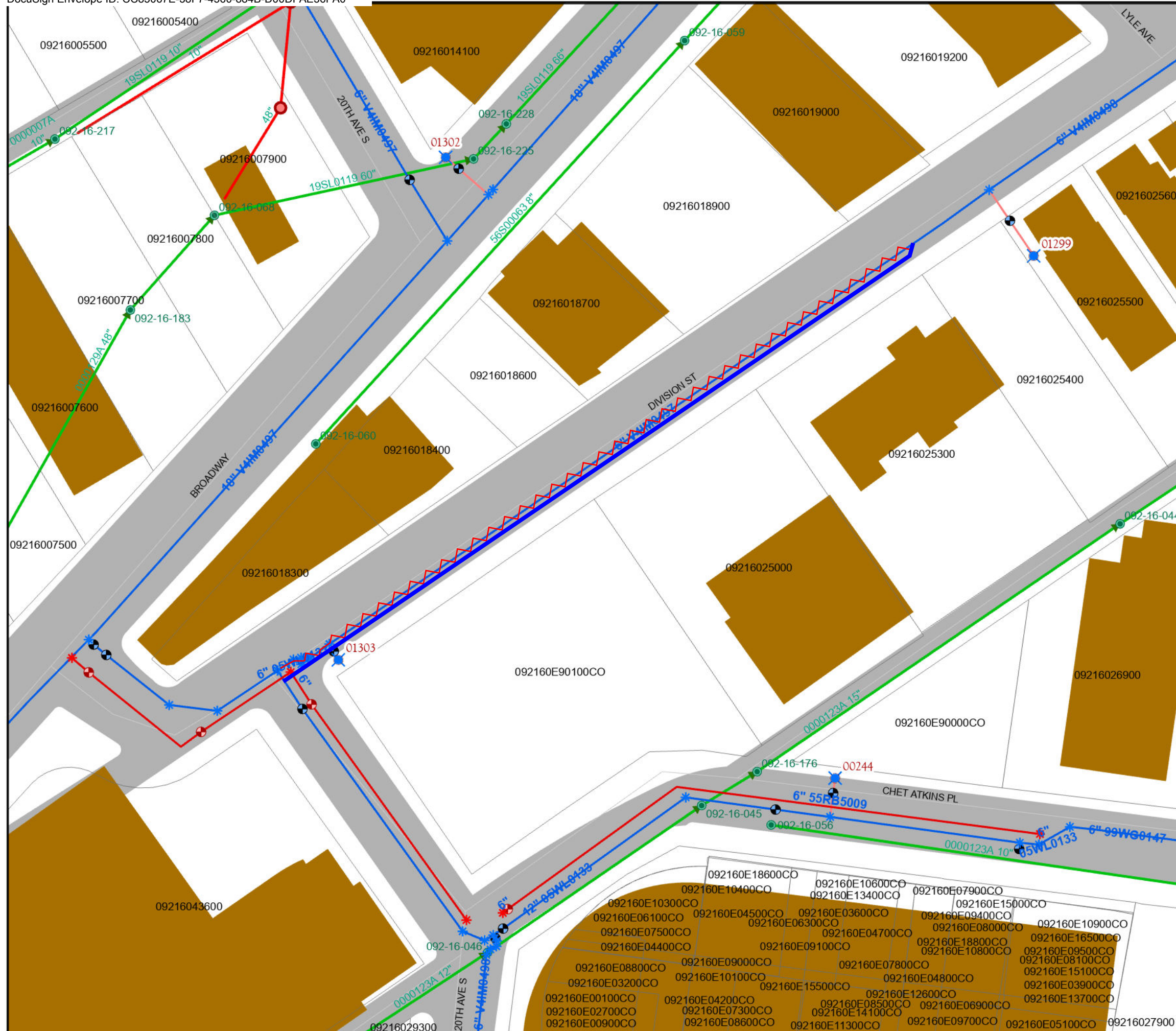

LEGEND

23WL0155



8" DIP Water Main



6" Water Main to be Abandoned

DATE: 2/22/2024

ENGINEERING FIRM: Collected Civil Engineering LLC
ENGINEER: Peter Romano, PE

COUNCIL DISTRICT: 17
PARCEL NUMBERS: 09216025300

----- CAUTION -----

THE POSITION OF THE WATER AND SANITARY SEWER MAINS SHOWN ARE APPROXIMATE AND ARE INTENDED TO SHOW THE GENERAL LOCATION ONLY. THE SIZES NOTED ARE TO THE BEST OF MWS KNOWLEDGE. IN ALL CASES WHERE PRECISE LOCATION AND MAIN SIZES ARE REQUIRED, FIELD VERIFICATION WILL BE NECESSARY.

