



**METROPOLITAN GOVERNMENT OF NASHVILLE
AND DAVIDSON COUNTY**

Metro Office Building
800 President Ronald Reagan Way
P.O. Box 196300
Nashville, TN 37219-6300

January 6, 2023

To: Stephanie James Metro Water Services

**Re: 5607 - 5611 MORROW ROAD
Planning Commission Mandatory Referral # 2022M-196ES-001
Council District #20 Mary Carolyn Roberts, Council Member**

On behalf of the Metropolitan Planning Commission, the following item, referred to the Commission as required by the Metro Charter, has been recommended for *approval* to the Metropolitan Council:

A request for the replacement of approximately 36 linear feet of 12-inch water main (DIP) and rehabilitation of one sanitary sewer manhole to serve the development at 5607-5611 Morrow Road.

The relevant Metro agencies (Metro Parks, Metro Public Works, Metro Water Services, Metro Emergency Communications, the Nashville Electric Service, Metro Finance – Public Property and the Metro Historical Commission) have reviewed the proposal and concur in the recommendation for approval. This request must be approved by the Metro Council to become effective. A sketch showing the location of the request is attached to this letter.

Conditions that apply to this approval: none

This recommendation for approval is given as set forth in the Metropolitan Planning Commission Rules and Procedures. If you have any questions about this matter, please contact Delilah Rhodes at delilah.rhodes@nashville.gov or 615-862-7208.

Sincerely,

A handwritten signature in blue ink that reads 'Lisa Milligan'.

Lisa Milligan
Land Development Manager
Metro Planning Department
cc: Metro Clerk

Re: 5607 - 5611 MORROW ROAD
Planning Commission Mandatory Referral # 2022M-196ES-001
Council District #20 Mary Carolyn Roberts, Council Member

A request for the replacement of approximately 36 linear feet of 12-inch water main (DIP) and rehabilitation of one sanitary sewer manhole to serve the development at 5607-5611 Morrow Road.

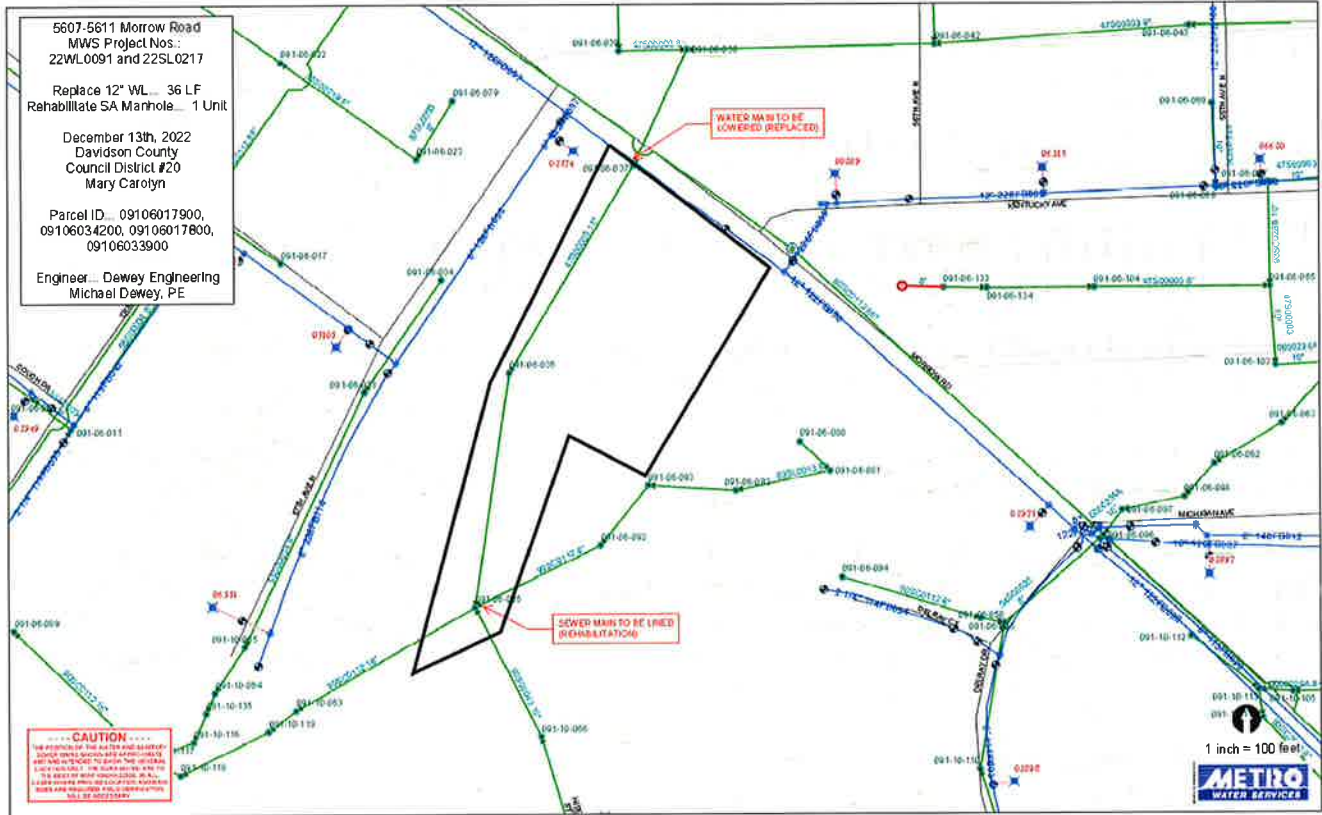

5607-5611 Morrow Road
 MWS Project Nos.:
 22WL0091 and 21SL0217

Replace 12" WL... 36 LF
 Rehabilitate SA Manhole... 1 Unit

December 13th, 2022
 Davidson County
 Council District #20
 Mary Carolyn

Parcel ID... 09106033900

Engineer... Dewey Engineering
 Michael Dewey, PE

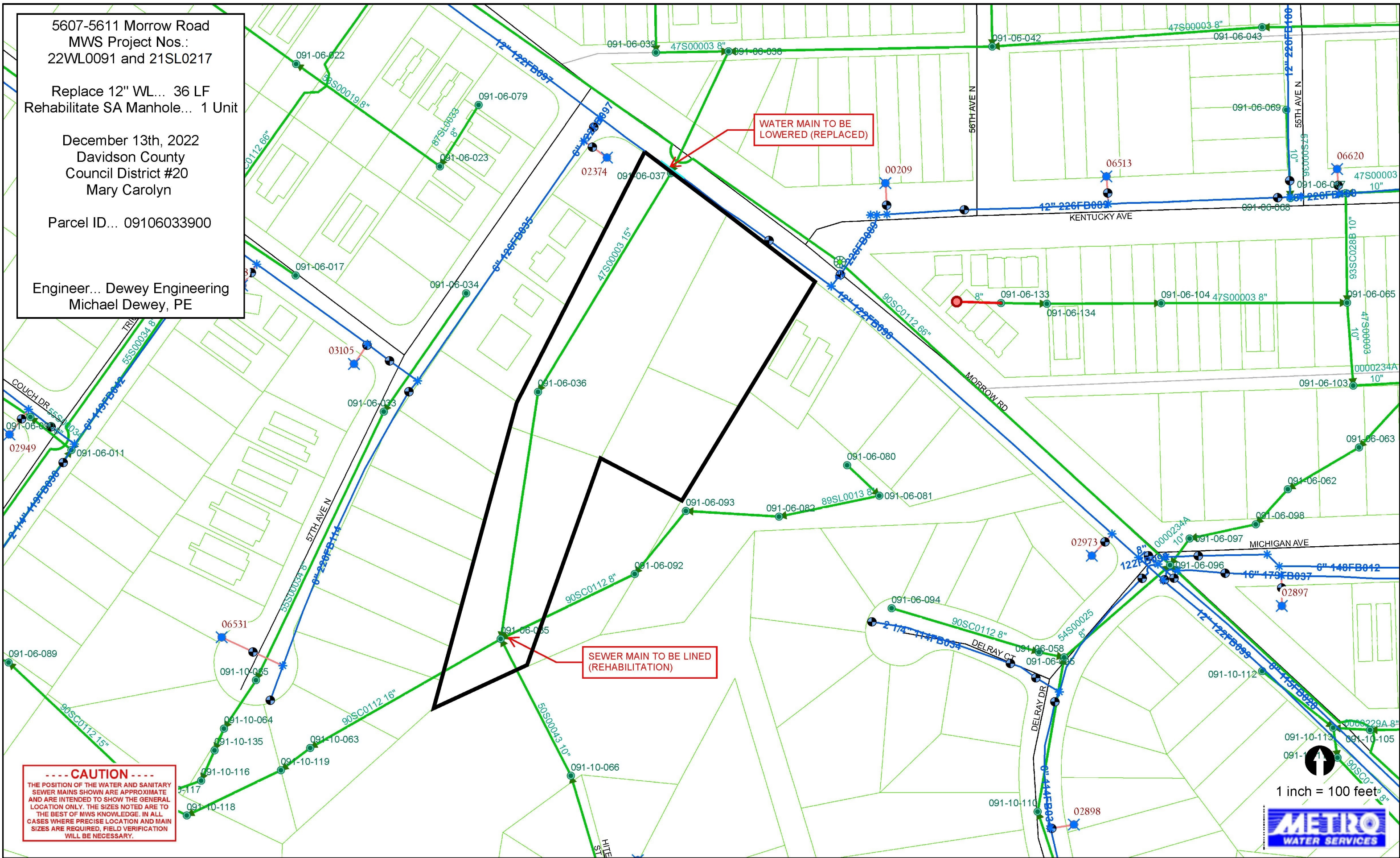

----- CAUTION -----
 THE POSITION OF THE WATER AND SANITARY
 SEWER MAINS SHOWN ARE APPROXIMATE
 AND ARE INTENDED TO SHOW THE GENERAL
 LOCATION ONLY. THE SIZES NOTED ARE TO
 THE BEST OF MWS KNOWLEDGE. IN ALL
 CASES WHERE PRECISE LOCATION AND MAIN
 SIZES ARE REQUIRED, FIELD VERIFICATION
 WILL BE NECESSARY.

1 inch = 100 feet

METRO
 WATER SERVICES