

**PARKS AT CANE RIDGE PHASE 1C  
PROJECT NOS. 23-SL-270 & 23-WL-102  
Parcel List**

<b><u>Address</u></b>	<b><u>Map/Parcels</u></b>	<b><u>Property Owners</u></b>
0 Cane Ridge	18200002700	Drapac Group 46, LLC
0 Cane Ridge	18200020700	Meritage Homes of Tennessee, Inc.
0 Cane Ridge	18200020900	Meritage Homes of Tennessee, Inc 0
0 Cane Ridge	18200023800	Meritage Homes of Tennessee, Inc
5905 Cane Ridge Road	18200017600	Priscilla G. Walker-Brewer



April 22, 2024

To: Mike Atchison Metro Water Services

**Re: Parks at Cane Ridge Phase 1C  
Planning Commission Mandatory Referral 2024M-058ES-001  
Council District #33 Antoinette Lee, Council Member**

On behalf of the Metropolitan Planning Commission, the following item, referred to the Commission as required by the Metro Charter, has been recommended for *approval* to the Metropolitan Council:

*A request for the acceptance of approximately 963 linear feet of six-inch water main (DIP), 420 linear feet of eight-inch water main (DIP), five fire hydrant assemblies and approximately 464 linear feet of eight-inch sanitary sewer main (DIP), 835 linear feet of eight-inch sanitary sewer main (PVC), 357 linear feet of two-inch sanitary sewer force main (PVC), 9 sanitary sewer manholes and any associated easements to serve the Parks at Cane Ridge – Phase 1C development.*

The relevant Metro agencies (Metro Parks, Nashville Department of Transportation, Metro Water Services, Metro Emergency Communications, the Nashville Electric Service, Metro Finance – Public Property and the Metro Historical Commission) have reviewed the proposal and concur in the recommendation for approval. This request must be approved by the Metro Council to become effective. A sketch showing the location of the request is attached to this letter.

**Conditions that apply to this approval: none**

This recommendation for approval is given as set forth in the Metropolitan Planning Commission Rules and Procedures. If you have any questions about this matter, please contact Delilah Rhodes at [Delilah.Rhodes@nashville.gov](mailto:Delilah.Rhodes@nashville.gov) or 615-862-7208

Sincerely,

A handwritten signature in black ink, appearing to read "Lisa Milligan". The signature is fluid and cursive, written over a light blue horizontal line.

Lisa Milligan  
Assistant Director Land Development  
Metro Planning Department  
cc: *Metro Clerk*

**Re: Parks at Cane Ridge Phase 1C  
Planning Commission Mandatory Referral 2024M-058ES-001  
Council District #33 Antoinette Lee, Council Member**

*A request for the acceptance of approximately 963 linear feet of six-inch water main (DIP), 420 linear feet of eight-inch water main (DIP), five fire hydrant assemblies and approximately 464 linear feet of eight-inch sanitary sewer main (DIP), 835 linear feet of eight-inch sanitary sewer main (PVC), 357 linear feet of two-inch sanitary sewer force main (PVC), 9 sanitary sewer manholes and any associated easements to serve the Parks at Cane Ridge – Phase 1C development.*

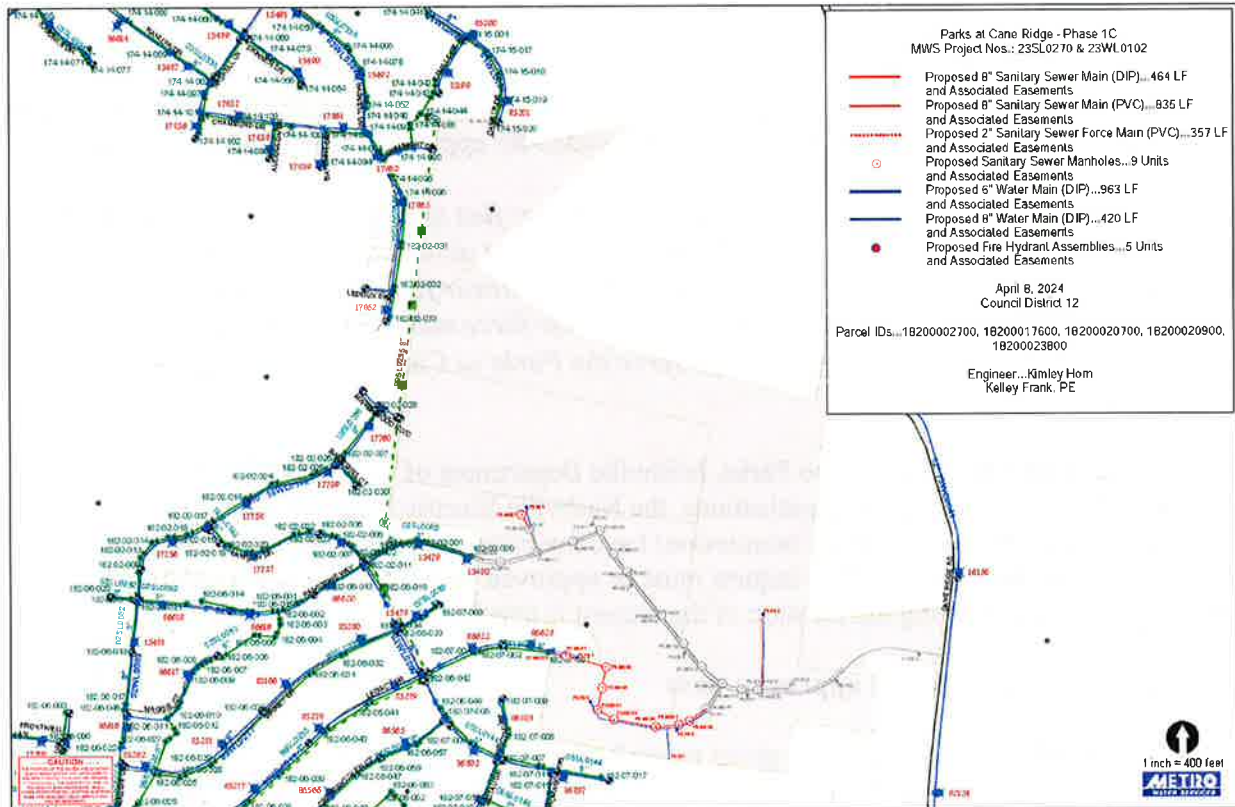

### Parks at Cane Ridge - Phase 1C MWS Project Nos.: 23SL0270 & 23WL0102

- Proposed 8" Sanitary Sewer Main (DIP)...464 LF and Associated Easements
- Proposed 8" Sanitary Sewer Main (PVC)...835 LF and Associated Easements
- Proposed 2" Sanitary Sewer Force Main (PVC)...357 LF and Associated Easements
- Proposed Sanitary Sewer Manholes...9 Units and Associated Easements
- Proposed 6" Water Main (DIP)...963 LF and Associated Easements
- Proposed 8" Water Main (DIP)...420 LF and Associated Easements
- Proposed Fire Hydrant Assemblies...5 Units and Associated Easements

April 8, 2024  
Council District 12

Parcel IDs...1820002700, 18200017600, 18200020700, 18200020900, 18200023800

Engineer...Kimley Horn  
Kelley Frank, PE

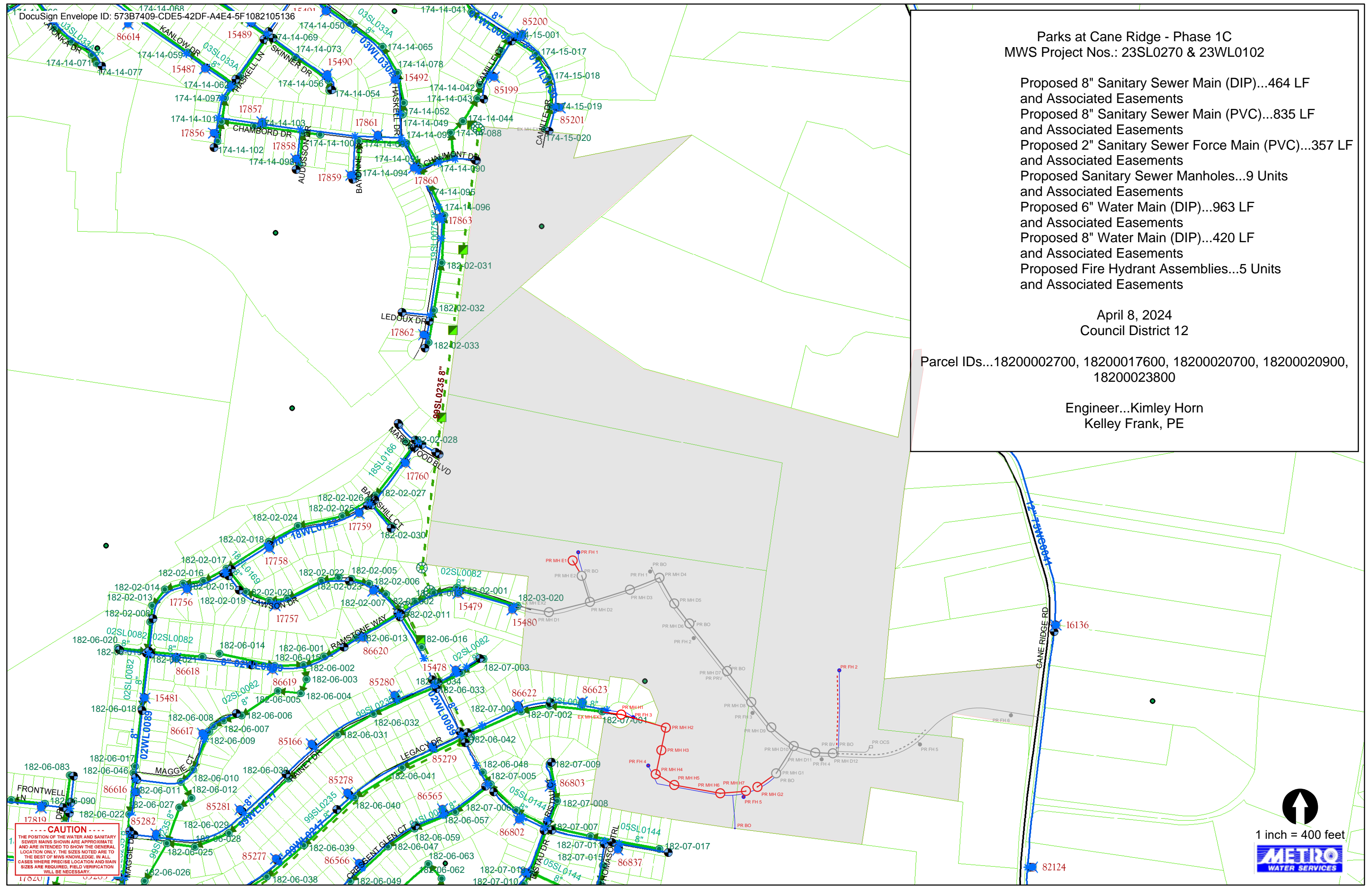

**CAUTION**

THE POSITION OF THE WATER AND SANITARY SEWER MAINS SHOWN ARE APPROXIMATE AND ARE INTENDED TO SHOW THE GENERAL LOCATION ONLY. THE SIZES NOTED ARE TO THE BEST OF MWS KNOWLEDGE. IN ALL CASES WHERE PRECISE LOCATION AND MAIN SIZES ARE REQUIRED, FIELD VERIFICATION WILL BE NECESSARY.

1 inch = 400 feet