



**METROPOLITAN GOVERNMENT OF NASHVILLE
AND DAVIDSON COUNTY**

Metro Office Building
800 President Ronald Reagan Way
P.O. Box 196300
Nashville, TN 37219-6300

August 14, 2023

To: Edward Thurman Metro Water Services

**Re: OLD HICKORY COMMUNITY CENTER
Planning Commission Mandatory Referral 2023M-135ES-001
Council District #11 Larry Hagar, Council Member**

On behalf of the Metropolitan Planning Commission, the following item, referred to the Commission as required by the Metro Charter, has been recommended for *approval* to the Metropolitan Council:

A request for the abandonment of approximately 335 linear feet of 12-inch public water main (DIP) and easements, the acceptance of approximately 335 linear feet of 12-inch public water main (DIP) and easements, and the vertical relocation of two sanitary sewer manholes to serve the Old Hickory Community Center development.

The relevant Metro agencies (Metro Parks, Metro Public Works, Metro Water Services, Metro Emergency Communications, the Nashville Electric Service, Metro Finance – Public Property and the Metro Historical Commission) have reviewed the proposal and concur in the recommendation for approval. This request must be approved by the Metro Council to become effective. A sketch showing the location of the request is attached to this letter.

Conditions that apply to this approval: none

This recommendation for approval is given as set forth in the Metropolitan Planning Commission Rules and Procedures. If you have any questions about this matter, please contact Delilah Rhodes at delilah.rhodes@nashville.gov or 615-862-7208.

Sincerely,

A handwritten signature in black ink that reads 'Lisa Milligan'.

Lisa Milligan
Land Development Manager
Metro Planning Department
cc: Metro Clerk

Old Hickory Community Center
 MWS Project Nos:
 23SL0023 & 23SL0012

Proposed 12" Water Main... 335 LF
 Abandon 12" Water Main... 335 LF
 Adjustment of Manhole Rim... 2 Units
 and
 Easements

July 25th 2023
 Davidson County
 Council District 11
 Larry Hagar

Parcel ID: 04411001100

Engineer: Kimley Horn
 Matt Schlicker, PE

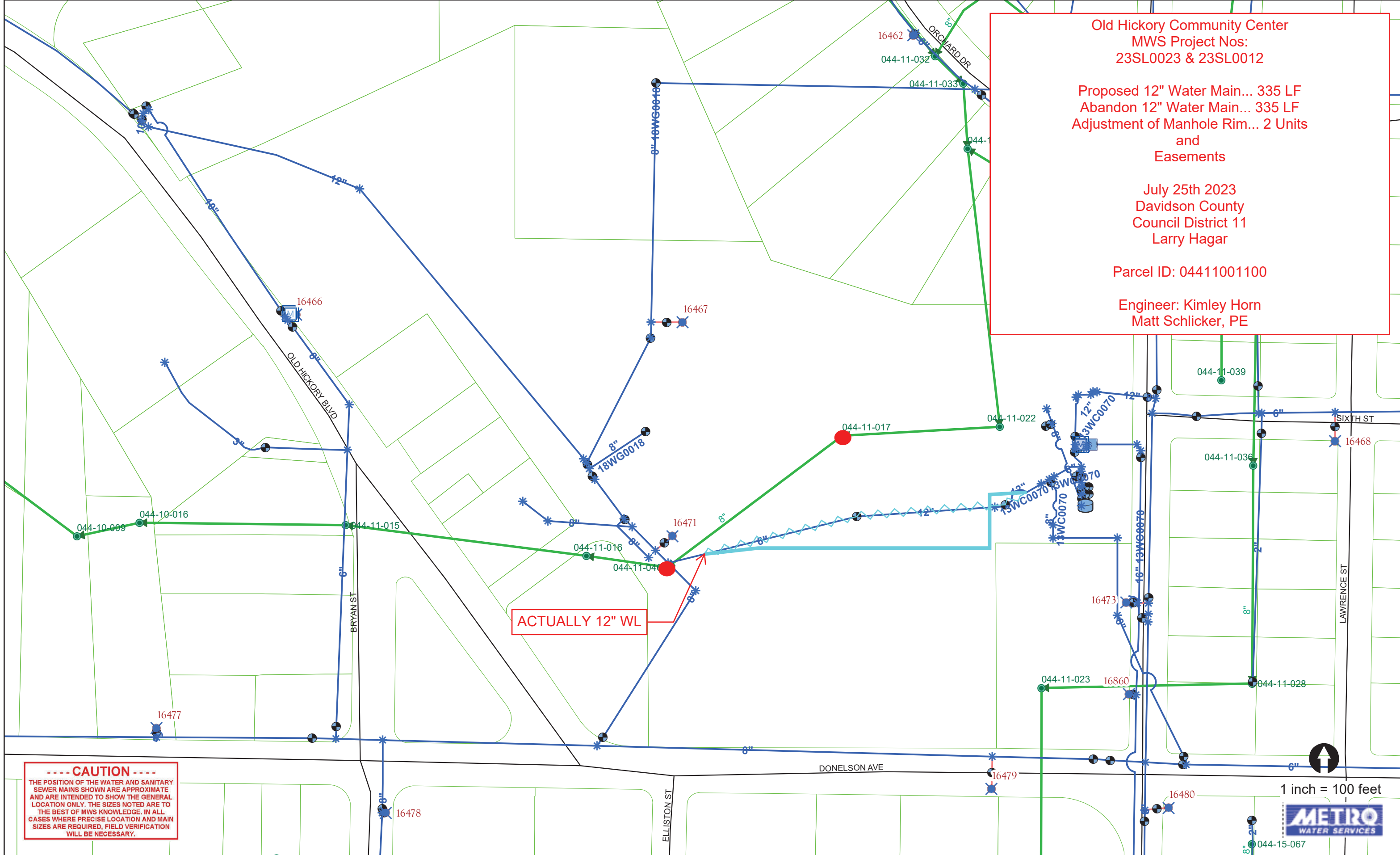

----- CAUTION -----
 THE POSITION OF THE WATER AND SANITARY
 SEWER MAINS SHOWN ARE APPROXIMATE
 AND ARE INTENDED TO SHOW THE GENERAL
 LOCATION ONLY. THE SIZES NOTED ARE TO
 THE BEST OF MWS KNOWLEDGE. IN ALL
 CASES WHERE PRECISE LOCATION AND MAIN
 SIZES ARE REQUIRED, FIELD VERIFICATION
 WILL BE NECESSARY.

1 inch = 100 feet

