

Vicinity Sketch

MWS Project No.: 20SL0069

----- CAUTION -----
 THE POSITION OF THE WATER AND SANITARY SEWER MAINS SHOWN ARE APPROXIMATE AND ARE INTENDED TO SHOW THE GENERAL LOCATION ONLY. THE SIZES NOTED ARE TO THE BEST OF MWS KNOWLEDGE. IN ALL CASES WHERE PRECISE LOCATION AND MAIN SIZES ARE REQUIRED, FIELD VERIFICATION WILL BE NECESSARY.

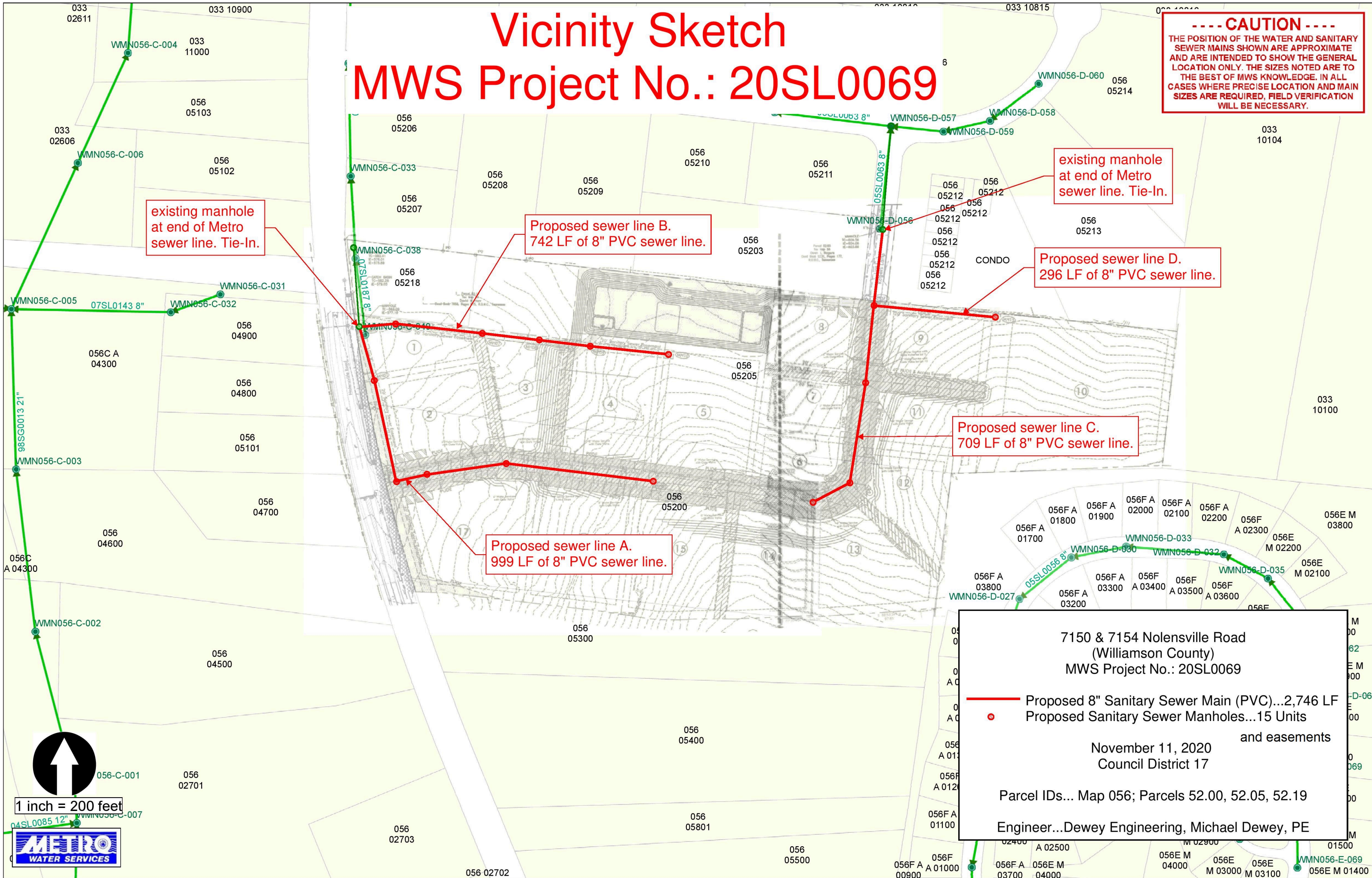

1 inch = 200 feet

7150 & 7154 Nolensville Road
 (Williamson County)
 MWS Project No.: 20SL0069

Proposed 8" Sanitary Sewer Main (PVC)...2,746 LF
 Proposed Sanitary Sewer Manholes...15 Units
 and easements

November 11, 2020
 Council District 17

Parcel IDs... Map 056; Parcels 52.00, 52.05, 52.19

Engineer...Dewey Engineering, Michael Dewey, PE