



METROPOLITAN GOVERNMENT OF NASHVILLE

AND DAVIDSON COUNTY

Metro Office Building
800 President Ronald Reagan Way
P.O. Box 196300
Nashville, TN 37219-6300

October 28, 2022

To: Mike Atchison, Metro Water Services

**Re: METRO PERMANENT SUPPORTIVE HOUSING
Planning Commission Mandatory Referral #2022M-152ES-001
Council District #19 Freddie O'Connell, Council Member**

On behalf of the Metropolitan Planning Commission, the following item, referred to the Commission as required by the Metro Charter, has been recommended for *approval* to the Metropolitan Council:

A request for the relocation of one fire hydrant assembly, the abandonment of approximately 115 linear feet of 12-inch and 8-inch sanitary sewer mains and one sanitary sewer manhole, and the acceptance of 115 linear feet of 12-inch sanitary sewer mains (DIP) and two sanitary sewer manholes to serve the Metro Permanent Supportive Housing development.

The relevant Metro agencies (Metro Parks, Metro Public Works, Metro Water Services, Metro Emergency Communications, the Nashville Electric Service, Metro Finance – Public Property and the Metro Historical Commission) have reviewed the proposal and concur in the recommendation for approval. This request must be approved by the Metro Council to become effective. A sketch showing the location of the request is attached to this letter.

Conditions that apply to this approval: none

This recommendation for approval is given as set forth in the Metropolitan Planning Commission Rules and Procedures. If you have any questions about this matter, please contact Delilah Rhodes at delilah.rhodes@nashville.gov or 615-862-7208.

Sincerely,

A handwritten signature in blue ink, appearing to read "Lisa Milligan".

Lisa Milligan
Land Development Manager
Metro Planning Department
cc: Metro Clerk

**Re: METRO PERMANENT SUPPORTIVE HOUSING
Planning Commission Mandatory Referral #2022M-152ES-001
Council District #19 Freddie O'Connell, Council Member**

A request for the relocation of one fire hydrant assembly, the abandonment of approximately 115 linear feet of 12-inch and 8-inch sanitary sewer mains and one sanitary sewer manhole, and the acceptance of 115 linear feet of 12-inch sanitary sewer mains (DIP) and two sanitary sewer manholes to serve the Metro Permanent Supportive Housing development.

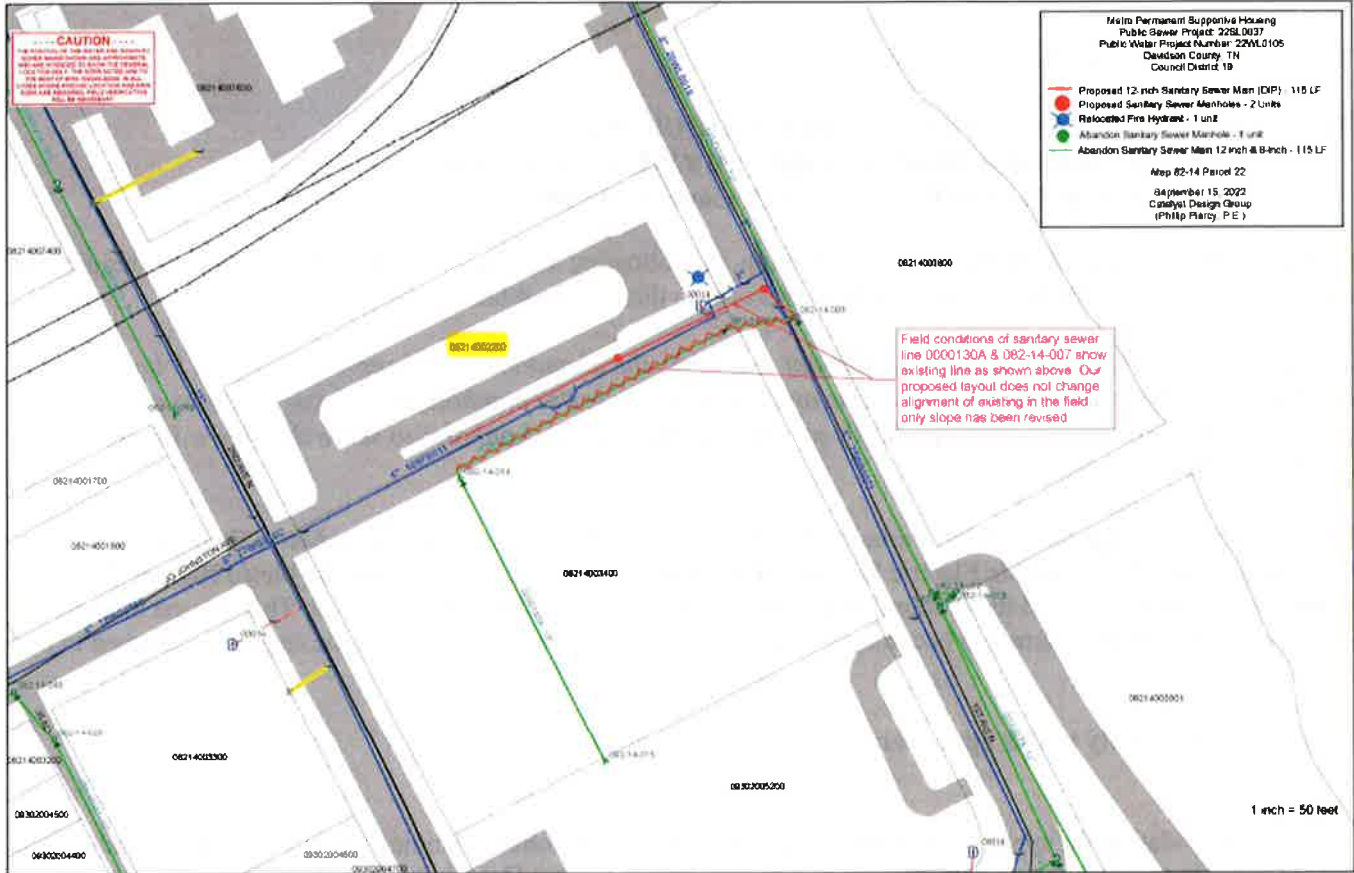

-----CAUTION-----
THE POSITION OF THE WATER AND SANITARY SEWER MAINS SHOWN ARE APPROXIMATE AND ARE INTENDED TO SHOW THE GENERAL LOCATION ONLY. THE SIZES NOTED ARE TO THE BEST OF MWS KNOWLEDGE. IN ALL CASES WHERE PRECISE LOCATION AND MAIN SIZES ARE REQUIRED, FIELD VERIFICATION WILL BE NECESSARY.

Metro Permanent Supportive Housing
Public Sewer Project: 22SL0037
Public Water Project Number: 22WL0105
Davidson County, TN
Council District 19

- Proposed 12-inch Sanitary Sewer Main (DIP) - 115 LF
- Proposed Sanitary Sewer Manholes - 2 Units
- Relocated Fire Hydrant - 1 unit
- Abandon Sanitary Sewer Manhole - 1 unit
- Abandon Sanitary Sewer Main 12 inch & 8-inch - 115 LF

Map 82-14 Parcel 22
September 15, 2022
Catalyst Design Group
(Phillip Piercy, P.E.)

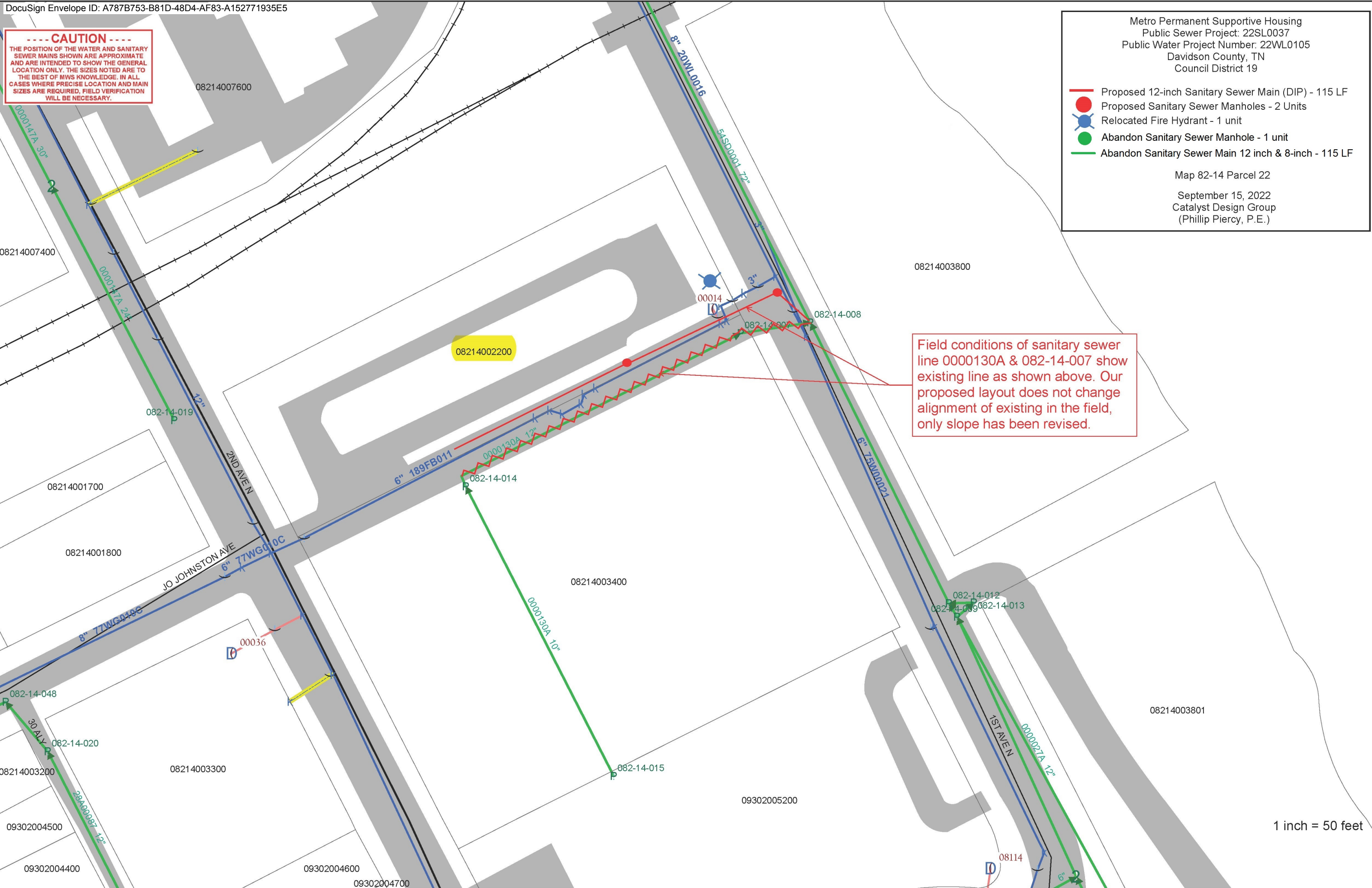

Field conditions of sanitary sewer line 0000130A & 082-14-007 show existing line as shown above. Our proposed layout does not change alignment of existing in the field, only slope has been revised.

1 inch = 50 feet