



**METROPOLITAN GOVERNMENT
OF NASHVILLE AND DAVIDSON COUNTY**

Planning Department
Metro Office Building
800 Second Avenue South
Nashville, Tennessee 37201

January 28, 2021

To: Mike Atchison, Metro Water Services

Re: Ashton Park
Planning Commission Mandatory Referral #2021M-009ES-001
Council District #12 – Erin Evans, Council Member

On behalf of the Metropolitan Planning Commission, the following item, referred to the Commission as required by the Metro Charter, has been recommended for *approval* to the Metropolitan Council:

A request for the acceptance of approximately 1,734 linear feet of 3-inch sanitary sewer force main (PVC), 1,966 linear feet of 2.5-inch sanitary sewer force main (PVC), 1,122 linear feet of 2-inch sanitary sewer force main, 5,016 linear feet of 8-inch water main (DIP), 180 linear feet of 6-inch water main (DIP), 12 fire hydrant assemblies and easements (see sketch for details) to serve the Ashton Park development (MWS proj. nos. 20-SL-239 and 20-WL-119).

The relevant Metro agencies (Metro Parks, Metro Public Works, Metro Water Services, Metro Emergency Communications, the Nashville Electric Service, Metro Finance – Public Property and the Metro Historical Commission) have reviewed the proposal and concur in the recommendation for approval. This request must be approved by the Metro Council to become effective. A sketch showing the location of the request is attached to this letter.

Conditions that apply to this approval: None.

This recommendation for approval is given as set forth in the Metropolitan Planning Commission Rules and Procedures. If you have any questions about this matter, please contact Sharon O'Conner at Sharon.oconner@nashville.gov or 615-862-7208.

Sincerely,

A handwritten signature in black ink that reads 'Robert Leeman'.

Robert Leeman, AICP
Deputy Director
Metro Planning Department
cc: *Metro Clerk, Elizabeth Waites*

Re: Ashton Park
Planning Commission Mandatory Referral #2021M-009ES-001
Council District #12 – Erin Evans, Council Member

A request for the acceptance of approximately 1,734 linear feet of 3-inch sanitary sewer force main (PVC), 1,966 linear feet of 2.5-inch sanitary sewer force main (PVC), 1,122 linear feet of 2-inch sanitary sewer force main, 5,016 linear feet of 8-inch water main (DIP), 180 linear feet of 6-inch water main (DIP), 12 fire hydrant assemblies and easements (see sketch for details) to serve the Ashton Park development (MWS proj. nos. 20-SL-239 and 20-WL-119).



Ashton Park
Project Nos: 20SL0239 and 20WL0119 (2020056537 and 2020056536)

- Proposed 3-Inch Sanitary Force Main...1734 LF
- Proposed 2.5-Inch Sanitary Force Main...1966 LF
- Proposed 2-Inch Sanitary Force Main... 1122 LF
- Proposed 8-Inch Water Main (DIP)...5016 LF
- Proposed 6-Inch Water Main (DIP)...180 LF
- Proposed Fire Hydrant Assemblies... 12 Units

(and easements)
 January 15, 2021 Council District 12 Tax Map: 110 Parcel: 49
 Tax Map: 98, Parcels 65, 88

ENGINEER: CSDG
(Sean DeCoster, P.E.)

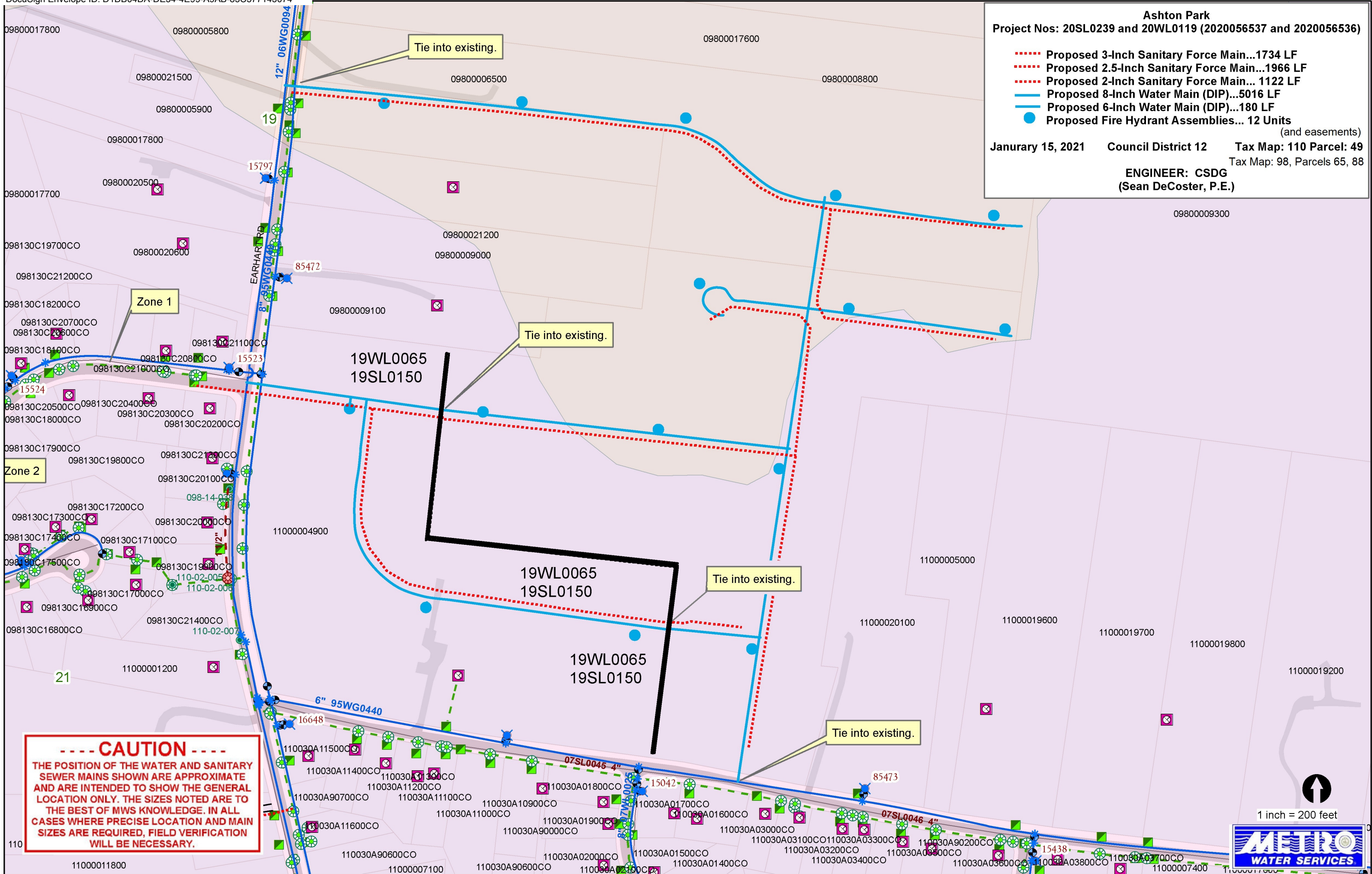

----- CAUTION -----

THE POSITION OF THE WATER AND SANITARY SEWER MAINS SHOWN ARE APPROXIMATE AND ARE INTENDED TO SHOW THE GENERAL LOCATION ONLY. THE SIZES NOTED ARE TO THE BEST OF MWS KNOWLEDGE. IN ALL CASES WHERE PRECISE LOCATION AND MAIN SIZES ARE REQUIRED, FIELD VERIFICATION WILL BE NECESSARY.

1 inch = 200 feet

