



**METROPOLITAN GOVERNMENT OF NASHVILLE
AND DAVIDSON COUNTY**

Metro Office Building
800 President Ronald Reagan Way
P.O. Box 196300
Nashville, TN 37219-6300

May 31, 2023

To: Mike Atchison Metro Water Services

**Re: ROSE MONTE PHASE 4
Planning Commission Mandatory Referral 2023M-085ES-001
Council District #04 Robert Swope, Council Member**

On behalf of the Metropolitan Planning Commission, the following item, referred to the Commission as required by the Metro Charter, has been recommended for *approval* to the Metropolitan Council:

A request for the acceptance of approximately 1,702 linear feet of 8-inch water main (DIP), 4 fire hydrant assemblies, approximately 2,597 linear feet of 8-inch sewer main (PVC), 187 linear feet of 8-inch sewer main (DIP), 20 sanitary sewer manholes, and associated easements to serve the Rose Monte Phase 4 development.

The relevant Metro agencies (Metro Parks, Metro Public Works, Metro Water Services, Metro Emergency Communications, the Nashville Electric Service, Metro Finance – Public Property and the Metro Historical Commission) have reviewed the proposal and concur in the recommendation for approval. This request must be approved by the Metro Council to become effective. A sketch showing the location of the request is attached to this letter.

Conditions that apply to this approval: none

This recommendation for approval is given as set forth in the Metropolitan Planning Commission Rules and Procedures. If you have any questions about this matter, please contact Delilah Rhodes at delilah.rhodes@nashville.gov or 615-862-7208.

Sincerely,

A handwritten signature in blue ink that reads "Lisa Milligan".

Lisa Milligan
Land Development Manager
Metro Planning Department
cc: Metro Clerk

**Re: ROSE MONTE PHASE 4
 Planning Commission Mandatory Referral # 2023M-085ES-001
 Council District #04 Robert Swope, Council Member**

A request for the acceptance of approximately 1,702 linear feet of 8-inch water main (DIP), 4 fire hydrant assemblies, approximately 2,597 linear feet of 8-inch sewer main (PVC), 187 linear feet of 8-inch sewer main (DIP), 20 sanitary sewer manholes, and associated easements to serve the Rose Monte Phase 4 development.

CAUTION
 THE POSITION OF THE WATER AND SANITARY SEWER MAINS SHOWN ARE APPROXIMATE AND ARE INTENDED TO SHOW THE GENERAL LOCATION ONLY. THE SIZES NOTED ARE TO THE BEST OF MAN'S KNOWLEDGE. IN ALL CASES WHERE PRECISE LOCATION AND MAIN SIZES ARE REQUIRED, FIELD VERIFICATION WILL BE NECESSARY.

ROSE MONTE - PHASE 4
 22-001-0096 & 22-01-0122
 FINAL PUD
 DAVIDSON COUNTY, TN
 COUNCIL DISTRICT 4

- Proposed 8-inch (PVC) Sanitary Sewer Main...2597 LF
- Proposed 8-inch (DIP) Sanitary Sewer Main...187 LF
- Proposed Sanitary Sewer Manholes...20 Units
- Proposed 8-inch Water Main (DIP)...1702 LF
- Proposed Fire Hydrant Assemblies...4 Units and easements

15100030700
 OCTOBER 25, 2022
 Energy Land & Infrastructure
 Clay Wallace, P.E.

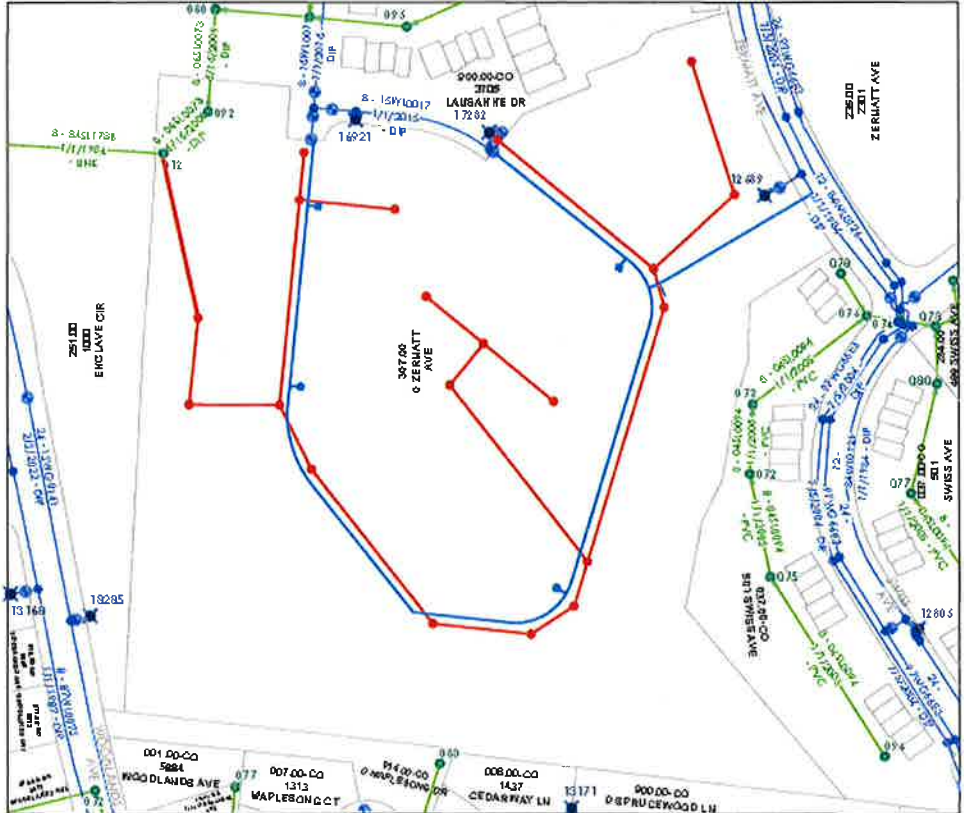

CAUTION

THE POSITION OF THE WATER AND SANITARY SEWER MAINS SHOWN ARE APPROXIMATE AND ARE INTENDED TO SHOW THE GENERAL LOCATION ONLY. THE SIZES NOTED ARE TO THE BEST OF MWS KNOWLEDGE. IN ALL CASES WHERE PRECISE LOCATION AND MAIN SIZES ARE REQUIRED, FIELD VERIFICATION WILL BE NECESSARY.

ROSE MONTE - PHASE 4
 22-WL-0056 & 22-SL-0122
 FINAL PUD
 DAVIDSON COUNTY, TN
 COUNCIL DISTRICT 4

- Proposed 8-inch (PVC) Sanitary Sewer Main...2597 LF
- Proposed 8-inch (DIP) Sanitary Sewer Main...187 LF
- Proposed Sanitary Sewer Manholes...20 Units
- Proposed 8-inch Water Main (DIP)...1702 LF
- Proposed Fire Hydrant Assemblies...4 Units and easements

16100030700
 OCTOBR 26, 2022
 Energy Land & Infrastructure
 (Clay Wallace, P.E.)

