



April 1, 2024

To: Mike Atchison Metro Water Services

**Re: Hudson Row  
Planning Commission Mandatory Referral 2024M-047ES-001  
Council District #02 Kyonzte Toombs, Council Member**

On behalf of the Metropolitan Planning Commission, the following item, referred to the Commission as required by the Metro Charter, has been recommended for *approval* to the Metropolitan Council:

*A request for the replacement and realignment of approximately 50 linear feet of six-inch water main (DIP) to serve the Hudson Row development.*

The relevant Metro agencies (Metro Parks, Nashville Department of Transportation, Metro Water Services, Metro Emergency Communications, the Nashville Electric Service, Metro Finance – Public Property and the Metro Historical Commission) have reviewed the proposal and concur in the recommendation for approval. This request must be approved by the Metro Council to become effective. A sketch showing the location of the request is attached to this letter.

**Conditions that apply to this approval: none**

This recommendation for approval is given as set forth in the Metropolitan Planning Commission Rules and Procedures. If you have any questions about this matter, please contact Delilah Rhodes at [Delilah.Rhodes@nashville.gov](mailto:Delilah.Rhodes@nashville.gov) or 615-862-7208

Sincerely,

A handwritten signature in blue ink that reads "Lisa Milligan". The signature is written in a cursive, flowing style.

Lisa Milligan  
Assistant Director Land Development  
Metro Planning Department  
cc: *Metro Clerk*

**Re: Hudson Row  
Planning Commission Mandatory Referral 2024M-047ES-001  
Council District #02 Kyonzte Toombs, Council Member**

*A request for the replacement and realignment of approximately 50 linear feet of six-inch water main (DIP) to serve the Hudson Row development.*

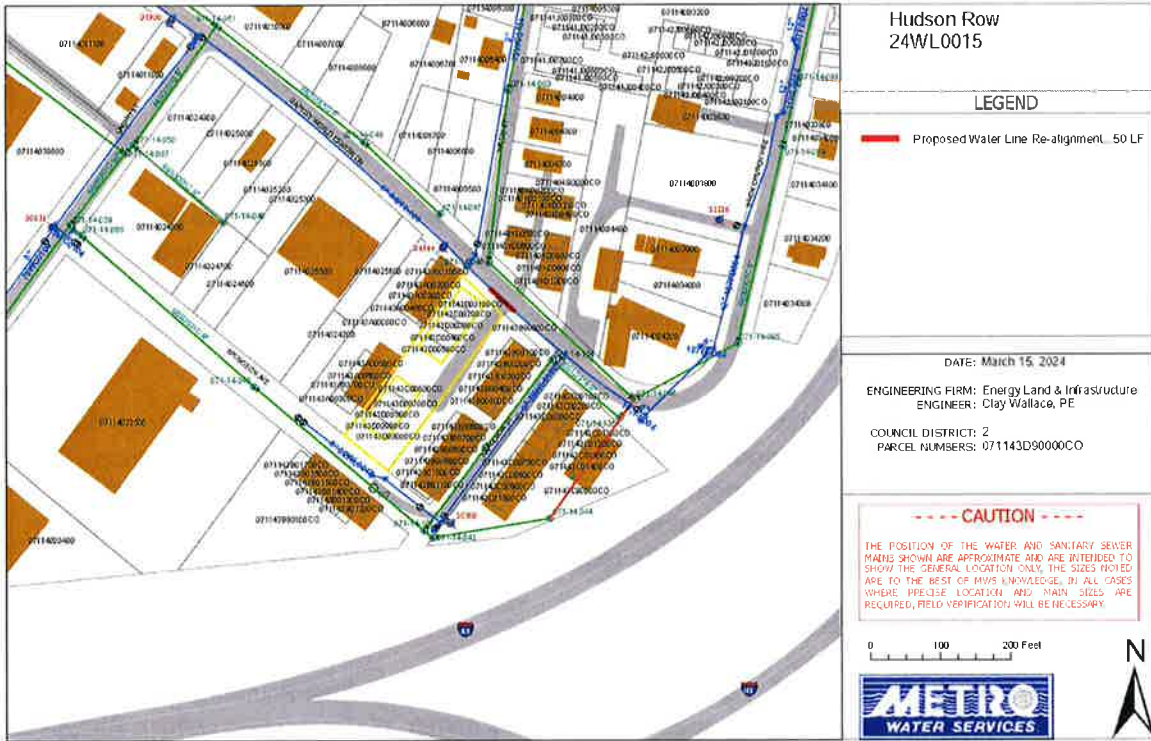

# Hudson Row 24WL0015

## LEGEND

 Proposed Water Line Re-alignment...50 LF

DATE: March 15, 2024

ENGINEERING FIRM: Energy Land & Infrastructure  
ENGINEER: Clay Wallace, PE

COUNCIL DISTRICT: 2  
PARCEL NUMBERS: 071143D90000CO

**----- CAUTION -----**

THE POSITION OF THE WATER AND SANITARY SEWER MAINS SHOWN ARE APPROXIMATE AND ARE INTENDED TO SHOW THE GENERAL LOCATION ONLY. THE SIZES NOTED ARE TO THE BEST OF MWS KNOWLEDGE. IN ALL CASES WHERE PRECISE LOCATION AND MAIN SIZES ARE REQUIRED, FIELD VERIFICATION WILL BE NECESSARY.

0 100 200 Feet

