

**----- CAUTION -----**  
THE POSITION OF THE WATER AND SANITARY SEWER MAINS SHOWN ARE APPROXIMATE AND ARE INTENDED TO SHOW THE GENERAL LOCATION ONLY. THE SIZES NOTED ARE TO THE BEST OF MWS KNOWLEDGE. IN ALL CASES WHERE PRECISE LOCATION AND MAIN SIZES ARE REQUIRED, FIELD VERIFICATION WILL BE NECESSARY.

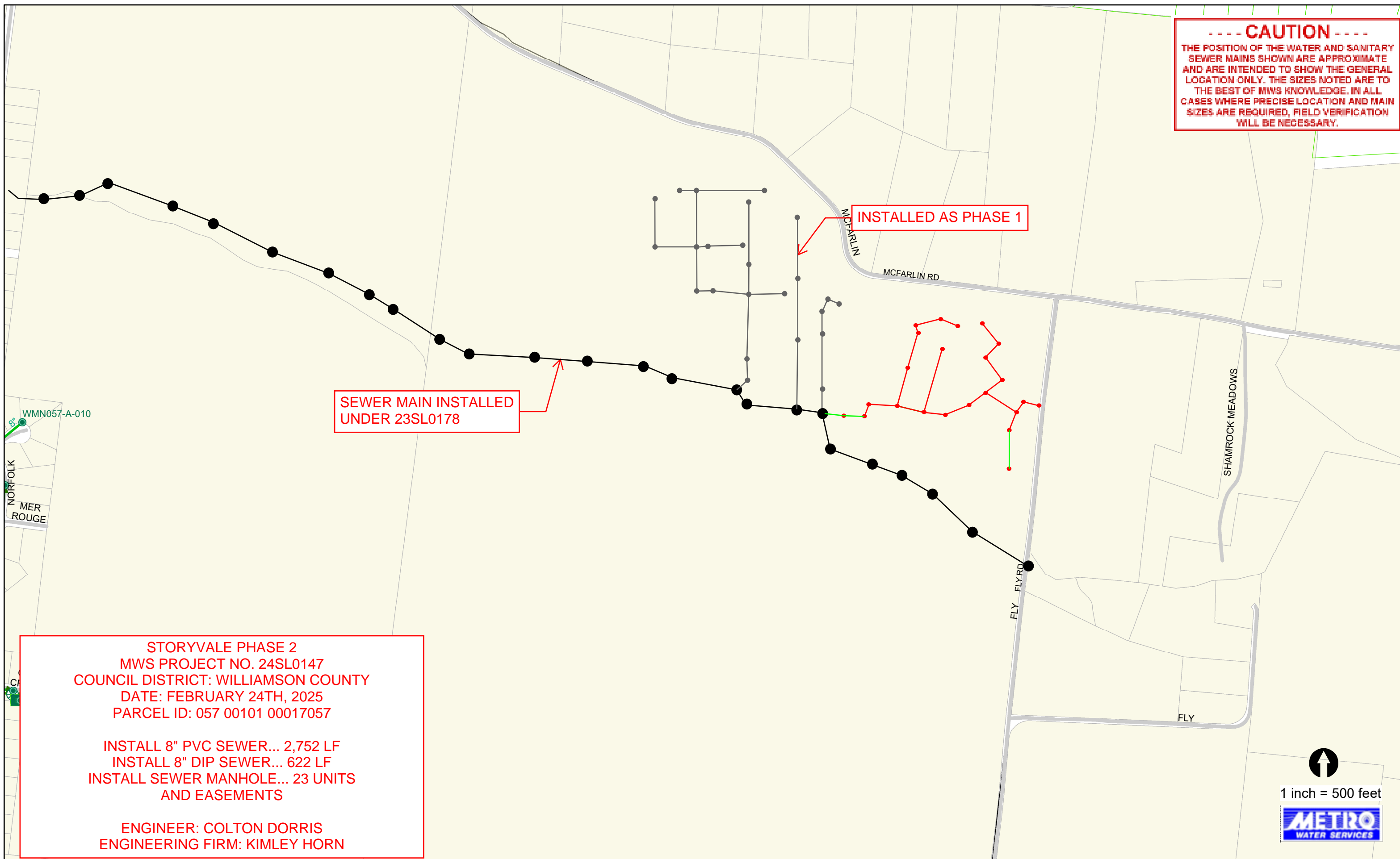

SEWER MAIN INSTALLED UNDER 23SL0178

INSTALLED AS PHASE 1

**STORYVALE PHASE 2**  
MWS PROJECT NO. 24SL0147  
COUNCIL DISTRICT: WILLIAMSON COUNTY  
DATE: FEBRUARY 24TH, 2025  
PARCEL ID: 057 00101 00017057

INSTALL 8" PVC SEWER... 2,752 LF  
INSTALL 8" DIP SEWER... 622 LF  
INSTALL SEWER MANHOLE... 23 UNITS  
AND EASEMENTS

ENGINEER: COLTON DORRIS  
ENGINEERING FIRM: KIMLEY HORN

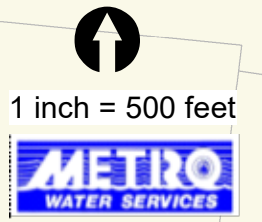



March 7, 2025

To: Stephanie James Metro Water Services

Re: **Storyvale Phase 2  
Planning Commission Mandatory Referral 2025M-027ES-001**

On behalf of the Metropolitan Planning Commission, the following item, referred to the Commission as required by the Metro Charter, has been recommended for *approval* to the Metropolitan Council:

*A request for the acceptance of approximately 622 linear feet of eight-inch sanitary sewer main (DIP), 2,752 linear feet of eight-inch sanitary sewer main (PVC), 23 sewer manholes and any associated easements to serve the Storyvale Phase 2 development.*

The relevant Metro agencies (Metro Parks, Nashville Department of Transportation, Metro Water Services, Metro Emergency Communications, the Nashville Electric Service, General Services – Public Property and the Metro Historical Commission) have reviewed the proposal and concur in the recommendation for approval. This request must be approved by the Metro Council to become effective. A sketch showing the location of the request is attached to this letter.

**Conditions that apply to this approval: none**

This recommendation for approval is given as set forth in the Metropolitan Planning Commission Rules and Procedures. If you have any questions about this matter, please contact Delilah Rhodes at [Delilah.Rhodes@nashville.gov](mailto:Delilah.Rhodes@nashville.gov) or 615-862-7208

Sincerely,

A handwritten signature in blue ink that reads "Lisa Milligan".

Lisa Milligan  
Assistant Director Land Development  
Metro Planning Department  
cc: *Metro Clerk*

**Re: Storyvale Phase 2  
Planning Commission Mandatory Referral 2025M-027ES-001**

*A request for the acceptance of approximately 622 linear feet of eight-inch sanitary sewer main (DIP), 2,752 linear feet of eight-inch sanitary sewer main (PVC), 23 sewer manholes and any associated easements to serve the Storyvale Phase 2 development.*

