

N A S H V I L L E  
P L A N N I N G

August 8, 2024

To: Mike Atchison Metro Water Services

**Re: Watkins South  
Planning Commission Mandatory Referral 2024M-099ES-001  
Council District #02 Kyonzté Toombs, Council Member**

On behalf of the Metropolitan Planning Commission, the following item, referred to the Commission as required by the Metro Charter, has been recommended for *approval* to the Metropolitan Council:

*A request for the abandonment of approximately 312 linear feet of 15-inch sanitary sewer mains (PVC), approximately 378 linear feet of 18-inch sanitary sewer mains (PVC), and two sanitary sewer manholes, and the acceptance of approximately 312 linear feet of new 15-inch sanitary sewer mains (PVC), approximately 393 linear feet of new 18-inch sanitary sewer mains (PVC), and three new sanitary sewer manholes. Construction will occur within the extents of the existing easements. The purpose of the project is to increase the slope of the sanitary sewer main pipeline.*

The relevant Metro agencies (Metro Parks, Nashville Department of Transportation, Metro Water Services, Metro Emergency Communications, the Nashville Electric Service, Metro Finance – Public Property and the Metro Historical Commission) have reviewed the proposal and concur in the recommendation for approval. This request must be approved by the Metro Council to become effective. A sketch showing the location of the request is attached to this letter.

**Conditions that apply to this approval: none**

This recommendation for approval is given as set forth in the Metropolitan Planning Commission Rules and Procedures. If you have any questions about this matter, please contact Christopher Paulsen at [Christopher.paulsen@nashville.gov](mailto:Christopher.paulsen@nashville.gov) or 615-880-2452.

Sincerely,



Lisa Milligan  
Assistant Director Land Development  
Metro Planning Department  
cc: *Metro Clerk*

**Re: Watkins South  
 Planning Commission Mandatory Referral 2024M-099ES-001  
 Council District #02 Kyonzté Toombs, Council Member**

*A request for the abandonment of approximately 312 linear feet of 15-inch sanitary sewer mains (PVC), approximately 378 linear feet of 18-inch sanitary sewer mains (PVC), and two sanitary sewer manholes, and the acceptance of approximately 312 linear feet of new 15-inch sanitary sewer mains (PVC), approximately 393 linear feet of new 18-inch sanitary sewer mains (PVC), and three new sanitary sewer manholes. Construction will occur within the extents of the existing easements. The purpose of the project is to increase the slope of the sanitary sewer main pipeline.*

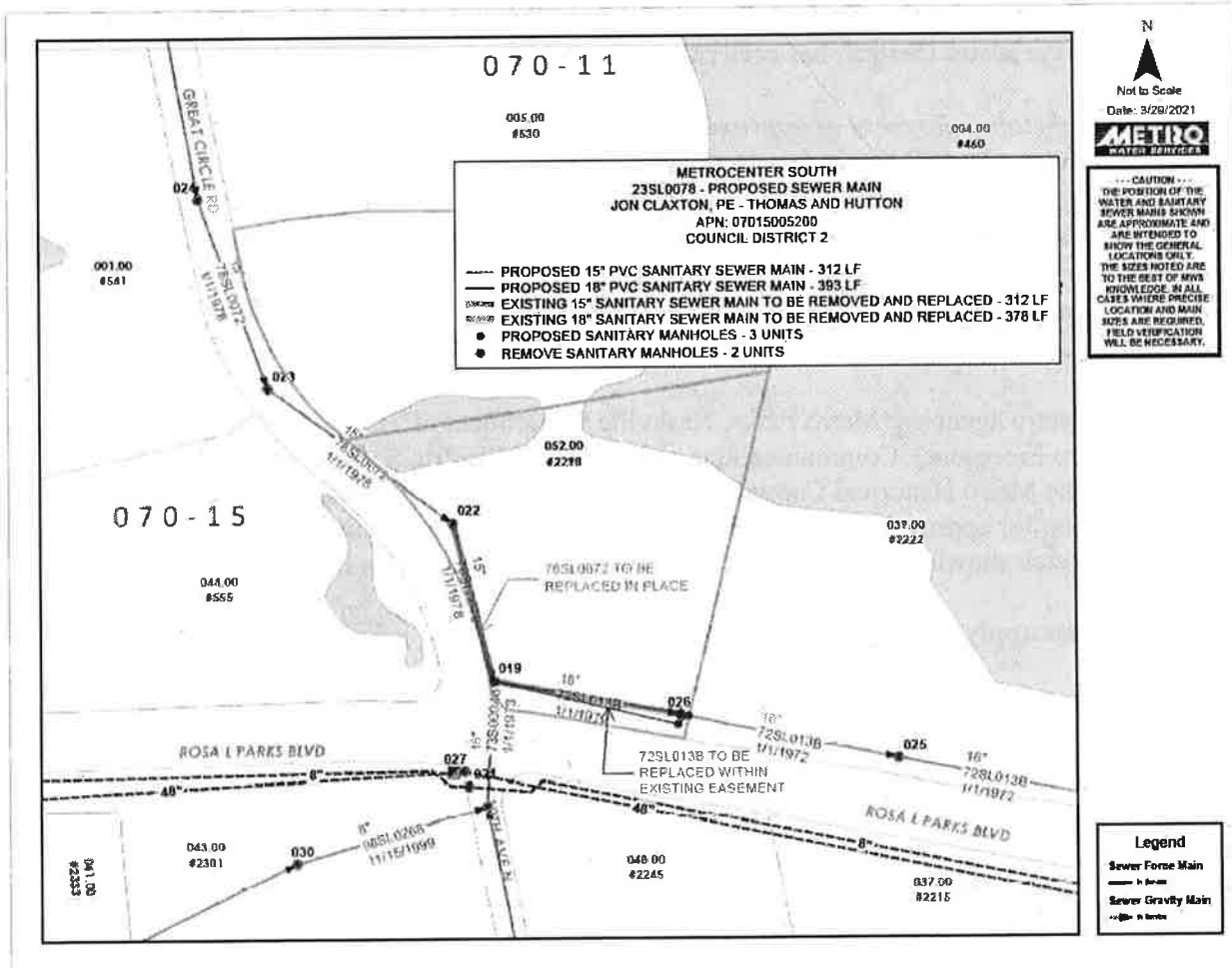



070-11

005.00  
#530

004.00  
#460

001.00  
#541

GREAT CIRCLE RD

024

18" SL0072  
1/1/1978

023

15" SL0072  
1/1/1978

052.00  
#2298

070-15

044.00  
#555

022

15" SL0072  
1/1/1978

78SL0072 TO BE REPLACED IN PLACE

019

18" SL013B  
1/1/1972

72SL013B TO BE REPLACED WITHIN EXISTING EASEMENT

026

18" SL013B  
1/1/1972

025

18" SL013B  
1/1/1972

ROSA L PARKS BLVD

48"

48"

ROSA L PARKS BLVD

8"

030

8" SL0268  
11/15/1999

048.00  
#2245

027

16" SL0078  
1/1/1978

021

037.00  
#2215

041.00  
#2333

043.00  
#2301

METROCENTER SOUTH  
23SL0078 - PROPOSED SEWER MAIN  
JON CLAXTON, PE - THOMAS AND HUTTON  
APN: 07015005200  
COUNCIL DISTRICT 2

- PROPOSED 15" PVC SANITARY SEWER MAIN - 312 LF
- PROPOSED 18" PVC SANITARY SEWER MAIN - 393 LF
- EXISTING 15" SANITARY SEWER MAIN TO BE REMOVED AND REPLACED - 312 LF
- EXISTING 18" SANITARY SEWER MAIN TO BE REMOVED AND REPLACED - 378 LF
- PROPOSED SANITARY MANHOLES - 3 UNITS
- REMOVE SANITARY MANHOLES - 2 UNITS

--- CAUTION ---  
THE POSITION OF THE WATER AND SANITARY SEWER MAINS SHOWN ARE APPROXIMATE AND ARE INTENDED TO SHOW THE GENERAL LOCATIONS ONLY. THE SIZES NOTED ARE TO THE BEST OF MWS KNOWLEDGE. IN ALL CASES WHERE PRECISE LOCATION AND MAIN SIZES ARE REQUIRED, FIELD VERIFICATION WILL BE NECESSARY.

**Legend**

Sewer Force Main  
 In Service

Sewer Gravity Main  
 In Service