



**METROPOLITAN GOVERNMENT OF NASHVILLE
AND DAVIDSON COUNTY**

Metro Office Building
800 President Ronald Reagan Way
P.O. Box 196300
Nashville, TN 37219-6300

May 31, 2023

To: Stephanie James Metro Water Services

Re: **1306 RURAL HILL ROAD**
Planning Commission Mandatory Referral 2023M-084ES-001
Council District #32 Joy Styles, Council Member

On behalf of the Metropolitan Planning Commission, the following item, referred to the Commission as required by the Metro Charter, has been recommended for *approval* to the Metropolitan Council:

A request for the acceptance of approximately 300 linear feet of eight-inch sewer main (DIP), three sanitary sewer manholes, and easement to serve the development at 1306 Rural Hill Road.

The relevant Metro agencies (Metro Parks, Metro Public Works, Metro Water Services, Metro Emergency Communications, the Nashville Electric Service, Metro Finance – Public Property and the Metro Historical Commission) have reviewed the proposal and concur in the recommendation for approval. This request must be approved by the Metro Council to become effective. A sketch showing the location of the request is attached to this letter.

Conditions that apply to this approval: none

This recommendation for approval is given as set forth in the Metropolitan Planning Commission Rules and Procedures. If you have any questions about this matter, please contact Delilah Rhodes at delilah.rhodes@nashville.gov or 615-862-7208.

Sincerely,

A handwritten signature in blue ink, appearing to read 'Lisa Milligan', written over a circular stamp.

Lisa Milligan
Land Development Manager
Metro Planning Department
cc: *Metro Clerk*

**Re: 1306 RURAL HILL ROAD
Planning Commission Mandatory Referral # 2023M-084ES-001
Council District #32 Joy Styles, Council Member**

A request for the acceptance of approximately 300 linear feet of eight-inch sewer main (DIP), three sanitary sewer manholes, and easement to serve the development at 1306 Rural Hill Road.

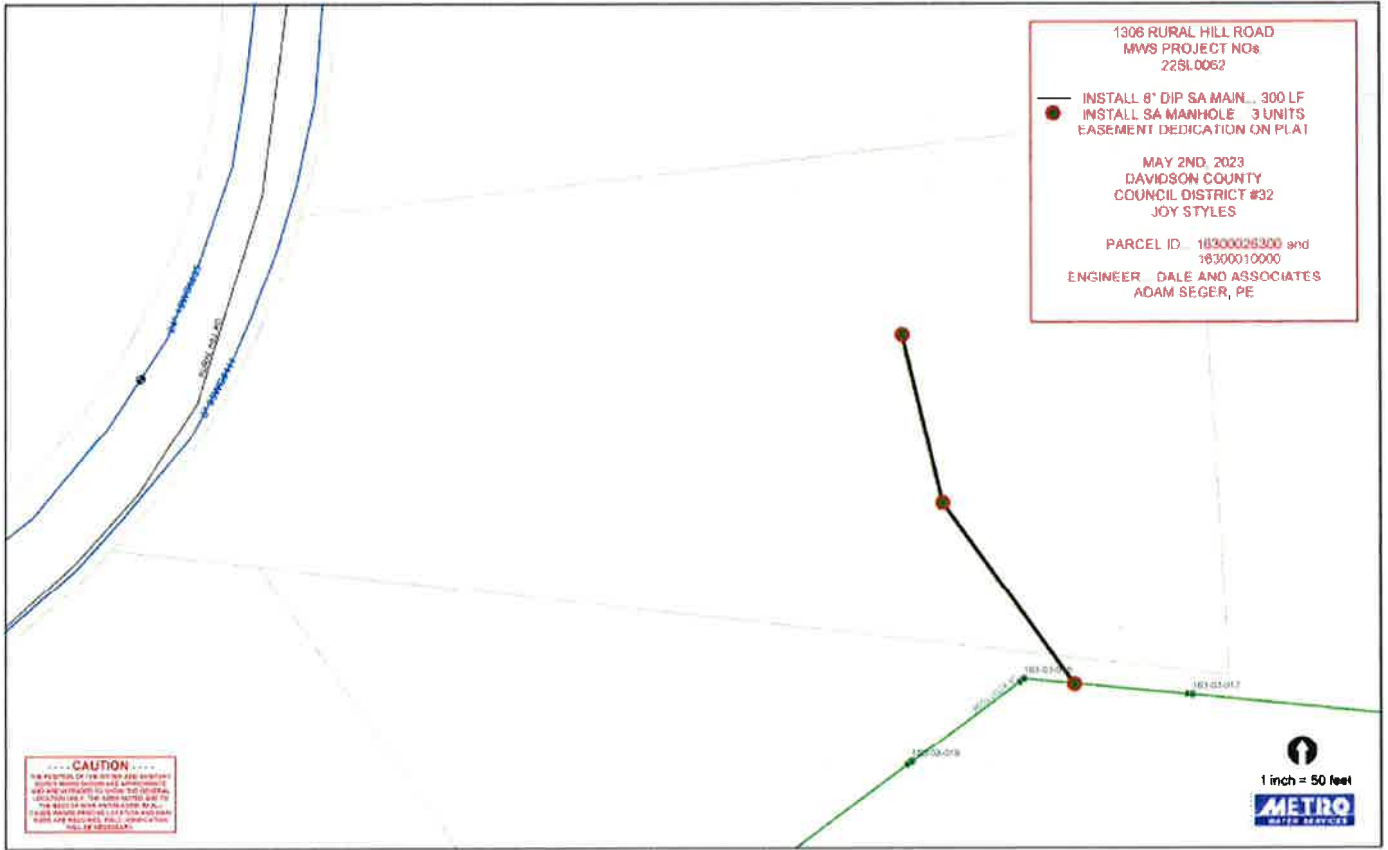

1306 RURAL HILL ROAD
 MWS PROJECT NOs:
 22SL0062

— INSTALL 8" DIP SA MAIN... 300 LF
 ● INSTALL SA MANHOLE... 3 UNITS
 EASEMENT DEDICATION ON PLAT

MAY 2ND, 2023
 DAVIDSON COUNTY
 COUNCIL DISTRICT #32
 JOY STYLES

PARCEL ID... 16300026300 and
 16300010000

ENGINEER... DALE AND ASSOCIATES
 ADAM SEGER, PE

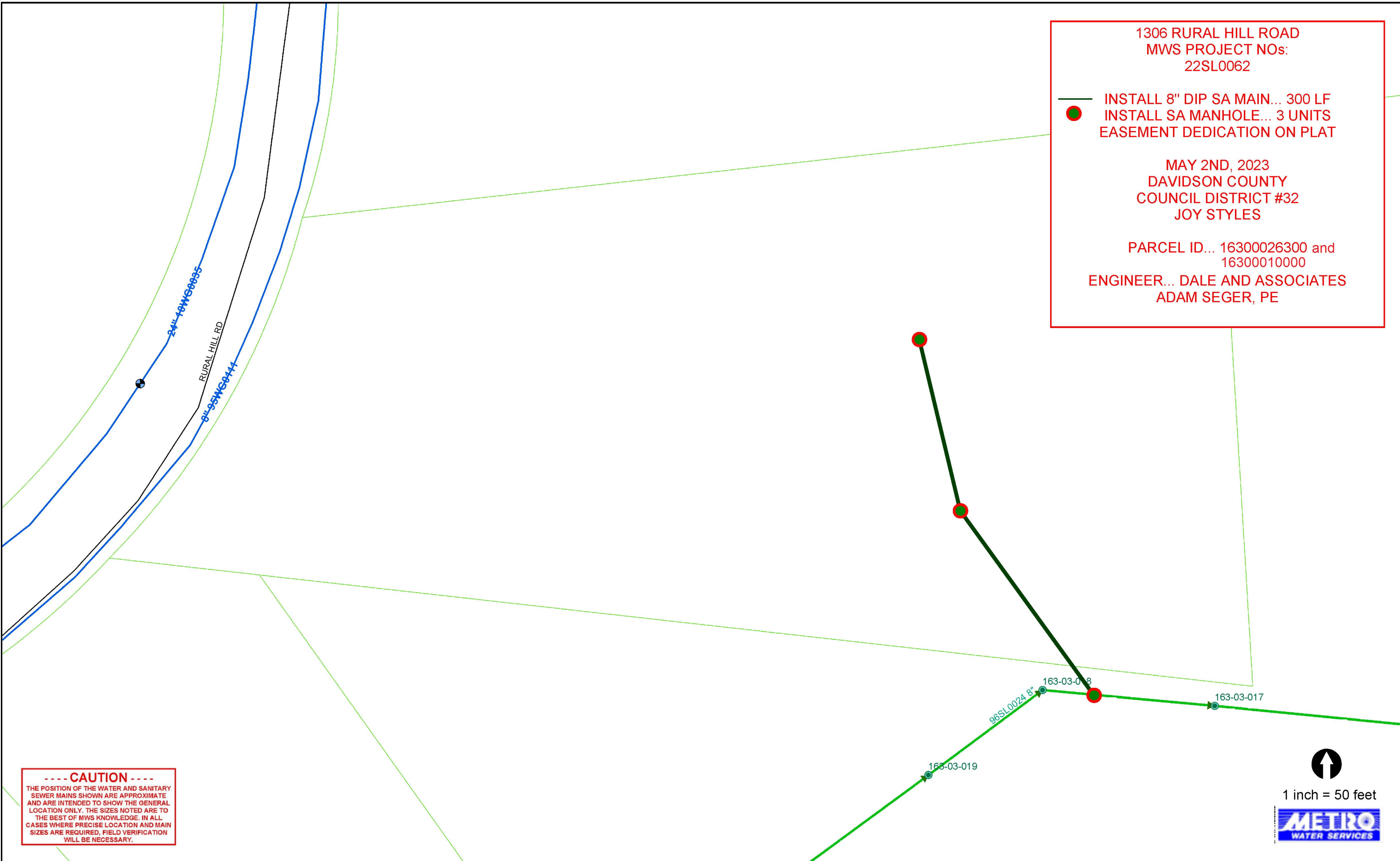

---- CAUTION ----
 THE POSITION OF THE WATER AND SANITARY
 SEWER MAINS SHOWN ARE APPROXIMATE
 AND ARE INTENDED TO SHOW THE GENERAL
 LOCATION ONLY. THE SIZES NOTED ARE TO
 THE BEST OF MWS KNOWLEDGE. IN ALL
 CASES WHERE PRECISE LOCATION AND MAIN
 SIZES ARE REQUIRED, FIELD VERIFICATION
 WILL BE NECESSARY.

↑
 1 inch = 50 feet
METRO
 WATER SERVICES