



**METROPOLITAN GOVERNMENT OF NASHVILLE  
AND DAVIDSON COUNTY**

Metro Office Building  
800 President Ronald Reagan Way  
P.O. Box 196300  
Nashville, TN 37219-6300

September 26, 2022

To: Mike Atchison, Metro Water Services

**Re: EDGE MOOR DRIVE STORM WATER SYSTEM IMPROVEMENT PROJECT  
Planning Commission Mandatory Referral #2022M-130ES-001  
Council District #29 Delishia Porterfield, Council Member**

On behalf of the Metropolitan Planning Commission, the following item, referred to the Commission as required by the Metro Charter, has been recommended for *approval* to the Metropolitan Council:

*A request for approval for permanent and temporary easements is needed to construct Project 21-SWC-69, Edge Moor Drive Storm Water System Improvement Project. These easements are to be acquired through negotiations and acceptance in order to complete this project.*

The relevant Metro agencies (Metro Parks, Metro Public Works, Metro Water Services, Metro Emergency Communications, the Nashville Electric Service, Metro Finance – Public Property and the Metro Historical Commission) have reviewed the proposal and concur in the recommendation for approval. This request must be approved by the Metro Council to become effective. A sketch showing the location of the request is attached to this letter.

**Conditions that apply to this approval: none**

This recommendation for approval is given as set forth in the Metropolitan Planning Commission Rules and Procedures. If you have any questions about this matter, please contact Delilah Rhodes at [delilah.rhodes@nashville.gov](mailto:delilah.rhodes@nashville.gov) or 615-862-7208.

Sincerely,

A handwritten signature in blue ink that reads "Lisa Milligan".

Lisa Milligan  
Land Development Manager  
Metro Planning Department  
cc: *Metro Clerk*

**Re: EDGE MOOR DRIVE STORM WATER SYSTEM IMPROVEMENT PROJECT**  
**Planning Commission Mandatory Referral #2022M-130ES-001**  
**Council District #29 Delishia Porterfield, Council Member**

*A request for approval for permanent and temporary easements is needed to construct Project 21-SWC-69, Edge Moor Drive Storm Water System Improvement Project. These easements are to be acquired through negotiations and acceptance in order to complete this project.*

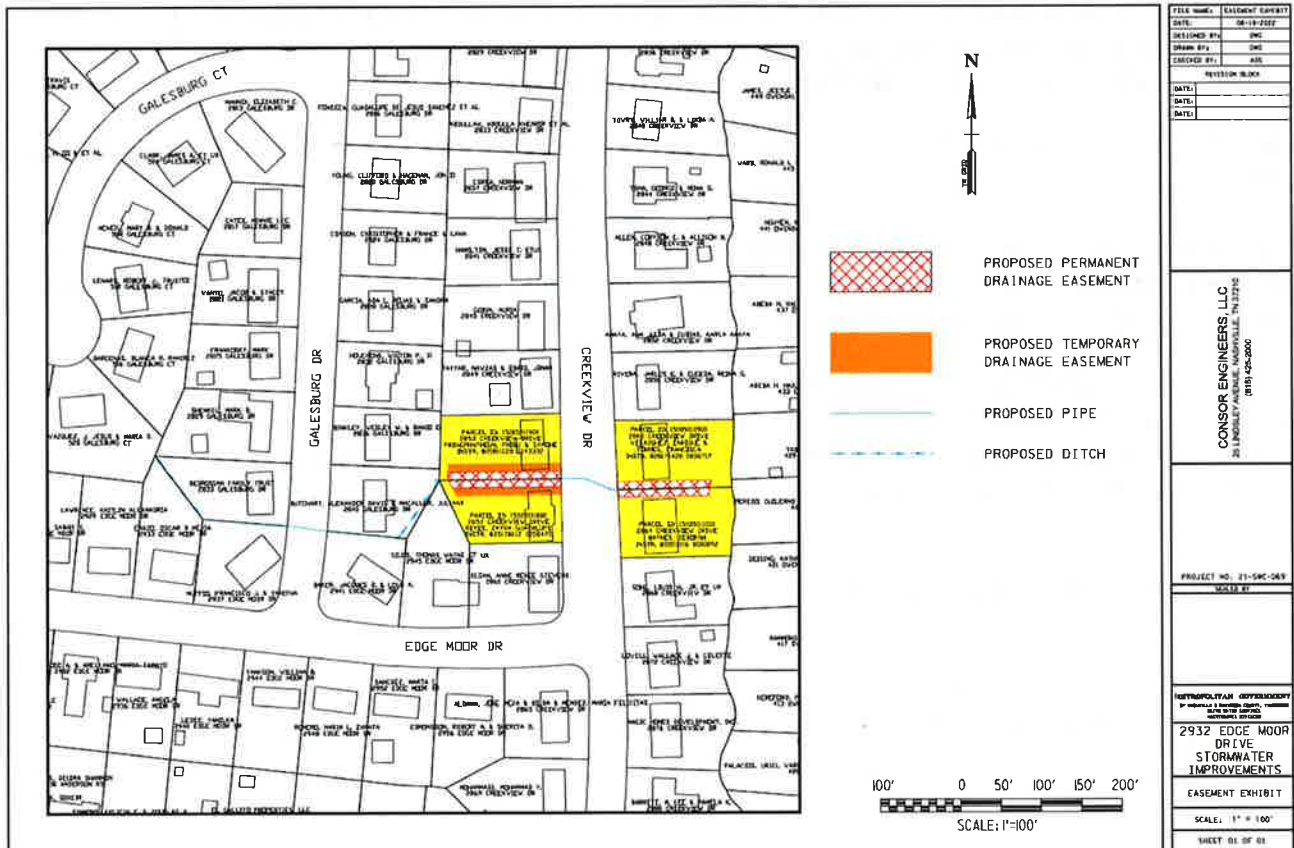

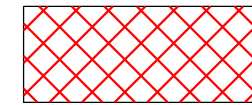
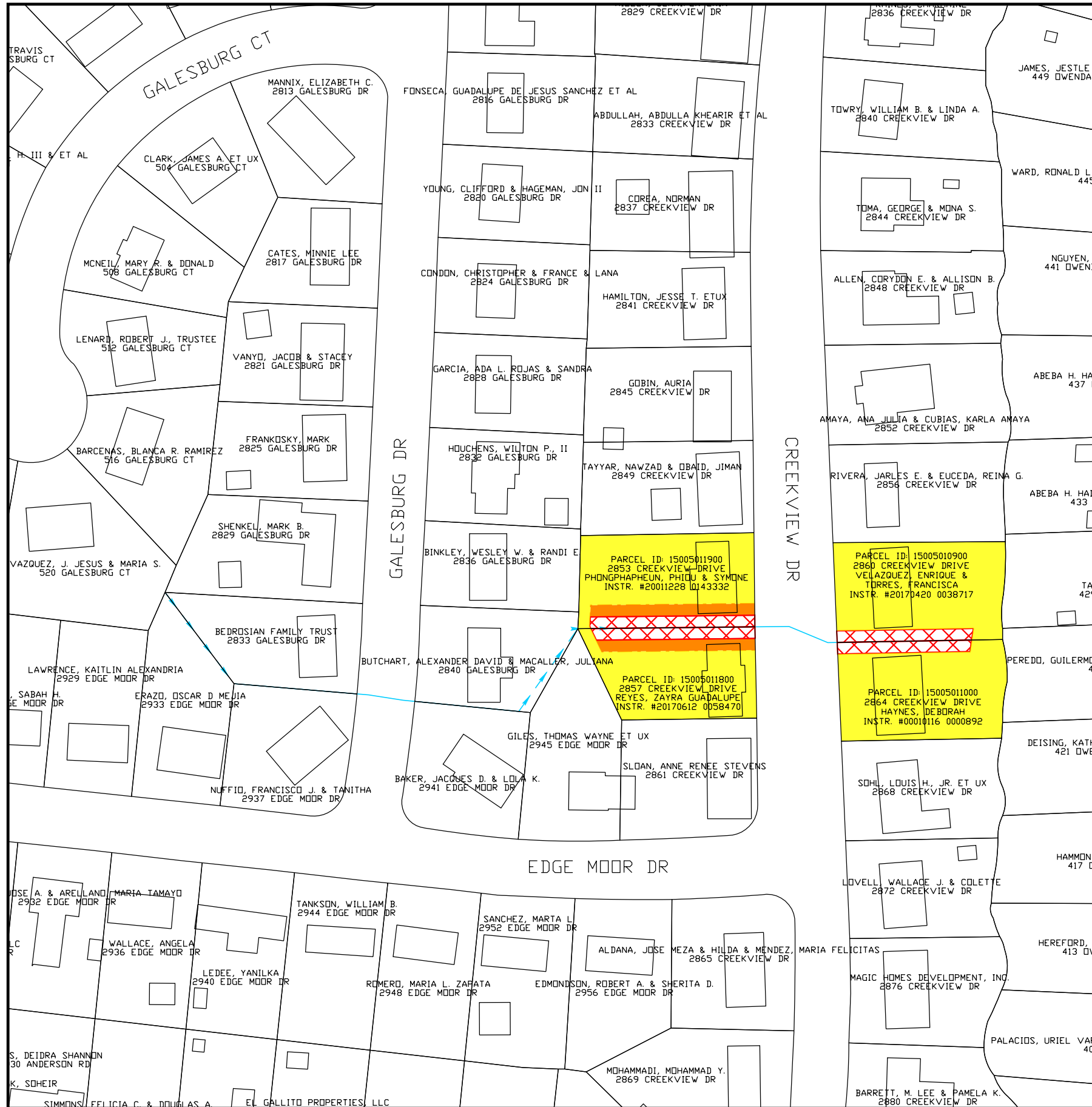

PROPOSED PERMANENT DRAINAGE EASEMENT



PROPOSED TEMPORARY DRAINAGE EASEMENT



PROPOSED PIPE



PROPOSED DITCH

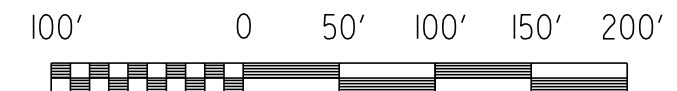

SCALE: 1" = 100'

FILE NAME:	EASEMENT EXHIBIT
DATE:	08-18-2022
DESIGNED BY:	DWG
DRAWN BY:	DWG
CHECKED BY:	AOS
REVISION BLOCK	
DATE:	
DATE:	
DATE:	

REVISION BLOCK	
DATE:	
DATE:	
DATE:	

**CONSOR ENGINEERS, LLC**  
 25 LINDSLEY AVENUE, NASHVILLE, TN 37210  
 (615) 425-2000

**PROJECT NO. 21-SWC-069**  
 SEALED BY

**METROPOLITAN GOVERNMENT**  
 OF NASHVILLE & DAVIDSON COUNTY, TENNESSEE  
 METRO WATER SERVICES  
 MAINTENANCE DIVISION

**2932 EDGE MOOR DRIVE**  
**STORMWATER IMPROVEMENTS**

EASEMENT EXHIBIT

SCALE: 1" = 100'

SHEET 01 OF 01