



**METROPOLITAN GOVERNMENT
OF NASHVILLE AND DAVIDSON COUNTY**

Planning Department
Metro Office Building
800 Second Avenue South
Nashville, Tennessee 37201

September 13, 2021

To: Mike Atchison, Metro Water Services

Re: 101 Factory Street Development
Planning Commission Mandatory Referral #2021M-076ES-001
Council District #17 – Colby Sledge, Council Member

On behalf of the Metropolitan Planning Commission, the following item, referred to the Commission as required by the Metro Charter, has been recommended for *approval* to the Metropolitan Council:

A request for the acceptance of approximately 86 linear feet of 8-inch sanitary sewer main (PVC) and one sanitary sewer manhole (see sketch for details) to serve the development at 101 Factory Street, LLC (MWS proj. no. 21-SL-68).

The relevant Metro agencies (Metro Parks, Metro Public Works, Metro Water Services, Metro Emergency Communications, the Nashville Electric Service, Metro Finance – Public Property and the Metro Historical Commission) have reviewed the proposal and concur in the recommendation for approval. This request must be approved by the Metro Council to become effective. A sketch showing the location of the request is attached to this letter.

Conditions that apply to this approval: None.

This recommendation for approval is given as set forth in the Metropolitan Planning Commission Rules and Procedures. If you have any questions about this matter, please contact Sharon O’Conner at Sharon.oconner@nashville.gov or 615-862-7208.

Sincerely,

A handwritten signature in black ink that reads 'Robert Leeman'.

Robert Leeman
Deputy Director
Metro Planning Department
cc: *Metro Clerk, Elizabeth Waites*

Re: 101 Factory Street Development
Planning Commission Mandatory Referral #2021M-076ES-001
Council District #17 – Colby Sledge, Council Member

A request for the acceptance of approximately 86 linear feet of 8-inch sanitary sewer main (PVC) and one sanitary sewer manhole (see sketch for details) to serve the development at 101 Factory Street, LLC (MWS proj. no. 21-SL-68).

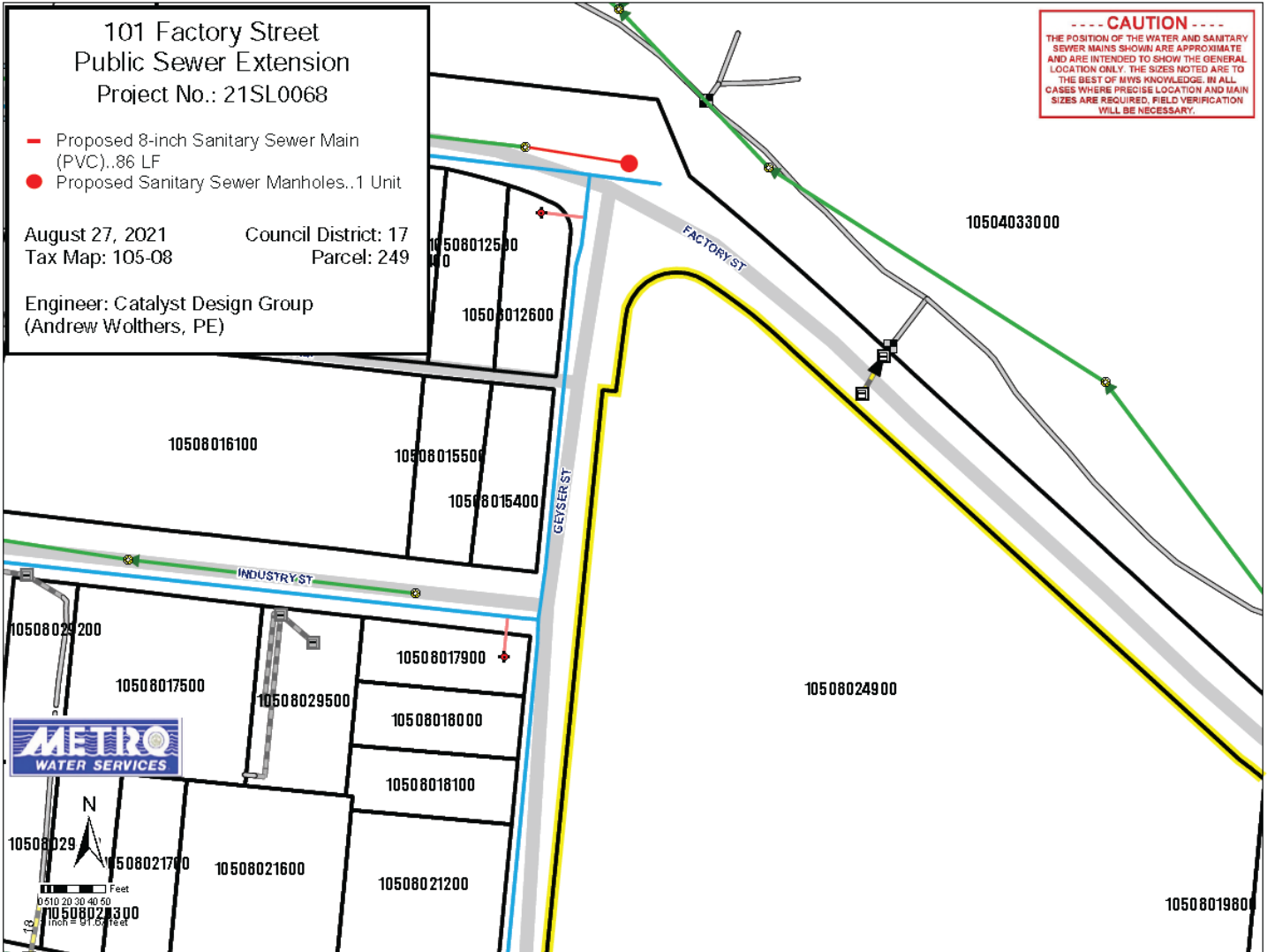

101 Factory Street Public Sewer Extension Project No.: 21SL0068

- Proposed 8-inch Sanitary Sewer Main (PVC)..86 LF
- Proposed Sanitary Sewer Manholes..1 Unit

August 27, 2021
Tax Map: 105-08

Council District: 17
Parcel: 249

Engineer: Catalyst Design Group
(Andrew Wolthers, PE)

---- CAUTION ----
 THE POSITION OF THE WATER AND SANITARY SEWER MAINS SHOWN ARE APPROXIMATE AND ARE INTENDED TO SHOW THE GENERAL LOCATION ONLY. THE SIZES NOTED ARE TO THE BEST OF MWS KNOWLEDGE. IN ALL CASES WHERE PRECISE LOCATION AND MAIN SIZES ARE REQUIRED, FIELD VERIFICATION WILL BE NECESSARY.

