

-----CAUTION-----
 THE POSITION OF THE WATER AND SANITARY SEWER MAINS SHOWN ARE APPROXIMATE AND ARE INTENDED TO SHOW THE GENERAL LOCATION ONLY. THE SIZES NOTED ARE TO THE BEST OF MWS KNOWLEDGE. IN ALL CASES WHERE PRECISE LOCATION AND MAIN SIZES ARE REQUIRED, FIELD VERIFICATION WILL BE NECESSARY.

615 Spruce Street
 Project No. 18SL0203 (Rev) 19WL0095
 Engineer: Kimley-Horn (John Richard Patterson, PE)
 March 2, 2020
 Council District 16
 Tax Map 92-07 Parcel 339 & 407 (and easements)

- Proposed 24" RCP Sanitary Sewer Main - 135 LF
- Proposed 8" PVC Sanitary Sewer Main - 196 LF
- Proposed Sanitary Sewer Manhole - 12 Units
- Abandoned Sanitary Sewer Main - 326 LF and 4 Sanitary Sewer Manholes
- Abandoned Water Main - 85 LF
- Proposed 8" DIP Sanitary Sewer Main - 114 LF
- Proposed 12" DIP Sanitary Sewer Main - 188 LF
- Proposed 12" PVC Sanitary Sewer Main - 230 LF

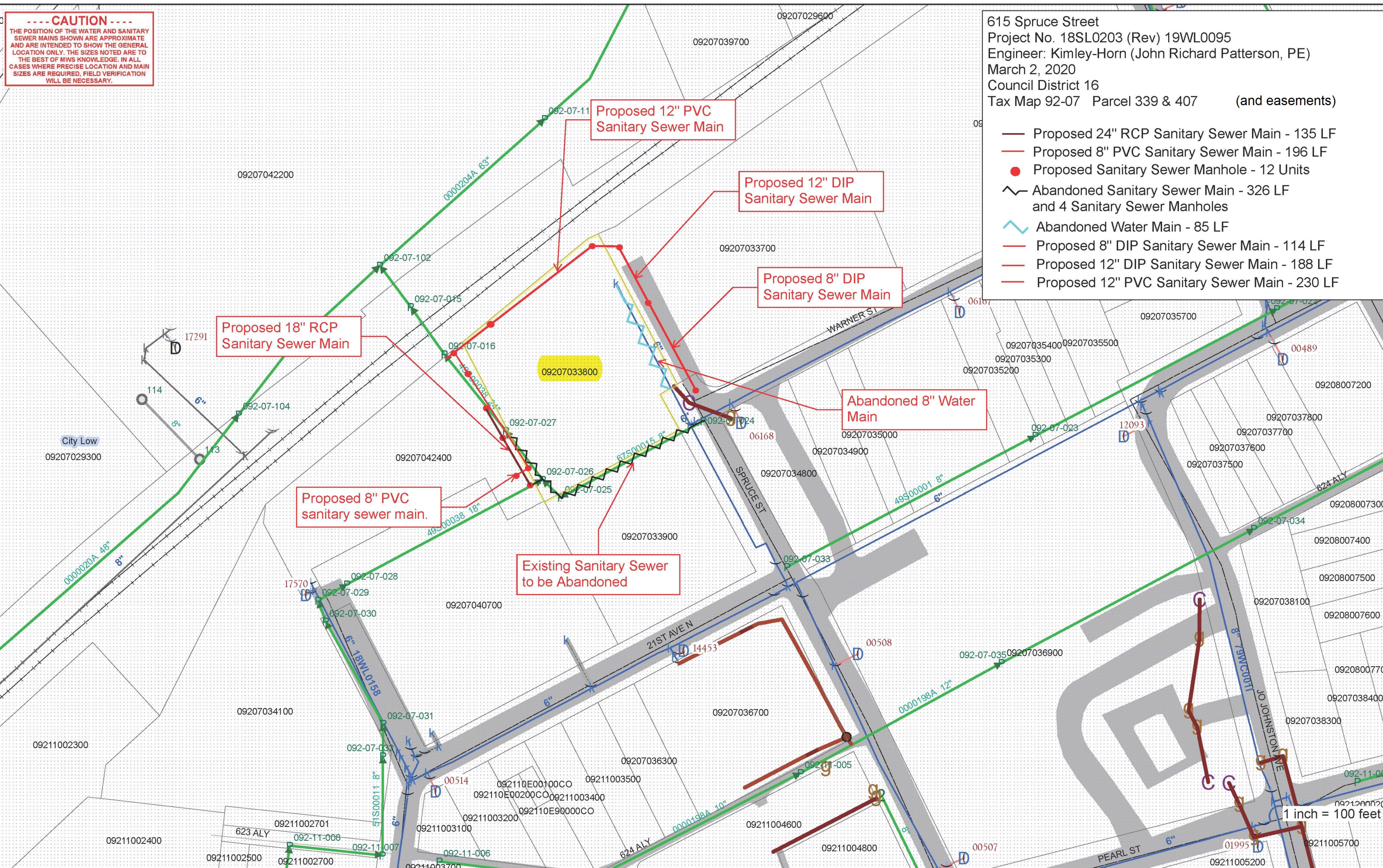

1 inch = 100 feet